

McDERMITT SURVEY  
N.E. 1/4 SEC. 8, T 55, R 4E  
NOBLE TWP., AUGLAIZE COUNTY, OH

VICINITY MAP  
NO SCALE

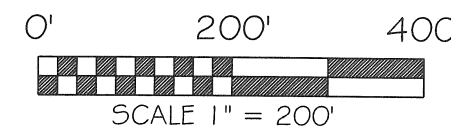
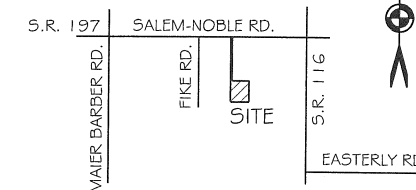

BASIS OF BEARING: BEARINGS ARE BASED UPON  
OHIO STATE PLANE NORTH ZONE 3401 NAD 83.

LEGEND

- 5/8x30" IRON PIN (SET) WPINK PLASTIC CAP STAMPED "LOCK TWO 7988"
- MAG NAIL (SET)
- 1/2" IRON PIN (FOUND)
- ⊙ IRON PIPE (FOUND)
- ⊗ RAILROAD SPIKE (FOUND)
- ⊙ GIN SPINDLE (FOUND)
- ⊗ STONE (FOUND)
- ⊗ A.C.E.O. MONUMENT BOX
- ⊙ ANGLE IRON POST (FOUND)

FILED IN SURVEY BOOK Q, PAGE 616 IN THE  
AUGLAIZE COUNTY TAX MAP OFFICE.

LOCK-TWO SURVEYING  
5166 LOCK TWO RD. NEW BREMEN, OH  
419-753-3332



#10044

FLIKE RD.  
WEST LINE N.E. 1/4 SEC. 8  
N.W. COR.  
N.E. 1/4  
SEC. 8  
STONE

5/8" 0.44' N. McDERMITT  
EAST PL 1.500 AC.  
O.R. 513/1650

SEE DETAIL "A"

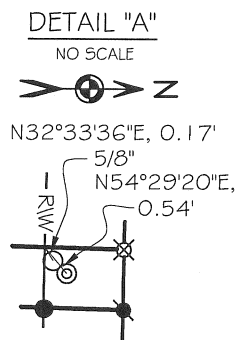

20'

SALEM - NOBLE RD. (40' R/W)  
N 89°13'32" W 1321.26'  
NORTH LINE N.E. 1/4 SEC. 8

N.E. COR.  
N.E. 1/4  
SEC. 8  
"O.D.O.T." CAP  
P.O.B.

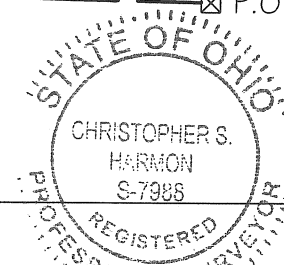

DATE  
9/22/10

*Christopher S. Harmon*  
CHRISTOPHER S. HARMON P.S. #7988

SURVEY NOTE:  
I HEREBY STATE THAT THIS IS A TRUE AND ACCURATE SURVEY AS PERFORMED BY MYSELF. ALL  
ADJOINING OWNERS, MONUMENTS AND THERE CONDITION ARE CURRENT AS OF THE TIME THE FIELD  
WORK WAS PERFORMED IN SEPTEMBER, 2010 AND DONE WITHOUT THE BENEFIT OF A TITLE SEARCH.

Survey Approved by KRH  
on 09/23/10

L. & M. CHANEY  
9.930 AC.  
O.R. 79/424

ANGLE IRON POST  
2.90' EAST OF PL

L. & S. CLAUSING  
25.005 AC.  
D.V. 250/722

T. & S. MENCHOFER  
66.265 AC.  
D.V. 213/566

S 01°19'31" W  
664.94'  
NOTE: 18"x18"  
FIELD STONE

0.20' EAST PL

ROBERT & LOIS McDERMITT  
(TRUSTEES)  
O.R. 403/18  
5.878 AC. TOTAL  
0.005 AC. R/W  
5.873 AC. NET

S 89°20'17" E 598.20'  
NEW DIVISION LINE

N 01°19'31" E 1997.47'  
S 01°19'31" W 1602.77'  
NEW DIVISION LINE

ROBERT & LOIS McDERMITT  
(TRUSTEES)  
O.R. 403/18  
58.247 AC. (AS PER TAX MAP)  
5.878 AC. TRACT  
52.369 AC. REMAINING

NEW DIVISION LINE  
S 01°19'31" W 394.68'

20' DRIVEWAY EASEMENT  
O.R. 145/780

16' DRIVEWAY EASEMENT  
SURVEY BOOK "H"/657

R. & M. ROBY  
1.753 AC.  
O.R. 297/545

"REX" CAP

"REX" CAP

"REX" CAP

S.E. COR.  
N.E. 1/4  
SEC. 8

"O.D.O.T." CAP

S.R. 116  
S 01°13'04" W 2659.75'  
EAST LINE N.E. 1/4 SEC. 8

Lock Two Surveying, LLP.  
5166 Lock Two Rd.  
New Bremen, Oh 45869  
419-753-3332

Cell: Jenny Saintignon 419-733-9606  
Chris Harmon P.S. 419-733-9607

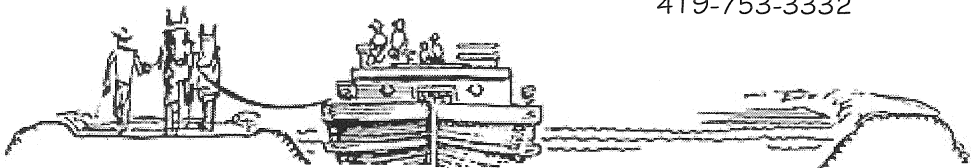

**McDERMITT SURVEY**  
**5.878 ACRES**

SITUATE IN THE NORTHEAST QUARTER OF SECTION 8, TOWN 5S RANGE 4E, NOBLE TOWNSHIP, AUGLAIZE COUNTY OHIO, AND BEING A PART OF THOSE LANDS OWNED BY ROBERT McDERMITT (TRUSTEE) & LOIS McDERMITT (TRUSTEE) AS RECORDED IN DEED VOLUME 403 PAGE 18 AND BEING MORE PARTICULARLY DESCRIBED AS FOLLOWS:

Beginning for reference at an iron pin with O.D.O.T. cap found in a monument box found at the northeast corner of the northeast quarter of Section 8 and being at the intersection of the centerlines State Route 116 and Salem – Noble Road;

Thence, with the north line of the northeast quarter of Section 8 and the centerline of Salem – Noble Road, North  $89^{\circ}13'32''$  West, 1321.26 feet to a Mag Nail set, said Mag Nail marking the **True Point of Beginning** of the tract herein described;

Thence, with a new division line the following 3 lines:

1. South  $01^{\circ}19'31''$  West, 1602.77 feet to an iron pin set, passing for reference at 20.00 feet an iron pin set in the south right of way line of Salem – Noble Road;
2. South  $89^{\circ}20'17''$  East, 598.20 feet to an iron pin set;
3. South  $01^{\circ}19'31''$  West, 394.68 feet to an iron pin set in the north line of a 30.064 acre tract of land owned by S. Seffernick as recorded in Official Record 258 Page 837;

Thence, with the north line of said 30.064 acre tract, North  $89^{\circ}20'17''$  West, 608.20 feet to the east line of a 66.265 acre tract of land owned by T. & S. Menchofer as recorded in Deed Volume 213 Page 566, passing for reference at 608.00 feet a  $1\frac{1}{2}$  inch iron pin found;

Thence, with the east lines of said 66.265 acre tract, a 9.930 acre tract owned by L. & M. Chaney as recorded in Official Record 79 Page 424, a 25.005 acres tract of land owned by L. & S. Clausing as recorded in Deed Volume 250 Page 722 and a 1.500 acre tract of land owned by N. McDermitt as recorded in Official Record 513, Page 1650, North  $01^{\circ}19'31''$  East, 1997.47 feet to a railroad spike found in the north line of a the northeast quarter of Section 8 and the centerline of Salem – Noble Road, passing for reference at 1977.47 to the south right of way line of Salem – Noble Road, witnessing at North  $32^{\circ}33'36''$  East 0.17 feet to a  $\frac{5}{8}$  inch iron pin found and witnessing at North  $54^{\circ}29'20''$  East, 0.54 feet to a iron pipe found;

Thence, with the north line of the northeast quarter of Section 8 and the centerline of Salem – Noble Road, South  $89^{\circ}13'32''$  East, 10.00 feet to the **True Point of Beginning**, containing 5.878 acres more or less of which 0.005 acres lie within the right of way of Salem – Nobel Road and being subject to all legal rights of way, easements, agreements and restrictions of record.

Bearings are based upon Ohio State Plane North Zone 3401 NAD 83. The survey records referenced are all recorded in the Shelby County Recorder's Office. Pins noted as set are  $\frac{5}{8}$ " x 30" rebar with pink plastic caps stamped "Lock-Two 7988".

The above description was prepared by Lock-Two Survey, LLP from a survey performed by Christopher S. Harmon, Professional Surveyor #7988 in September, 2010 and filed in Survey Book Q Page 617 of the Auglaize County Tax Map Office.

  
Christopher S. Harmon #7988



9/22/10  
Date

Q-617