

MARY & BERNARD McCARTY
to RON McCARTY SURVEY

9.228 Acres being a part of the Southwest Quarter of the
Southwest Quarter of Section 14, Union Township,
Town-5-South, Range-7-East, Auglaize County, Ohio

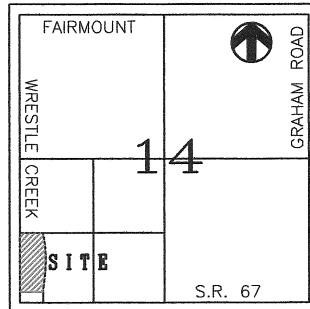

LOCATION MAP



Section 14, Union Township

PREVIOUS DEED

Mary & Bernard McCarty
Deed Vol OR 560
Page 1807

LEGEND

- Iron Pin (fd)
- Iron Pin (set)
- ⊙ Iron Pipe (found)
- ▲ Railroad Spike (fd)
- △ Mag Nail (fd)
- Monument Box (fd)
- ☼ Gin Spindle (fd)

9.228 Acres
(Approx. 0.30 Acres R/W)

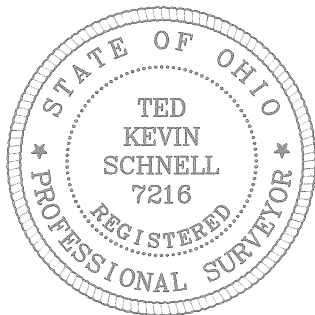
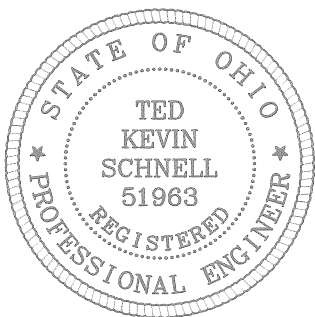

SCALE

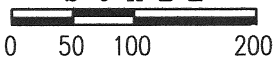

TRAVERSE TABLE

A	S. 07°-03'-17" E.	317.60'
B	S. 00°-15'-36" E.	250.50'
C	S. 02°-15'-23" W.	157.67'
D	S. 01°-23'-01" W.	208.52'
E	S. 03°-04'-02" W.	175.19'
F	S. 03°-02'-38" W.	216.64'
G	N. 89°-21'-16" W.	5.20'
H	N. 00°-31'-43" E.	180.59'

PREPARED BY

Ted K. Schnell

Ted K. Schnell

1-07-11

date

Andrew & Cynthia Nagel
Deed Vol OR 593
Page 726

NOTE

The centerline of Wrestle Creek Road lays to the West of the West Line of the Southwest Quarter of Section 14. The centerline intersection of Wrestle Creek Road with State Route 67 is approximately 19 feet to the West of the Monument Box located at the Southwest corner of the Southwest Quarter of said Section 14, Union Twp. The survey of 1.422 Acres as now occupied by Ron McCarty (See Survey Book E, Page 195, Tax Map Office) is based off the centerline of Wrestle Creek Road, and not the West Line of the Southwest Quarter.

989.83'
N. 89°-21'-16" W.
STATE ROUTE 67
(60' R/W)

WRESTLE CREEK ROAD
(C.R. 231 - 50' R/W)

RR Spike on
Wrestle Creek Rd

Southwest Corner,
Southwest Quarter,
Section 14, Union Twp

The bearings used for this Survey were based upon
the Auglaize County Engineer's Global Positioning
Survey.

See Prior Surveys: Survey Book E, Page 195, and
Survey UNION-14-2, Auglaize Co. Tax Map Office

This Survey Plat and Description is Recorded in Survey Book
Q, Page 676, Auglaize County Engineer's Tax
Map Office.

H & S Civil Engineers and Land Surveyors

913 Fieldstone Court

Wapakoneta, Ohio

45895

McCARTY TO McCARTY
client

14
section

UNION
township

AUGLAIZE
county

OHIO
state

01/07/11
date

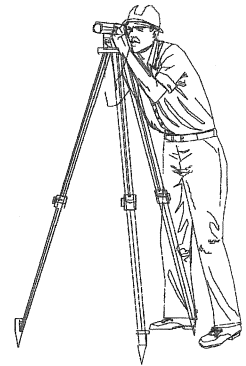

EXHIBIT A

H & S Civil Engineers and Land Surveyors

913 Fieldstone Court
Wapakoneta, Ohio 45895
Ted K. Schnell P.E., P.S.

January 07, 2011



Surveyor's Description of 9.228 Acre Parcel

The following described parcel of land is a part of the Southwest Quarter of the Southwest Quarter of Section 14, Union Township, Town-5-South, Range-7-East, Auglaize County, Ohio, and is more particularly described as follows:

Commencing for reference at a Monument Box (found) at the Northwest Corner of the Southwest Quarter of said Section 14, Union Township;

Thence with a bearing of S. 00°-22'-14" W. along the West line of the Southwest Quarter of said Section 14, Union Township, for a distance of 1,322.65 feet to an Iron Pin (found) and the PLACE OF BEGINNING;

Thence with a bearing of S. 89°-23'-03" E. along the North line of the Southwest Quarter of the Southwest Quarter of said Section 14, Union Township, for a distance of 317.62 feet to a Point in the center of an Open Ditch;

Thence with a bearing of S. 07°-03'-17" E. and following the centerline of an Open Ditch for a distance of 317.60 feet to a Point;

Thence with a bearing of S. 00°-15'-36" E. and following the centerline of an Open Ditch for a distance of 250.50 feet to a Point;

Thence with a bearing of S. 02°-15'-23" W. and following the centerline of an Open Ditch for a distance of 157.67 feet to a Point;

Thence with a bearing of S. 01°-23'-01" W. and following the centerline of an Open Ditch for a distance of 208.52 feet to a Point;

Thence with a bearing of S. 03°-04'-02" W. and following the centerline of an Open Ditch for a distance of 175.19 feet to a Point;

Thence with a bearing of S. 03°-02'-38" W. and following the centerline of an Open Ditch for a distance of 216.64 feet to a Mag Nail (found);

Thence with a bearing of N. 89°-21'-16" W. along the South line of the Southwest Quarter of said Section 14, Union Township, and the centerline of State Route 67, for a distance of 5.20 feet to a Mag Nail (set), said Mag Nail being the Southeast corner of an adjacent 1.422 Acre Parcel of land as referenced by Deed Volume 255, Page 642;

Q-676

Thence with a bearing of N. 00°-31'-43" E. along the East line of said adjacent 1.422 Acre Parcel of land for a distance of 180.59 feet to an Iron Pipe (found), said Iron Pipe (found) being the Northeast corner of said adjacent 1.422 Acre Parcel of land;

Thence with a bearing of N. 89°-19'-37" W. along the North line of said adjacent 1.422 Acre Parcel of land, for a distance of 329.50 feet to an Iron Pin (set), and passing through an Iron Pipe (found) at a distance of 317.96 feet;

Thence with a bearing of N. 00°-22'-14" E. along the West line of the Southwest Quarter of said Section 14, Union Township, for a distance of 1,141.90 feet to an Iron Pin (found) and the original PLACE OF BEGINNING.

Containing in all 9.228 Acres of land, of which approximately 0.30 Acre being previously dedicated for highway purposes. The above described tract of land is subject to any or all legal easements, reservations, or restrictions, if any, upon said premises.

The basis of bearings used for this survey were determined from the Global Positioning Survey of the Auglaize County Engineer, whereas the West line of the Southwest Quarter of Section 14, Union Township, bears N. 00°-22'-14" E.

Previous Deed Reference: Deed Volume OR 560, Page 1807, Auglaize County Recorder's Office.

Prepared By:



Ted K. Schnell
Professional Engineer
Professional Surveyor

