

BARBER FAMILY FARM LLC TO WILLIS & BARBARA BARBER

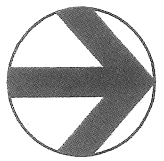

Southwest Corner,
Southeast Quarter,
Section 32,
Salem Twp.

0.064 Acres being a part West Half of the Southeast Quarter of
Section 32, Salem Township, Town-4-South, Range-4-East,
County of Auglaize, State of Ohio

139+00
60'

WILLIS & BARBARA BARBER
Volume: OR 304
PAGE 145

SCALE



LOCATION PLAN

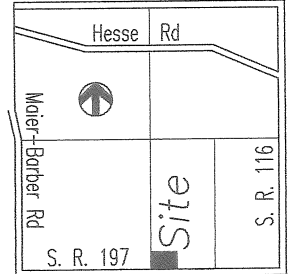

Section 32, Salem Twp.
Auglaize County, Ohio

ATTEST

Ted K. Schnell

Ted K. Schnell
Professional Engineer
Professional Surveyor

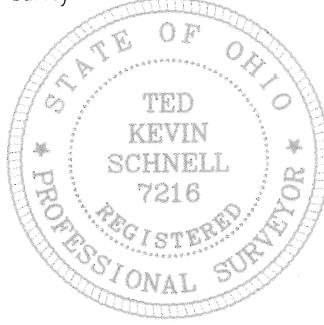

New 3.064 Acre Parcel

LEGEND

- Iron Pin (set)
- Iron Pin (found)
- △ Railroad Spike (found)
- Monument Box

Reference is made to a
Previous Survey by
Douglas Reinhart dated
October 11, 1978
See Survey Book D, Page 172

S. 88°-54'-24" E. - 540.54'
South line of the Southeast Quarter of Section 32, Salem Township

R / W

143+50
40'

DARICK & DONNA MAY
Volume: OR 398
PAGE 40
1.00 Acre Parcel

144+20
20'

144+20
40'

N. 00°-53'-36" E.
327.52'

WILLIS & BARBARA BARBER
Volume: OR 304
PAGE 145

0.936 Acre remains from original 4.00 Acre Parcel
(327.52')

PLACE
OF
BEGINNING

N. 00°-53'-36" E.
22.48'

N. 88°-54'-24" W.
124.46'

0.064
ACRES

22.48'
S. 00°-53'-36" W.

BARBER FAMILY FARM LLC
Volume: OR 606
Page: 180

Southeast Corner,
Southeast Quarter,
Section 32,
Salem Twp.

NOTES

The Basis of Bearings used for this Survey was determined
from the Auglaize County Engineer's Global Positioning Survey

This Survey Plat and Description is Recorded in Survey Book

R, Page 169, Auglaize County Engineer's Tax

Map Office.

H & S Civil Engineers and Land Surveyors

913 Fieldstone Court Wapakoneta, Ohio 45895

BARBER FAMILY FARM LLC
client

32
section

SALEM
township

AUGLAIZE
county

OHIO
state

05/08/12
date



H & S Civil Engineers and Land Surveyors

913 Fieldstone Court

Wapakoneta, Ohio 45895

Phone (419) 738-4758

Fax (419) 739-7631

email: hscivil@bright.net

Ted K. Schnell P.E., P.S.

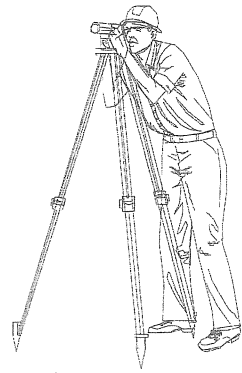

05/08/12

SURVEYOR'S DESCRIPTION 0.064 ACRE PARCEL

THIS DESCRIPTION REPRESENTS THE PROPOSED TRANSFER OF 0.064 ACRES
OF THE BARBER FAMILY FARM LLC TO WILLIS & BARBARA BARBER
WHEN COMBINED WITH THE 0.936 ACRE PARCEL
WILL NET 1.000 ACRE AROUND THE HOUSE AND BUILDING

The following described parcel of land is situated in the West Half of the Southeast Quarter of Section 32, Salem Township, Town-4-South, Range-4-East, Auglaize County, Ohio, and is more particularly described as follows:

Commencing for reference at a Monument Box located at the Southwest Corner of the Southeast Quarter of said Section 32, Salem Township;

Thence with a bearing of S. 88°-54'-24" E. along the South line of the Southeast Quarter of said Section 32, Salem Township, and the centerline of State Route 197, for a distance of 540.54 feet to a Railroad Spike (found);

Thence with a bearing of N. 00°-53'-36" E. for a distance of 327.52 feet to a Point and the PLACE OF BEGINNING;

Thence continuing with a bearing of N. 00°-53'-36" E. for a distance of 22.48 feet to an Iron Pin (set);

Thence with a bearing of S. 88°-54'-24" E. for a distance of 124.46 feet to an Iron Pin (set);

Thence with a bearing of S. 00°-53'-36" W. for a distance of 22.48 feet to an Iron Pin (found);

Thence with a bearing of N. 88°-54'-24" W. for a distance of 124.46 feet to a Point and the original PLACE OF BEGINNING.

Containing in all 0.064 Acres of land. The above described tract of land is also subject to all other legal easements, reservations, or restrictions, if any, upon said premises. Previous Deed References: DEED VOLUME OR 606, PAGE 180, Auglaize County Recorder's Office.

This survey is to be referenced by a prior boundary survey performed by Douglas Reinhart on October 11, 1978, as is Recorded in Survey Book D, Page 172, Auglaize County Tax Map Office, however, the basis of bearings used for this survey is consistent with the Auglaize County Engineer's Global Positioning Survey.

PREPARED BY:



Ted K. Schnell
Professional Engineer
Professional Surveyor

