

DARL & JONI HARKLEROAD
BOUNDARY SURVEY
BEING A PART OF THE SE 1/4 OF SECTION 10, T6S, R4E OF
ST. MARYS TOWNSHIP, COUNTY OF AUGLAIZE, AND STATE OF OHIO



(IN FEET)
1 inch = 100 ft.



**Van Horn
Hoover**
& Associates, Inc.

SURVEYING
CIVIL ENGINEERING
LAND USE PLANNING
GPS/GIS CONSULTANTS

P.O. BOX 612
FINDLAY, OH 45839
(419) 423-5630

www.VanHornHoover.com
E-Mail:
Info@VanHornHoover.com



PREPARED FOR:
**DARL & JONI
HARKLEROAD**
STATE ROUTE 66
ST. MARYS, OH

BOUNDARY SURVEY

REVISIONS		
MARK	DATE	DESCRIPTION

PLOTSCALE: 1:1

DRAWN: SEM CHECKED: EVH

DRAWING SCALE: 1"=100'

DATE: 3/19/13

JOB NUMBER: z:\projects\12648
12648.dwg

SHEET NUMBER: 1 OF 1

RONALD & TAMMY SCHALLENBERG
V. OR 214, PG. 162
K31-010-015-00

MIAMI ERIE FEEDER CANAL

PROPOSED BOUNDARY
1.499 ACRES

DARL & JONI HARKLEROAD
V. OR 244, PG. 399
K31-010-011-00

NORTH LINE ESTABLISHED FROM "PLAT
OF ST. MARY'S FEEDER OF THE MIAMI &
ERIE CANAL DATED APRIL 1930.

LARRY J. FREEWALT
V. OR 47, PG. 896
K31-011-007-00

EAST LINE OF SECTION 10

EDWARD A.
VAN HORN
S-6563

BOUNDARY SURVEY
EDWARD A. VAN HORN, P.S.
REG. NO. 6563
DATE 3/19/13

R-348

LEGEND
△ ○ MONUMENTATION FOUND, AS MARKED
✕ SECTION CORNERS, AS MARKED
▲ MAG NAIL SET
● 5/8" x 30" REBAR SET, MARKED W/
"VHHA" ORANGE PLASTIC CAP
P.O.B. POINT OF BEGINNING
P.O.C. POINT OF COMMENCEMENT
R/W RIGHT-OF-WAY

Brian Mitchell
614-265-6388

ENGINEERING ♦ SURVEYING ♦ GPS/GIS CONSULTING
Findlay, OH • P.O. Box 612 • 419.423.5630
Charlotte, NC • P.O. Box 621524 • 704.604.4124

Being part of the Southeast 1/4 of Section 10, Town 6 South, Range 4 East of St. Marys Township, County of Auglaize, and State of Ohio:

Commencing at the SE corner Section 10, thence along the south line of said section, N 87°37'16" W, a distance of 405.50 feet to a point on the East right of way line of State Route 66; thence along the East right of way of State Route 66, N 21°22'16" W, a distance of 332.50 feet to a point; thence continuing along the said right of way, N 23°22'16" W, a distance of 1046.49 feet to a 5/8" Capped Rebar set and the point of beginning herein described;

Thence continuing along the East right of way of State Route 66, N 23°22'16" W, a distance of 71.01 feet to a point on the South right of way line of the Feeder Canal and the NW corner of a tract of land conveyed to Darl and Joni Harkleroad in OR 244, Page 399 of the Auglaize County Records;

Thence next 5 courses along the South right of way of the Feeder Canal as established by the plat of St. Mary's Feeder of the Miami & Erie Canal and the north line of said Harkleroad tract;

N 65°20'02" E, a distance of 374.19 feet to a point;
N 77°20'58" E, a distance of 200.16 feet to a point;
N 75°20'43" E, a distance of 200.00 feet to a point;
N 71°37'31" E, a distance of 200.36 feet to a point;
N 76°43'58" E, a distance of 91.33 feet to a 5/8" Capped Rebar found at the NE corner of said Harkleroad tract, also being the East line of Section 10;

Thence along the East line of Section 10 and the east line of said Harkleroad tract, S 01°07'44" W, a distance of 57.40 feet to a 5/8" Capped Rebar set;

Thence S 74°38'26" W, a distance of 318.73 feet to a 5/8" Capped Rebar set;

Thence S 72°29'36" W, a distance of 340.63 feet to a 5/8" Capped Rebar set;

Thence S 65°48'24" W, a distance of 379.73 feet to the point of beginning, containing 1.499 acres more or less, subject to all prior easements of record.

Prepared By:

Edward A. Van Horn, P.S. #6563

Date

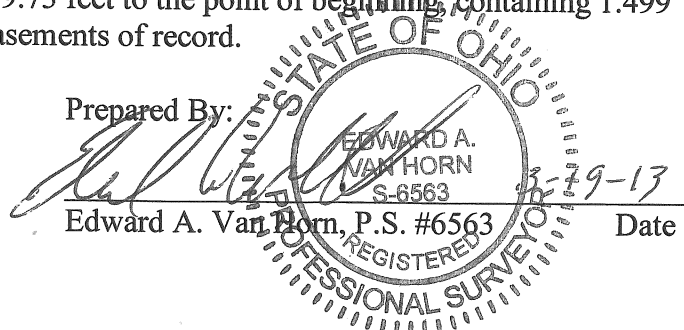

R-349