

# SURVEY FOR RICHARD & PAT LESLIE

Being a part of the West half of the Southeast Quarter of  
Section 28, Union Township, Town-5-South,  
Range-7-East, Auglaize County, Ohio

ATTEST

*Ted K. Schnell*

Ted K. Schnell  
Professional Engineer  
Professional Surveyor

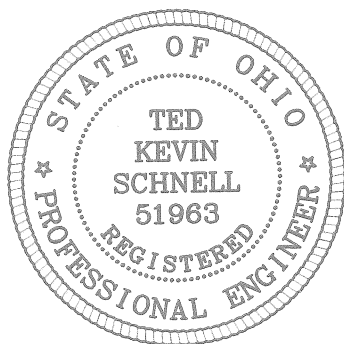

## LEGEND

- Iron Pin (set)
- ⊗ Point
- Iron Pin (found)
- △ Mag Nail (set)
- ▲ Railroad Spike (found)
- Monument Box

PT W½ SE  
5.001 ac.  
CAMPBELL ROBERT & CHERYL  
V. OR 248 PG. 170

## SCALE

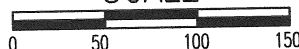

## LOCATION PLAN

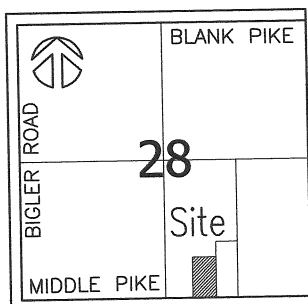

Section 28, Union Twp.  
Auglaize County, Ohio

Previous Deed  
Richard & Pat Leslie  
Volume: OR 14  
Page: 368

Previous Surveys  
10.00 Ac. Survey by Thomas E. Kuck  
5.001 Acre Survey by George Wooley  
Surveys evidenced by previous deeds  
Survey Plats not recorded w/Tax Map

Southwest Corner,  
Southeast Quarter,  
Section 28, Union Twp.  
(Monument Box)

Iron Pin  
for reference  
at 25'

deed call  
90°-31'

Iron Pin (fd)  
for reference  
at 25.32'

R/W

Q Kuenstle Road (T.R. #211)

S. 89°-48'-54" E.  
Q Middle Pike (C.R. #150 - 50' R/W)

South Line of the Southeast Quarter of  
Section 28, Union Township

The Basis of Bearings used for this Survey was  
determined from Auglaize County Global Positioning

This Survey Plat and Description is Recorded in Survey Book  
R, Page 381, Auglaize County Engineer's Tax  
Map Office.

N. 89°-48'-54" W.  
250.00'

New 1-Story  
Ranch Style Home



N. 00°-42'-06" E.  
480.00'

2.755  
Acres  
(0.143 Ac. R/W)

S. 00°-42'-06" W.  
480.00'

316'

call = 896.50'

S. 89°-48'-54" E.  
250.00'

NOTE: At the request of the client, the property corner shown on  
this Plat as a "Point" was not set due to farming practices.

PT W½ SE  
4.999 ac.  
CAMPBELL ROBERT D.  
V. OR 353 PG. 750

## H & S Civil Engineers and Land Surveyors

913 Fieldstone Court Wapakoneta, Ohio 45895

RICHARD & PAT LESLIE  
client

28  
section

UNION  
township

AUGLAIZE  
county

OHIO  
state

06/09/13  
date



# H & S Civil Engineers and Land Surveyors

913 Fieldstone Court  
Wapakoneta, Ohio 45895  
Phone (419) 738-4758  
Fax (419) 739-7631  
e-mail: hscivil@bright.net

Ted K. Schnell P.E., P.S.

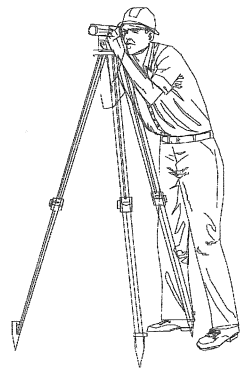

## Surveyor's Description of 2.755 Acre Parcel

The following described parcel of land is a part of the West half of the Southeast Quarter of Section 28, Union Township, Town-5-South, Range-7-East, Auglaize County, Ohio, and is more particularly described as follows:

Commencing for reference at a Monument Box (found) situated at the Southwest corner of the Southeast Quarter of said Section 28, Union Township, Town-5-South, Range-7-East;

Thence with a bearing of S. 89°-48'-54" E. along the South line of the Southeast Quarter of said Section 28, Union Township, for a distance of 646.50 feet to a Mag Nail (set) and the PLACE OF BEGINNING;

Thence continuing with a bearing of S. 89°-48'-54" E. along the South line of the Southeast Quarter of said Section 28, Union Township, for a distance of 250.00 feet to a Railroad Spike (found);

Thence with a bearing of N. 00°-42'-06" E. for a distance of 480.00 feet to an Iron Pin (set), and passing thru an Iron Pin (found) for reference at a distance of 25.32 feet;

Thence with a bearing of N. 89°-48'-54" W. and parallel with the South line of the Southeast Quarter of said Section 28, Union Township, for a distance of 250.00 feet to a Point;

Thence with a bearing of S. 00°-42'-06" W. for a distance of 480.00 feet to a Mag Nail (set), and passing thru an Iron Pin (set) for reference at a distance of 455.00 feet, said Mag Nail (set) being the original PLACE OF BEGINNING.

Containing in all 2.755 Acres of land, of which, approximately 0.143 Acre being previously dedicated for highway purposes. The above described tract of land is subject to any or all legal easements, reservations, or restrictions of record upon said premises. The basis of bearings used for this description were determined from Auglaize County Global Positioning.

Deed References: Deed Volume OR 14, Page 368, Auglaize County Recorder's Office.

Prepared By:

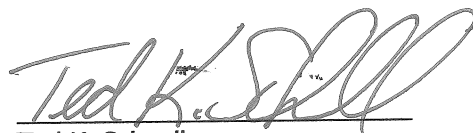
  
Ted K. Schnell  
Professional Engineer  
Professional Surveyor

