

DESCRIPTION - PARCEL No. 1

Being a parcel of land situate in the southeast quarter of the Northeast quarter of Section 19, T-4-S, R-4-E, Salem Township, Auglaize County, Ohio and more particularly described as follows:

**BEGINNING** at a monument box found at the southeast corner of said Northeast quarter; thence S 89°17'00" W (basis of bearing - adjacent survey) with the south line of said Northeast quarter (also the centerline Deep Cut Road), 512.03 feet to a mag nail and shiner set; thence N 00°19'08" E (passing through a capped 5/8 inch rebar set at 25.00 feet), 390.28 feet to a capped 5/8 inch rebar set; thence N 88°51'49" W, 166.55 feet to a capped 5/8 inch rebar set; thence S 46°23'42" W, 29.50 feet to a capped 5/8 inch rebar set; thence N 88°51'49" W, 263.30 feet to a capped 5/8 inch rebar set; thence S 01°29'32" W (passing through a capped 5/8 inch rebar set at 359.33 feet), 384.33 feet to a mag nail set on the south line of said Northeast quarter; thence S 89°17'00" W with said south line (also the centerline Deep Cut Road), 358.72 feet to a mag nail and shiner set at the southwest corner of said southeast quarter of the said Northeast quarter of said Section 19; thence N 00°13'37" W with the west line of said southeast quarter of said Northeast quarter (passing through a capped 5/8 inch rebar set at 25.00 feet), 1,329.14 feet to a 12 inch square concrete corner post found at the northwest corner of said southeast quarter of said Northeast quarter; thence N 89°02'28" E with the north line of said southeast quarter of said Northeast quarter (passing through a 12 inch square feet corner post found at 670.67 feet), 1,326.03 feet to a 12" inch square concrete post found at the northeast corner of said southeast quarter of said Northeast quarter; thence S 00°23'22" E with the east line of said southeast quarter of said Northeast quarter, 1,334.72 feet to the **PLACE OF BEGINNING** containing 36.580 acres more or less and subject to all highway and other legal easements of record. Road right of way occupies 0.500 acre. Deed reference: OR 604, Pg. 614. Surveyed by: **KUCK and MORRISEY, LLC**, Richard D. Morrissey, L.S. No. 6470 (Ohio).

DESCRIPTION - PARCEL No. 2

Being a parcel of land situate in the southeast quarter of the Northeast quarter of Section 19, T-4-S, R-4-E, Salem Township, Auglaize County, Ohio and more particularly described as follows:

Commencing at a monument box found at the southeast corner of said Northeast quarter; thence S 89°17'00" W (basis of bearing - adjacent survey) with the south line of said Northeast quarter (also the centerline Deep Cut Road), 512.03 feet to a mag nail and shiner set and the **PLACE OF BEGINNING** thence continuing S 89°17'00" W with said south line centerline, 459.00 feet to a mag nail and shiner set; thence N 01°29'32" E (passing through a capped 5/8 inch rebar set at 25.00 feet), 384.33 feet to a capped 5/8 inch rebar set; thence S 88°51'49" E, 263.30 feet to a capped 5/8 inch rebar set; thence N 46°23'42" E, 29.50 feet to a capped 5/8 inch rebar set; S 88°51'49" E, 166.55 feet to a capped 5/8 inch rebar set; thence S 00°19'08" W (passing through a capped 5/8 inch rebar set at 365.28 feet), 390.28 feet to **PLACE OF BEGINNING** containing 4.021 acres more or less and subject to all highway and other legal easements of record. Road right of way occupies 0.263 acre. Deed reference: OR 604, Pg. 614. Surveyed by: **KUCK and MORRISEY, LLC**, Richard D. Morrissey, L.S. No. 6470 (Ohio).

I hereby certify the accompanying map and survey, which it represents to be correct to best of my knowledge and belief. All rebar set and called for are topped with a plastic Peramark cap stamped:  
**KUCK & MORRISEY, L.S. 6470**

Date: **7/2018**

Richard D. Morrissey, L.S. 6470 (Ohio)  
**KUCK & MORRISEY, LLC.**

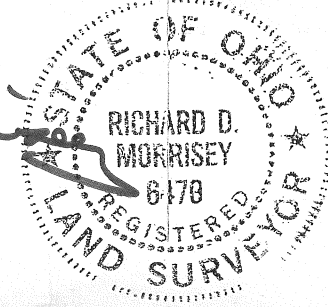

	Split of Parcel J2701900700 SE 1/4, NE 1/4, Section 19, T-4-S, R-4-E, Salem Township, Auglaize Co., Ohio	Surveyed By: <b>RDM</b> Date: <b>9/2/18</b>	<b>KUCK and MORRISEY, LLC.</b> CONSULTING ENGINEERS & SURVEYORS - LIMA, OHIO 2807 Chapel Hill Drive, Lima, Ohio (419) 228-1735 Phone & Fax
		<b>Jason DURKEE</b> 0987 Deep Cut Rd. Spencerville, OH 45887	