

SURVEY FOR TRAVIS DOSECK

2.00 Acres being a part of the Northwest Quarter
of Section 36, Noble Township, Town-5-South, Range-4-East,
County of Auglaize, State of Ohio



VOGEL ROAD (T.R. # 150)

Northwest Corner,
Northwest Quarter,
Section 36,
Noble Twp.

LEGEND

- Iron Pin (set)
- Iron Pin (found)
- Monument Box (found)
- Steel Post (found)
- ⊠ Wooden End Post (found)

SCALE

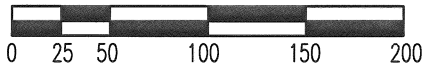

NOTE

The extent of road right-of-way records for Shipman Road varies as to where the road actually ends dedication. The current tax map for road right-of-way shows the road ending at the West line of Section 36, Noble Township, as used and shown on this Survey Plat.

H23-036-002-00
38.020 ac.
DOSECK PHILIP & RUTH
VOL 218, PG 682

N. 89°-47'-39" E.
320.00'

2.00
Acres

S. 00°-02'-14" W.
272.25'

S. 89°-47'-39" W.
320.00'

S. 89°-47'-39" W. 2,333.97'

SHIPMAN ROAD
T.R. # 146 (30')

N. 90°-00'-00" W.
1,235.13'

Northeast Corner of
Gary & Kimberly Thieman
2.107 Acre Parcel as
surveyed by Craig Mescher
(Survey R-4) July, 2011

Steel Post
at 12.80'

P.O.B.
Southwest Corner,
Northwest Quarter,
Section 36,
Noble Twp.

South Line of the Northwest Quarter of
Section 36, Noble Township

H23-036-005-00
6.000 ac.
DOSECK PHILIP & RUTH
VOL 218, PG 682

LOCATION PLAN

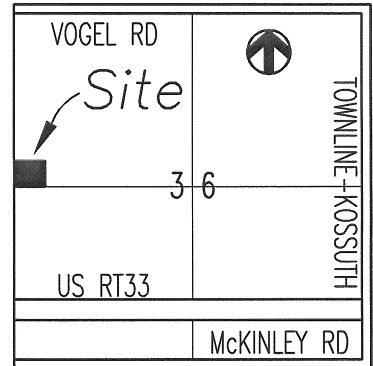

Section 36, Noble Twp.
Auglaize County, Ohio

ATTEST

Ted K. Schnell

Ted K. Schnell
Professional Engineer
Professional Surveyor

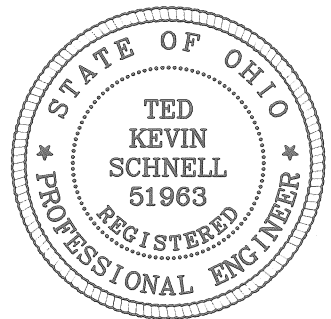

NOTE

The Basis of Bearings used for this Survey was determined
from previous surveys along Shipman Road

This Survey Plat and Description is Recorded in Survey Book
R, Page 487, Auglaize County Engineer's Tax Map Office.

H & S Civil Engineers and Land Surveyors

913 Fieldstone Court Wapakoneta, Ohio 45895

TRAVIS DOSECK
client

36
section

NOBLE
township

AUGLAIZE
county

OHIO
state

10-22-13
date



H & S Civil Engineers and Land Surveyors

913 Fieldstone Court
Wapakoneta, Ohio 45895
Phone (419) 738-4758
Fax (419) 739-7631
e-mail: hscivil@bright.net

Ted K. Schnell P.E., P.S.

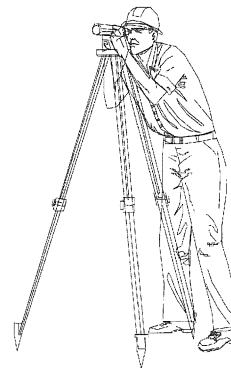

10-22-13

Surveyor's Description of 2.00 Acre Parcel

The following described parcel of land is a part of the Northwest Quarter of Section 36, Noble Township, Town-5-South, Range-4-East, Auglaize County, Ohio, and is more particularly described as follows:

Commencing at an Iron Pin (found) located at the Southwest corner of the Northwest Quarter of Section 36, Noble Township, and the PLACE OF BEGINNING;

Thence with a bearing of N. 00°-02'-14" E. along the West line of the Northwest Quarter of Section 36, Noble Township, for a distance of 272.25 feet to an Iron Pin (set), and passing a steel post at a distance of 12.80 feet for reference;

Thence with a bearing of N. 89°-47'-39" E. and parallel to the South line of the Northwest Quarter of Section 36, Noble Township, for a distance of 320.00 feet to an Iron Pin (set);

Thence with a bearing of S. 00°-02'-14" W. and parallel to the West line of the Northwest Quarter of Section 36, Noble Township, for a distance of 272.25 feet to an Iron Pin (set);

Thence with a bearing of S. 89°-47'-39" W. along the South line of the Northwest Quarter of Section 36, Noble Township, for a distance of 320.00 feet to an Iron Pin (found) and the original PLACE OF BEGINNING.

Containing in all 2.00 Acres of land. The above described tract of land is subject to any or all legal easements, reservations, or restrictions of record and is a parcel split created out of Auglaize County Parcel ID # H23-036-002-00. Previous Deed References: Deed Volume 218, Page 682, Auglaize County Recorder's Office.

The basis of bearings used for this legal description were determined from previous surveys of record along Shipman Road, where the South Line of the Southeast Quarter of Section 35, Noble Township, was assumed to bear N. 90°-00'-00" W.

This Survey and Legal Description is recorded in Survey Book R, Page 487, Auglaize County Tax Map Office.

Prepared By:

A handwritten signature in cursive script that reads "Ted K. Schnell". The signature is written in dark ink and is positioned above the printed name and title.

Ted K. Schnell
Professional Engineer
Professional Surveyor

