

ROLAND & ROSEMARY SCHMIESING
O.R. 184/398
PARCEL ID #E140300500

61.102 AC. (AS PER TAX MAP)
1.884 AC. TRACT
59.218 AC. REMAINING

ROLAND & ROSEMARY SCHMIESING
O.R. 184/398
PARCEL ID #E1403000500

1.884 AC. TOTAL
0.382 AC. R/W
1.502 AC. NET

N.E. COR.
S.E. 1/4
SEC. 30

N 01°38'41" E 2441.70'

S.R. 364 (60' R/W)
EAST LINE S.E. 1/4 SEC. 30

S 01°38'41" W 225.19'

S.E. COR.
S.E. 1/4
SEC. 30

P.O.B.

N 88°46'23" W 358.88'
MINSTER-FT. RECOVERY RD. (60' R/W)
SOUTH LINE S.E. 1/4 SEC. 30

S.W. COR.
S.E. 1/4
SEC. 30

N 88°46'23" W
2309.12'

N 02°51'27" E 235.51'
NEW DIVISION LINE

BARN

6.2'

S 87°07'01" E 353.97'

NEW DIVISION LINE

30.01'

R/W

R/W

30.00'

SCHMIESING SURVEY

S.E. 1/4 SEC. 30, T 7S, R 4E
JACKSON TWP., AUGLAIZE COUNTY, OH

VICINITY MAP

NO SCALE

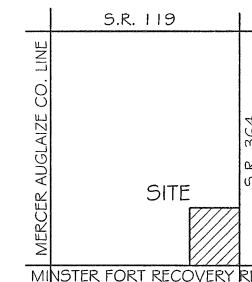

0' 50' 100'

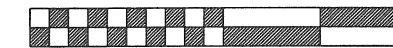

SCALE 1" = 50'

BASIS OF BEARING: BEARINGS ARE OHIO STATE PLANE
NORTH ZONE, 3401, NAD 83, GRID DISTANCES SHOWN
ARE GROUND.

LEGEND

- 5/8x30" IRON PIN (SET) WPINK PLASTIC
CAP STAMPED "LOCK TWO 7988"
- ⦿ MAG NAIL (SET)
- ⊠ A.C.E.O. MONUMENT BOX

F.E.M.A.

FLOOD INSURANCE NOTE: BY GRAPHICS PLOTTING ONLY, THIS
PROPERTY IS IN ZONE "X" OF THE FLOOD INSURANCE RATE MAP,
COMMUNITY PANEL NO. 39011C0175C EFFECTIVE DATE OF
09/06/1989 EXACT DESIGNATIONS CAN ONLY BE DETERMINED BY
AN ELEVATION CERTIFICATE. BASED ON THE ABOVE INFORMATION,
THIS PROPERTY "IS NOT" IN A SPECIAL FLOOD HAZARD AREA.



Christopher S. Harmon
CHRISTOPHER S. HARMON P.S. #7988

4/9/14
DATE

SURVEY NOTE:
I HEREBY STATE THAT THIS IS A TRUE AND ACCURATE SURVEY AS PERFORMED BY MYSELF. ALL
ADJOINING OWNERS, MONUMENTS AND THERE CONDITION ARE CURRENT AS OF THE TIME THE FIELD
WORK WAS PERFORMED IN APRIL, 2014 AND DONE WITHOUT THE BENEFIT OF A TITLE SEARCH.

FILED IN SURVEY BOOK "R", PAGE 563 IN THE
AUGLAIZE COUNTY TAX MAP OFFICE.

LOCK-TWO SURVEYING
5166 LOCK TWO RD. NEW BREMEN, OH
419-753-3332



Lock Two Surveying, LLP.
5166 Lock Two Rd.
New Bremen, Oh 45869
419-753-3332

Cell: Jenny Saintignon 419-733-9606
Chris Harmon P.S. 419-733-9607

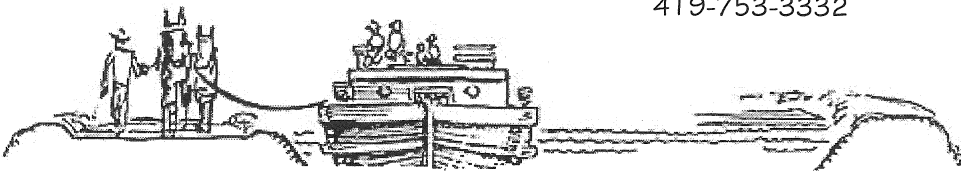

**SCHMIESING SURVEY
PARCEL #E1403000500
1.884 ACRES**

SITUATE IN THE SOUTHEAST QUARTER OF SECTION 30, TOWN 7S, RANGE 4E, JACKSON TOWNSHIP, AUGLAIZE COUNTY OHIO, AND BEING PART OF THOSE LANDS OWNED BY ROLAND & ROSEMARY SCHMIESING AS RECORDED IN OFFICAL RECORD 184 PAGE 398 AND BEING MORE PARTICULARLY DESCRIBED AS FOLLOWS:

Commencing at a monument box with 1" iron pin found at the southeast corner of the southeast quarter of Section 30 and the intersection of the center lines of State Route 364 and Minster – Fort Recovery Road, said monument box marking the **Point of Beginning** of the tract herein described;

Thence, with the south line of the southeast quarter of said Section 30 and the center line of Minster – Fort Recovery Road, North 88°46'23" West, 358.88 feet to a Mag Nail set;

Thence, with a new division line, North 02°51'27" East, 235.51 feet to an iron pin set, passing for reference at 30.00 feet an iron pin set in the north right of way of Minster – Fort Recovery Road;

Thence, with a new division line, South 87°07'01" East, 353.97 feet to a Mag Nail set in the center line of State Route 364 passing for reference at 323.96 feet an iron pin set in the west right of way line of State Route 364;

Thence, with the east line of the southeast quarter of said Section 30 and the center line of State Route 364, South 01°38'41" West, 225.19 to the **Point of Beginning** containing 1.884 acres more or less of which 0.382 acres lie within the rights of way of State Route 364 and Minster – Fort Recovery Road and being subject to all legal rights of way, easements, agreements and restrictions of record.

Bearings listed above are based upon Ohio State Plane North Zone, 3401, NAD 83, Grid Distances shown are Ground. Pins noted as set are 5/8" x 30" rebar with pink plastic caps stamped "Lock-Two 7988".

The above description was prepared by Lock-Two Survey, LLP from a survey performed by Christopher S. Harmon, Professional Surveyor #7988 in April of 2014 and filed as Survey Book "R", Page 563 in the Auglaize County Tax Map Office.

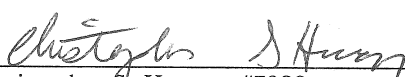
Christopher S. Harmon #7988

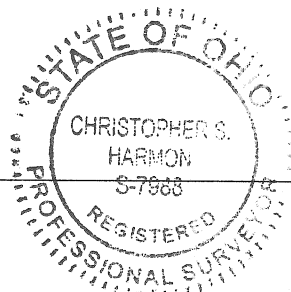

4/9/14
Date