

SURVEY FOR ROBERT E. LITTLE

for the purpose of a Hunting Rights Lease

65.681 Acres being a part of the Northeast Quarter of
Section 22, Union Township, Town-5-South, Range-7-East,
County of Auglaize, State of Ohio



NOTE #1

The pro-rated distance from Boundary Road calculates to 1,215.50' by using the Runkle Survey (1912), however, the actual field measured distance to a very deep Iron Bar (found) measures 1,217.76' used by this and previous surveys.

LOCATION PLAN

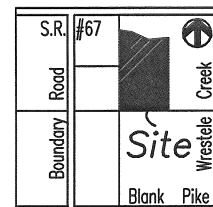

Section 22, Union Twp.
Auglaize County, Ohio

L34-022-008-00
40.000 ac.
MOTTER JEFFREY & ELISABETH

L34-022-007-00
40.000 ac.
COPELAND CHARLES I.

W R E S T L E C R E E K R O A D

S. 00°-41'-41" W. - 2,094.40'

East Line of the West half of the Northeast Quarter, Section 22, Union Twp.

LEGEND

- Iron Pin (set)
- ▲ P.K. Nail (found)
- Iron Bar (found)
- ⊙ Stone (found)
- Monument Box
- ⌵ Wooden End Post

SCALE

0 100 200 300 400

NOTES

The bearings used for this Survey were based upon the Auglaize County Engineer's Global Positioning Survey.

This Survey Plat and Description is Recorded in Survey Book
R , Page 634 , Auglaize County Engineer's Tax
Map Office.

H & S Civil Engineers and Land Surveyors

913 Fieldstone Court Wapakoneta, Ohio 45895

LITTLE HUNTING RIGHTS
client

22
section

UNION
township

AUGLAIZE
county

OHIO
state

06/11/14
date



B O U N D A R Y R O A D

Northwest Corner,
Northeast Quarter,
Section 22, Union Twp.
SEE NOTE #1

S. 89°-21'-06" E.
1,217.76'

S . R . 6 7
(1,321.77')

L34-022-009-01
21.760 ac.
LITTLE ROBERT E.

Deed Vol OR 534, Page 2283

Q of Open Ditch
Survey by Bacon & Assoc.

S. 84°-41'-19" E.
282.92'

S. 48°-06'-16" E.
160.46'

S. 57°-43'-52" E.
286.83'

N. 88°-37'-31" E.
675.04'

L34-022-009-00
67.980 ac.
LITTLE ROBERT E.

Deed Vol OR 534, Page 2283

ATTEST

Ted K. Schnell

Ted K. Schnell
Professional Engineer
Professional Surveyor

65.681
Acres

SURVEY REF'S

Survey Book G, Page 329 (Bacon)
Survey Book K, Page 295 (Schnell)
Survey Book M, Page 133 (Schnell)
Survey Book Q, Page 499 (Schnell)
Large Surveys UNI-22-3 (Schnell)
Runkle (1912) Book-3, Pg. 187

1,321.23'

N. 89°-15'-11" W.

South Line of the Northeast Quarter, Section 22, Union Twp.

Stone found at the
Southwest Corner,
Northeast Quarter,
Section 22, Union Twp.

1,321.23'
N. 89°-15'-11" W.

Southeast Corner,
Northeast Quarter,
Section 22, Union Twp.

L34-022-009-02
27.000 ac.
NAGEL ANDREW & CYNTHIA

8"x 8" Wooden Post
found at 1.80' and
N. 89°-13'-28" W.
from actual corner

L34-022-002-00
25.790 ac.
MARK D. WAITMAN LLC

L34-022-002-01
11.000 ac.
BAYLIFF KEVIN W.

H & S Civil Engineers and Land Surveyors

913 Fieldstone Court
Wapakoneta, Ohio 45895
Phone (419) 738-4758
Fax (419) 739-7631
e-mail: hscivil@bright.net

Ted K. Schnell P.E., P.S.

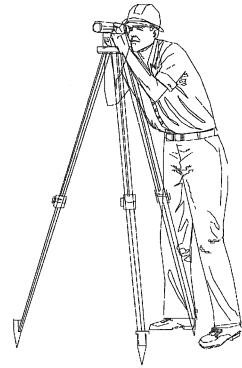

Surveyor's Description of 65.681 Acre Parcel (for the Purpose of Hunting Rights)

The following described parcel of land is a part of the Northeast Quarter of Section 22, Union Township, Town-5-South, Range-7-East, Auglaize County, Ohio, and is more particularly described as follows:

Commencing for reference at a P.K. Nail (found) situated at the intersection of State Route #67 and Boundary Road, Township Road #223;

Thence with a bearing of S. 89°-21'-06" E. along the North line of the Northwest Fractional Quarter of said Section 22, Union Township, for a distance of 1,217.76 feet to an Iron Bar (found) located at the Northwest corner of the Northeast Quarter of said Section 22, Union Township;

Thence with a bearing of S. 00°-40'-59" W. along the West line of the Northeast Quarter of said Section 22, Union Township, for a distance of 304.03 feet to a Point in the centerline of an open ditch and the PLACE OF BEGINNING;

Thence with a bearing of S. 84°-41'-19" E. and following the course of an open ditch for a distance of 282.92 feet to a Point;

Thence with a bearing of S. 48°-06'-16" E. and following the course of an open ditch for a distance of 160.46 feet to a Point;

Thence with a bearing of S. 57°-43'-52" E. and following the course of an open ditch, for a distance of 286.83 feet to a Point;

Thence with a bearing of N. 88°-37'-31" E. and following the course of an open ditch, for a distance of 675.04 feet to a Point on the East line of the West half of the Northeast Quarter of said Section 22, Union Township;

R-635

Thence with a bearing of S. 00°-41'-41" W. along the East line of the West half of the Northeast Quarter of said Section 22, Union Township, for a distance of 2,094.40 feet to a Point situated at the Southeast corner of the West half of the Northeast Quarter of said Section 22, Union Township;

Thence with a bearing of N. 89°-15'-11" W. along the South line of the West half of the Northeast Quarter of said Section 22, Union Township, for a distance of 1,321.23 feet to a Stone (found) situated at the Southwest corner of the Northeast Quarter of said Section 22, Union Township;

Thence with a bearing of N. 00°-40'-59" E. along the West line of the Northeast Quarter of said Section 22, Union Township, for a distance of 2,347.47 feet to a Point and the original PLACE OF BEGINNING.

Containing in all 65.681 Acres of land. The above described tract of land is subject to any or all legal easements, reservations, or restrictions of record upon said premises.

The basis of bearings used for this description were determined from the Auglaize County Engineer's Global Positioning Survey.

Deed References: Deed Volume OR 201, Pages 738-739, and OR 534, Pages 2283-2284, Auglaize County Recorder's Office. Permanent Parcel Reference # L34-022-009-00.

Prepared By:

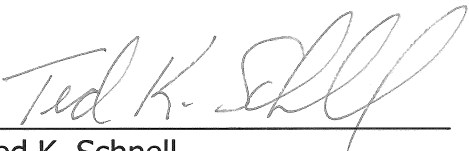
Ted K. Schnell
Professional Engineer
Professional Surveyor

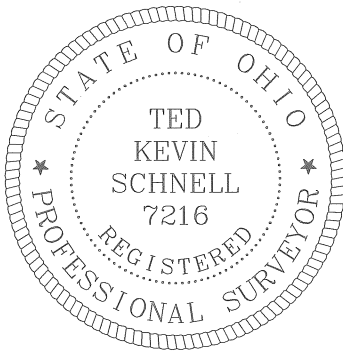
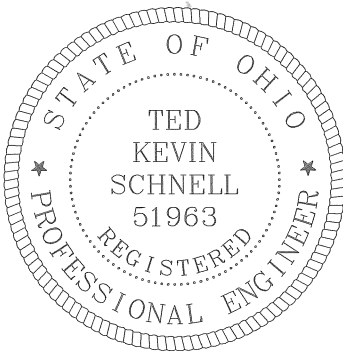

R-636