

VICINITY MAP  
NO SCALE

VILLAGE  
MINSTER

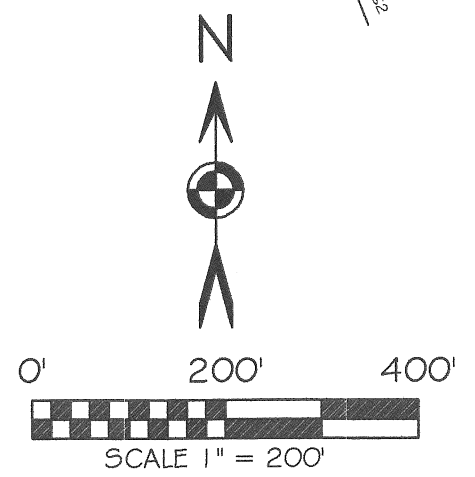
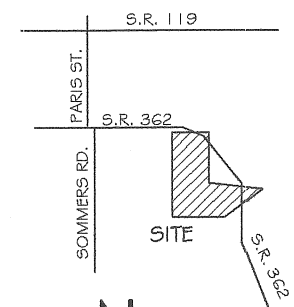

BASIS OF BEARING: BEARINGS ARE BASED ON THE NORTH LINE OF THE SOUTHEAST QUARTER OF SECTION 35 AND BEING SOUTH 89°01'09" EAST AS PER SURVEY BOOK "E" PAGE 440.

REFERENCE SURVEY "JAC 35-5 FOR FURTHER NOTES.

LEGEND

- 5/8x30" IRON PIN (SET) W/ ORANGE PLASTIC CAP STAMPED "LOCK TWO 7988"
- MAG NAIL (SET)
- MAG SPIKE (SET)
- MAG NAIL/ P.K. NAIL (FOUND)
- IRON PIN (FOUND) LTS CAP UNLESS NOTED
- ◎ IRON PIPE (FOUND)
- ⊕ CONCRETE R/W MONUMENT (DISTURBED)
- ⊗ A.C.E.O. MONUMENT BOX W/ 1" IRON PIN

FILED IN SURVEY BOOK "R", PAGE 703 IN THE  
AUGLAIZE COUNTY TAX MAP OFFICE.

LOCK-TWO SURVEYING  
5166 LOCK TWO RD. NEW BREMEN, OH  
419-753-3332



14049

F.E.M.A.

FLOOD INSURANCE NOTE: BY GRAPHICS PLOTTING ONLY, THIS PROPERTY IS IN ZONE "X" OF THE FLOOD INSURANCE RATE MAP, COMMUNITY PANEL NO. 39011 C0175 C EFFECTIVE DATE OF 09/06/1988 EXACT DESIGNATIONS CAN ONLY BE DETERMINED BY AN ELEVATION CERTIFICATE. BASED ON THE ABOVE INFORMATION, THIS PROPERTY "IS NOT" IN A SPECIAL FLOOD HAZARD AREA.

CHRISTOPHER S. HARMON P.S. #7988  
SURVEY NOTE:

I HEREBY STATE THAT THIS IS A TRUE AND ACCURATE SURVEY AS PERFORMED BY MYSELF. ALL ADJOINING OWNERS, MONUMENTS AND THEIR CONDITION ARE CURRENT AS OF THE TIME THE FIELD WORK WAS PERFORMED IN AUGUST, 2014 AND DONE WITHOUT THE BENEFIT OF A TITLE SEARCH.

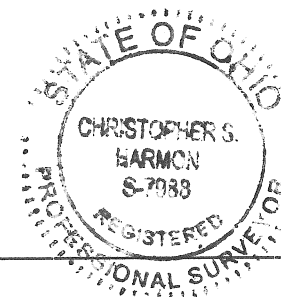

8/18/14  
DATE

B-703

Lock Two Surveying, LLP.

5166 Lock Two Rd.  
New Bremen, Oh 45869  
419-753-3332

Cell: Jenny Saintignon 419-733-9606  
Chris Harmon P.S. 419-733-9607

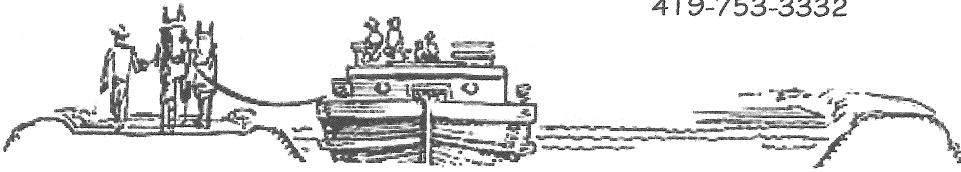

**WACKER SURVEY  
PARCEL #E140350140  
TRACT 1  
1.080 ACRES**

SITUATE IN THE SOUTHEAST QUARTER OF SECTION 35 TOWN 7S RANGE 4E, JACKSON TOWNSHIP, AUGLAIZE COUNTY OHIO, AND BEING PART OF THOSE LANDS OWNED BY STEVEN AND TERESA WACKER AS RECORDED IN OFFICIAL RECORD 134 PAGE 70 AND 79 AND BEING MORE PARTICULLARY DESCRIBED AS FOLLOWS:

Beginning for reference at an Auglaize county monument box with 1 inch iron pin found at the northwest corner of the southeast quarter of Section 35;

Thence, with the north line of the southeast quarter of Section 35, South 89°01'09" East, 1586.75 feet to an iron pin with "Lock Two" cap found, passing for reference at 1237.36 feet a Mag Nail found and at 1317.92 feet an iron pin with "Lock Two" cap found, said iron pin also making the **True Point of Beginning** of the tract herein described;

Thence, with the west line of those lands owned by the Ohio Department of Natural Resources (O.D.N.R.) the following 5 courses:

1. South 40°07'52" East, 65.39 feet;
2. South 26°25'46" East, 203.24 feet;
3. South 26°50'21" East, 104.86 feet;
4. South 08°13'54" East, 161.74, passing for reference at 155.06 feet an iron pin set in the east right of way line of State Route 362;
5. South 09°28'01" East, 69.39 feet to a Mag Nail found in the centerline of State Route 362;

Thence, with the centerline of State Route 362, North 32°35'01" West, 364.82 feet to a Mag Nail set;

Thence, with a curve to the left having a Delta Angle of 12°09'43", Radius of 573.08 feet, Arc Length of 121.65 feet with a Long Chord bearing North 38°40'15" West, 121.42 feet to a Mag Nail found;

Thence, with the east line of O.D.N.R., North 07°24'24" East, 97.41 feet to an iron pin with "Lock Two" cap found, passing for reference at 37.39 feet an iron pin with "Lock Two" cap found in the east right of way State Route 362;

Thence, with the east line of O.D.N.R., North 39°17'51" East, 71.44 feet to the **True Point of Beginning** containing 1.080 acres more or less of which 0.321 acres lie within the right of way of State Route 362 and being subject to all legal rights of way, easements, agreements and restrictions of record.

Bearings listed above are based on the north line of the southeast quarter of Section 35 and being South 89° 01'09" East, as per Survey Book "R" Page 440. The deed records referenced are all recorded in the Auglaize County Recorder's Office. Pins noted as set are 5/8" x 30" rebar with pink plastic caps stamped "Lock-Two 7988".

The above description was prepared by Lock-Two Survey, LLP from a survey performed by Christopher S. Harmon, Professional Surveyor #7988 in August of 2014 and filed in Survey Book "R", Page 703 in the Auglaize County Tax Map Office.

*Christopher S. Harmon*  
Christopher S. Harmon #7988

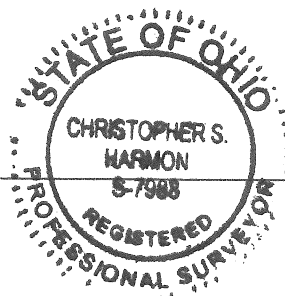

*8/18/14*  
Date

R-704

Lock Two Surveying, LLP.

5166 Lock Two Rd.  
New Bremen, Oh 45869

419-753-3332

Cell: Jenny Saintignon 419-733-9606  
Chris Harmon P.S. 419-733-9607

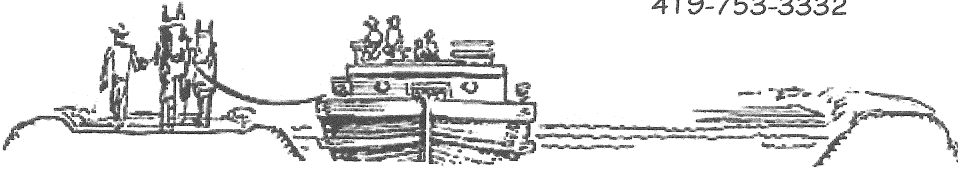

**WACKER SURVEY  
PARCEL #E140350140  
TRACT 2  
3.121 ACRES**

SITUATE IN THE SOUTHEAST QUARTER OF SECTION 35 TOWN 7S RANGE 4E, JACKSON TOWNSHIP, AUGLAIZE COUNTY OHIO, AND BEING PART OF THOSE LANDS OWNED BY STEVEN AND TERESA WACKER AS RECORDED IN OFFICIAL RECORD 134 PAGE 70 AND 79 AND BEING MORE PARTICULARLY DESCRIBED AS FOLLOWS:

Beginning for reference at an Auglaize county monument box with 1 inch iron pin found at the northwest corner of the southeast quarter of Section 35;

Thence, with the north line of the southeast quarter of Section 35 South 89°01'09" East, 1317.92 feet to an iron pin with "Lock Two" cap found, passing for reference at 1237.36 feet a Mag Nail found;

Thence, with the west line of the northeast quarter of the southeast quarter of Section 35, South 00°57'44" West, 1337.80 feet to a 5/8 inch iron pin found, passing for reference at 21.30 feet a Mag Nail found;

Thence, South 89°32'38" East, 688.30 feet to a P.K. Nail found, passing for reference at 638.74 feet an 5/8 inch iron pin found, said P.K. Nail marking the **True Point of Beginning**;

Thence, with the centerline of State Route 362, North 00°19'51" West, 337.73 feet to a Mag Nail set;

Thence, with a curve to the left, having a Delta Angle 11°52'33", Radius of 573.05 feet, Arc Length of 118.78 feet with a Long Chord of North 06°16'33" West, 118.57 feet to a Mag Spike set;

Thence, with the lines of the Ohio Department of Natural Resources (O.D.N.R.) the following 18 courses:

1. South 72°26'40" East, 21.29 feet;
2. South 72°22'21" East, 182.90 feet, passing for reference at 13.00 feet an iron pin set in the east right of way line of State Route 362;
3. South 88°43'05" East, 72.11 feet;
4. South 79°26'38" East, 64.58 feet;
5. South 69°12'37" East, 74.23 feet;
6. South 39°01'54" East, 55.05 feet;
7. South 23°25'20" East, 56.84 feet;
8. South 18°12'26" East, 41.32 feet;
9. South 13°08'24" West, 33.13 feet;
10. South 21°00'29" West, 57.03 feet;
11. South 35°58'25" West, 33.89 feet;
12. South 67°59'54" West, 27.27 feet;
13. North 82°10'57" West, 98.83 feet;
14. North 89°43'54" West, 62.01 feet;
15. Along a curve to the left having a Delta Angle of 24°26'36", Radius of 192.91 feet, Arc Length of 82.30 with a Long Chord of South 72°45'59" West, 81.68 feet;
16. South 55°31'16" West, 95.94 feet;
17. South 65°15'53" West, 38.29 feet to an iron pin set;
18. South 58°57'31" West, 30.82 feet to a Mag Nail set;

R-705

Thence, North 89°32'38" West, 3.51 feet to the **True Point of Beginning** containing 3.121 acres more or less of which 0.306 acres lie within the right of way of State Route 362 and being subject to all legal rights of way, easements, agreements and restrictions of record.

Bearings listed above are based on the north line of the southeast quarter of Section 35 and being South 89° 01'09" East, as per Survey Book "R" Page 440. The deed records referenced are all recorded in the Auglaize County Recorder's Office. Pins noted as set are 5/8" x 30" rebar with pink plastic caps stamped "Lock-Two 7988".

The above description was prepared by Lock-Two Survey, LLP from a survey performed by Christopher S. Harmon, Professional Surveyor #7988 in August of 2014 and filed in Survey Book "R", Page 703 in the Auglaize County Tax Map Office.

Christopher S. Harmon  
Christopher S. Harmon #7988

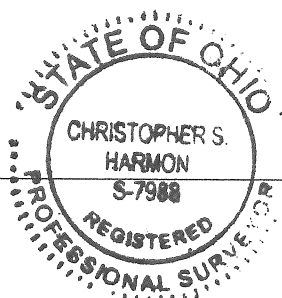

8/18/14  
Date