

MOYLER-SUTHERLAND SURVEY

Part of the Northwest Quarter of Section 15, T-5-S,
R-8-E, Wayne Township, Auglaize County, Ohio.

N.E. Corner,
N.W. Quarter,
Section 15,
Wayne Township

County Road 180 (Fairmount Road)

S.89°46'07"E.
1,322.97'

S.89°46'07"E.
1,172.97'

25' R/W Line

N.W. Corner,
N.W. Quarter,
Section 15,
Wayne Township

N.W. Corner,
N.E. Quarter,
N.W. Quarter,
Section 15

C. & S.D. Sutherland
N41-015-002-02
Deed: Vol. OR 635, Pg. 965
19.913 Acre
"R"-399

(30.00')
R. & L. Roop
Deed: Vol. OR 487, Pg. 2321
1.000 Acre

S.01°13'30"W.
290.14'
(150.32')
151.42'
S.89°57'45"E.
399.71'
S.00°56'47"W.

LOCATION PLAN

Section 15

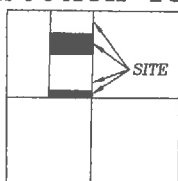

Wayne Township
T-5-S, R-8-E, Auglaize
County, Ohio.

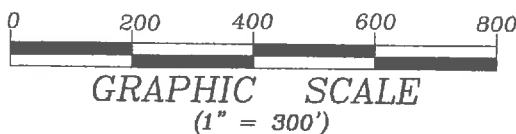

LEGEND

- Iron Pin Set
- Iron Pin Found
- ⊘ Mag Nail Set
- ⊙ Mag Nail Found
- ✱ P.K. Nail Found
- ▲ R.R. Spike Found
- County Monument Box

Township Road 283 (Smith Road)

N.00°51'18"E.
450.00'
N.00°51'18"E.
450.00'
N.00°51'18"E.
450.00'
N.00°51'18"E.
450.00'
N.00°51'18"E.
450.00'

S.89°44'32"E.
478.00'
2.041 ACRE
0.085 AC. R/W
PARCEL 3
478.00'
N.89°44'32"W.

G. & M. Moyler
N41-015-002-00
Deed: Vol. OR 640, Pg. 707
19.292 Acre
"R"-399

17.251 ACRE

N.89°44'32"W.
1,320.86'

C. & S.D. Sutherland &
N41-015-003-01
H. & T. Brookhart
Deed: Vol. OR 574, Pg. 2229
73.670 Acre

S.89°43'44"E.
1,319.80'

C. & S.D. Sutherland
N41-015-005-01
Deed: Vol. OR 635, Pg. 965
13.645 Acre
"R"-399

S.89°42'56"E.
411.00'

2.000 ACRE
0.097 AC. R/W
PARCEL 1
411.00'

S.89°42'56"E.
908.08'

G. Moyler & J. Little
N41-015-005-00
Deed: Vol. OR 640, Pg. 710
6.419 Acre
4.419 ACRE
PARCEL 2
907.74'

N.89°42'56"W.

N.89°42'56"W.

S.W. Corner,
S.E. Quarter,
N.W. Quarter,
Section 15

Triple T Farms LLC
Deed: Vol. OR 625, Pg. 1137
80.000 Acre

C. & S.D. Sutherland &
H. & T. Brookhart
Deed: Vol. OR 574, Pg. 2229
73.670 Acre

W. Hawkins, Jr.
Deed: Vol. OR 569, Pg. 709
20.000 Acre

This Plat is Recorded in Survey Book "S", Page
172, in the Auglaize County Engineer's Office.

State Route 67

ATTEST:

John W. Jauert
Professional Surveyor No. 6920

Jauert
surveying

11584 Monroe Road
Wapakoneta, Ohio
45895
(419) 657-6999

CLIENT: MOYLER, LITTLE & SUTHERLAND

COUNTY: Auglaize TOWNSHIP: Wayne SEC. 15

DRAWN BY: J.W.J. SCALE: 1"=300' DWG.# 15-4021A

CHECKED BY: DATE: July 2015 15-4021A

SHEET 1 OF 5 (T-5-S; R-8-E)

- John Jauert
- 11584 Monroe Road
- Wapakoneta, Ohio 45895



- Phone: (419) 657-6999
- FAX: (419) 657-2745
- E-Mail: jjsurvey@ohiolink.net

LITTLE DESCRIPTION PARCEL NO. 1 2.000 ACRE

The following described tract of land is part of the Northwest Quarter of Section 15, Town 5 South, Range 8 East, Wayne Township, Auglaize County, Ohio and being Parcels No. N41-015-005-00 and N41-015-006-00 and is more particularly described as follows:

The PLACE OF BEGINNING is at a Mag Nail found at the Southwest corner of the Southeast Quarter of the Northwest Quarter of Section 15, Wayne Township and in the centerline of Township Road 283 (Smith Road);

Thence N.00°51'18"E. along the centerline of Township Road 283, a distance of 212.00 feet to a Mag Nail found;

Thence S.89°42'56"E. a distance of 411.00 feet to an iron pin set, passing thru an iron pin found for reference at 20.00 feet in the East right-of-way line of Township Road 283;

Thence S.00°51'18"W., parallel to the centerline of Township Road 283, a distance of 212.00 feet to an iron pin set;

Thence N.89°42'56"W. a distance of 411.00 feet to the Mag Nail, passing thru an iron pin found for reference at 391.00 feet in the East right-of-way line of Township Road 283, said Mag nail was the true PLACE OF BEGINNING.

Containing in all 2.000 Acres of which 0.097 Acre is subject to easement for highway purposes. The above-described tract of land is subject to all legal easements, restrictions and reservations, if any, of record or in use on said premises. Previous deed reference: Volume OR 640, page 710 and OR 567, page 1490. This plat is recorded in Survey Book "S", page 172 in the Auglaize County Engineer's Office. Basis of bearing is the centerline of Township Road 283 (Smith Road) as N.00°51'18"E. (Auglaize County GPS Survey Data). This description is based on an actual field survey performed by me, John W. Jauert in July 2015.

ATTEST: _____

 John W. Jauert
 Professional Surveyor No. 6920



- John Jauert
- 11584 Monroe Road
- Wapakoneta, Ohio 45895



- Phone: (419) 657-6999
- FAX: (419) 657-2745
- E-Mail: jjsurvey@ohiolink.net

LITTLE-SUTHERLAND DESCRIPTION PARCEL NO. 2 4.419 ACRE

The following described tract of land is part of the Northwest Quarter of Section 15, Town 5 South, Range 8 East, Wayne Township, Auglaize County, Ohio and being part of Parcel No. N41-015-005-00 and is more particularly described as follows:

Commencing at a Mag Nail found at the Southwest corner of the Southeast Quarter of the Northwest Quarter of Section 15, Wayne Township and in the centerline of Township Road 283 (Smith Road);

Thence S.89°42'56"E. a distance of 411.00 feet to an iron pin set, passing thru an iron pin found for reference at 20.00 feet in the East right-of-way line of Township Road 283 said iron pin is the PLACE OF BEGINNING for the tract of land herein described;

Thence N.00°51'18"E., parallel to the centerline of Township Road 283, a distance of 212.00 feet to an iron pin set;

Thence S.89°42'56"E. a distance of 908.08 feet to an iron pin found;

Thence S.00°56'47"W. a distance of 212.00 feet to an iron pin found;

Thence N.89°42'56"W. a distance of 907.74 feet to the iron pin found, which was the true PLACE OF BEGINNING.

Containing in all 4.419 Acres. The above-described tract of land is subject to all legal easements, restrictions and reservations, if any, of record or in use on said premises. Previous deed reference: Volume OR 640, page 710. This plat is recorded in Survey Book "S", page 172 in the Auglaize County Engineer's Office. Basis of bearing is the centerline of Township Road 283 (Smith Road) as N.00°51'18"E. (Auglaize County GPS Survey Data). This description is based on an actual field survey, performed by me, John W. Jauert in July 2015.

ATTEST:

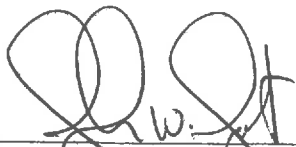

John W. Jauert
Professional Surveyor No. 6920

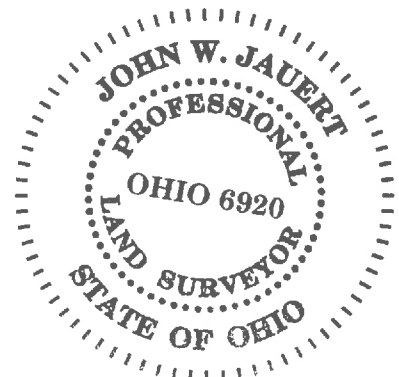

S-174

- John Jauert
- 11584 Monroe Road
- Wapakoneta, Ohio 45895



- Phone: (419) 657-6999
- FAX: (419) 657-2745
- E-Mail: jjsurvey@ohiolink.net

MOYLER DESCRIPTION PARCEL NO. 3 2.041 ACRE

The following described tract of land is part of the Northwest Quarter of Section 15, Town 5 South, Range 8 East, Wayne Township, Auglaize County, Ohio, being part of Parcel No. N41-015-002-00 and is more particularly described as follows:

Commencing at a Mag Nail found at the Northwest corner of the Northeast Quarter of the Northwest Quarter of Section 15, Wayne Township and in the intersection of the centerlines of Township Road 283 (Smith Road) and County Road 180 (Fairmount Road);

Thence S.00°51'18"W. along the Quarter, Quarter line of Section 15 and the centerline of Township Road 283, a distance of 688.69 feet to a Mag Nail found, which is the PLACE OF BEGINNING for the tract of land herein described;

Thence S.89°44'32"E. a distance of 478.00 feet to an iron pin set, passing thru an iron pin found at 20.00 feet in the East right-of-way line of Township Road 283;

Thence S.00°51'18"W., parallel to the centerline of Township Road 283, a distance of 186.00 feet to an iron pin set;

Thence N.89°44'32"W. a distance of 478.00 feet to a Mag Nail set, passing thru an iron pin set for reference at 458.00 feet in the East right-of-way line of Township Road 283;

Thence N.00°51'18"E. along the centerline of Township Road 283, a distance of 186.00 feet to the Mag nail which was the true PLACE OF BEGINNING.

Containing in all 2.041 Acres of which 0.085 Acre is subject to easement for highway purposes. The above-described tract of land is subject to all legal easements, restrictions and reservations, if any, of record or in use on said premises. Previous deed reference: Volume OR 640, page 707. This plat is recorded in Survey Book "S", page 172 in the Auglaize County Engineer's Office. Basis of bearing is the North line of the Northwest Quarter of Section 15, Wayne Township and the centerline of County Road 180 (Fairmount Road) as S.89°46'07"E. (Auglaize County GPS Survey Data). This description is based on an actual field survey, performed by me, John W. Jauert in July 2015.

ATTEST:

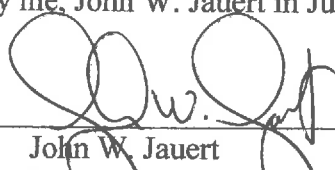

John W. Jauert
Professional Surveyor No. 6920



S-175

- John Jauert
- 11584 Monroe Road
- Wapakoneta, Ohio 45895

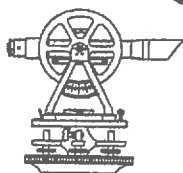
Jauert Surveying



- Phone: (419) 657-6999
- FAX: (419) 657-2745
- E-Mail: jjsurvey@ohiolink.net

**MOYLER-SUTHERLAND DESCRIPTION
PARCEL NO. 4
17.251 ACRE**

The following described tract of land is part of the Northwest Quarter of Section 15, Town 5 South, Range 8 East, Wayne Township, Auglaize County, Ohio, being part of Parcel No. N41-015-002-00 and is more particularly described as follows:

Commencing at a Mag Nail found at the Northwest corner of the Northeast Quarter of the Northwest Quarter of Section 15, Wayne Township and in the intersection of the centerlines of Township Road 283 (Smith Road) and County Road 180 (Fairmount Road);

Thence S.00°51'18"W. along the Quarter, Quarter line of Section 15 and the centerline of Township Road 283, a distance of 688.69 feet to a Mag Nail found;

Thence S.89°44'32"E. a distance of 478.00 feet to an iron pin set, passing thru an iron pin found at 20.00 feet in the East right-of-way line of Township Road 283, said iron pin is the PLACE OF BEGINNING for the tract of land herein described;

Thence continuing S.89°44'32"E. a distance of 843.87 feet to an iron pin found;

Thence S.00°56'47"W. a distance of 636.01 feet to an iron pin found;

Thence N.89°44'32"W. a distance of 1,320.86 feet to a Mag Nail found, passing thru an iron pin found for reference at 1,300.86 feet in the East right-of-way line of Township Road 283;

Thence N.00°51'18"E. along the centerline of Township Road 283, a distance of 450.00 feet to a Mag Nail set;

Thence S.89°44'32"E. a distance of 478.00 feet to an iron pin set, passing thru an iron pin set at 20.00 feet in the East right-of-way line of Township Road 283;

Thence N.00°51'18"E., parallel to the centerline of Township Road 283, a distance of 186.00 feet to the iron pin which was the true PLACE OF BEGINNING.

Containing in all 17.251 Acres of which 0.207 Acre is subject to easement for highway purposes. The above-described tract of land is subject to all legal easements, restrictions and reservations, if any, of record or in use on said premises. Previous deed reference: Volume OR 640, page 707. This plat is recorded in Survey Book "S", page 172 in the Auglaize County Engineer's Office. Basis of bearing is the North line of the Northwest Quarter of Section 15, Wayne Township and the centerline of County Road 180 (Fairmount Road) as S.89°46'07"E. (Auglaize County GPS Survey Data). This description is based on an actual field survey performed by me, John W. Jauert in July 2015.

ATTEST:

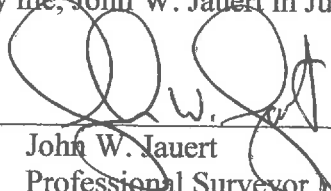
John W. Jauert
Professional Surveyor No. 6920

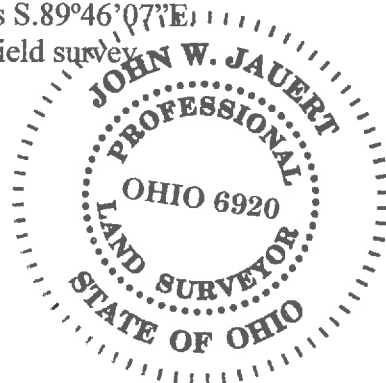

S-170