

BAUMER - HOMAN SURVEY

Part of the Southeast Quarter of Section 20, T-7-S,
R-4-E, Jackson Township, Auglaize County, Ohio.



LOCATION PLAN

Section 20

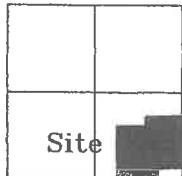

Jackson Township,
T-7-S, R-4-E, Auglaize
County, Ohio.

N.E. Corner,
S.E. Quarter,
Section 20

N. & R. Baumer
E14-020-005-00
Deed: Vol. OR 100, Pg. 987
100.000 Acre

Open Ditch

N. & R. Baumer
E14-020-004-01
Deed: Vol. OR 121, Pg. 652
96.316 Acre
"I"-342

Ref. Pin
Set

S.89°08'51"E.
1,121.70'

(9.556 Ac. 0.359 Ac. R/W
from E14-020-005-00)

N. & R. Baumer
E14-020-005-00
Deed: Vol. OR 100, Pg. 987
100.000 Acre

S.89°00'08"E.
887.50'

Open Ditch

Ref. Pin
Set

N.00°22'29"E.
288.65'
S.44°23'11"E.
20.00'
S.44°18'49"E.
20.00'

77.981 ACRE

1.804 AC. R/W

(68.425 Ac. 1.445 Ac. R/W
from E14-020-004-01)

N. & R. Baumer
E14-020-004-01
Deed: Vol. OR 121, Pg. 652
96.316 Acre
"I"-342

LEGEND

- Iron Pin Set
- Iron Pin Found
- ⊗ Mag Nail Set
- ⊗ Mag Nail Found
- ▲ R.R. Spike Set
- County Monument Box



State Route 364

K. & T. Albers
E14-020-003-01
Deed: Vol. OR 587, Pg. 1689
5.793 Acre
"Q"-451

N.01°26'59"E.
1,655.75'

S.W. Corner,
S.W. Quarter,
Section 20

State Route 119
(60' R/W)

Basis of Bearing is the centerline of State Route
119 and the South Line of the Southeast Quarter of
Section 20, Jackson Township as N.88°37'31"W. from
the Auglaize County GPS Survey

This Plat is Recorded in Survey Book "S",
Page 181, in the Auglaize County Engineer's Office.

ATTEST:

John W. Jauert
Professional Surveyor No. 6920

N.88°37'31"W.
716.70'

G. & J. Homan
E14-020-004-00
Deed: Vol. OR 614, Pg. 1016
6.000 Acre
"I"-342 & "R"-119

30' R/W Line

S.E. Corner,
S.E. Quarter,
Section 20



**Jauert
surveying**

11584 Monroe Road
Wapakoneta, Ohio
45895
(419) 657-6999

CLIENT: ROGER BAUMER SURVEY

COUNTY: Auglaize TOWNSHIP: Jackson SEC. 20

DRAWN BY: J.W.J. SCALE: 1"=250' DWG.# 15-617B

CHECKED BY: DATE: August 2015

SHEET 1 OF 2

(T-7-S; R-4-E)

- John Jauert
- 11584 Monroe Road
- Wapakoneta, Ohio 45895.



- Phone: (419) 657-6999
- FAX: (419) 657-2745
- E-Mail: jjsurvey@ohiolink.net

BAUMER-HOMAN SURVEY – 77.981 ACRE

The following described tract of land is part of the Southeast Quarter of Section 20, Town 7 South, Range 4 East, Jackson Township, Auglaize County, Ohio, being part of Parcel Nos. E14-020-005-00 & E14-020-004-01 and is more particularly described as follows:

Commencing at a Mag Nail (found) at the Southeast corner of the Southeast Quarter of Section 20 and in the intersections of the centerlines of State Route 119 and Township Road 31 (Tri-Township Road);

Thence N.88°37'31"W. along the centerline of State Route 119 and the South line of the Southeast Quarter of Section 20, a distance of 716.70 feet to a Mag Nail (found), which is the PLACE OF BEGINNING for the tract of land herein described;

Thence continuing N.88°37'31"W. along the above described line, a distance of 1,289.85 feet to a Mag Nail (found);

Thence N.01°26'59"E. a distance of 1,655.75 feet to a R.R Spike (set), passing thru an iron pin (found) for reference at 30.00 feet in the North right-of-way line of State Route 119;

Thence S.89°00'08"E., along the centerline of an open ditch, a distance of 887.50 feet to a point, being referenced by an iron pin (set) at S.44°18'49"E. a distance of 20.00 feet;

Thence N.00°22'29"E., along the centerline of an open ditch, a distance of 288.65 feet to a point, being referenced by an iron pin set at S.44°23'11"E. a distance of 20.00 feet;

Thence S.89°08'51"E., along the centerline of an open ditch, a distance of 1,121.70 feet to a Mag Nail (set), passing thru a R.R. Spike (set) at 1,096.70 feet in the West right-of-way line of Township Road 31;

Thence S.01°21'59"W. along the centerline of Township Road 31, a distance of 1,595.75 feet to a Mag Nail (found);

Thence N.88°37'31"W. a distance of 716.70 feet to an iron pin (found), passing thru an iron pin (found) at 25.00 feet in the West right-of-way line of Township Road 31;

Thence S.01°21'59"W. a distance of 364.67 feet to the Mag Nail (found), passing thru an iron pin (found) at 334.67 feet in the North right-of-way line of State Route 119, said Mag Nail was the true PLACE OF BEGINNING.

Containing in all 77.981 Acres of which 1.804 Acre has been used for highway purposes and being subject to all legal easements, restrictions and reservations, if any, of record or in use on said premises. Previous deed reference: Volume OR 100, Page 987 and OR 121, Page 652. This plat is recorded in Survey Book "S", Page 181, in the Auglaize County Engineer's Office. Basis for bearings for this tract is holding the centerline of State Route 119 and the South line of the Southeast Quarter of Section 20, Jackson Township as N.88°37'31"W. per the Auglaize County Global Positioning Survey.

ATTEST:

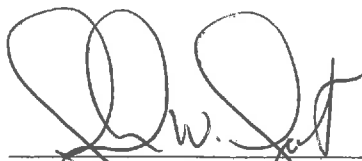
 John W. Jauert
 Professional Surveyor No. 6920

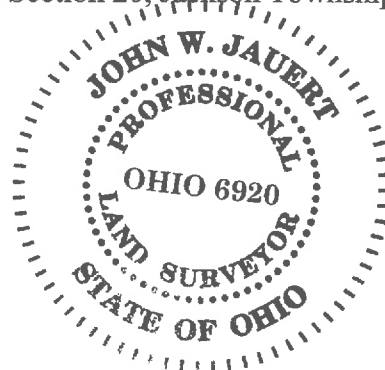

S-182