

HELEN KEMPER SURVEY

Part of the South 1/2 of Section 3, Town 6 South,
Range 6 East, Pusheta Township, Auglaize County, Ohio.

145-003-002-00
C.&J. Kantner (Trustees)
Deed: Vol. OR 554, Page 356
84.073 Acre
PUS-3-4, PUS-3-6

27' Wide
Ingress-Egress
Easement

N.E. Corner,
S.W. Quarter,
Section 3,
Pusheta Township

C.R. 171

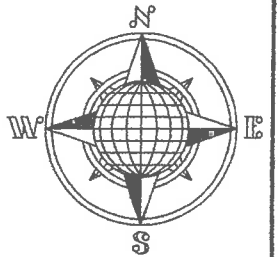

LOCATION PLAN

Section 3

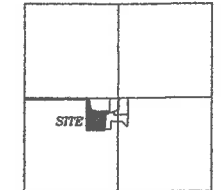

Pusheta Township,
T-6-S, R-6-E, Auglaize
County, Ohio.

125-003-006-00
Cora H. Kemper
Deed: Vol. OR 550,
Page 1150
41.936 Acre
"G"-779A, PUS-3-2

Basis of Bearing is the West Line
of the Southwest Quarter of
Section 3 and the Centerline of
Cemetery Road as N.00°26'49"E.
from the Auglaize GPS Survey.

This Plat is Recorded in Survey Book
"S", Page 223, in the Auglaize County
Engineer's Office.



GRAPHIC SCALE

C. Township Road 161 (Cemetery Road)

125-003-005-00
Ned Kantner
Deed: Vol. OR 578,
Page 1127
10.000 Acre

East Line of the West 34 Acre Parcel of the North One-Third of the Southwest Quarter of Section 3

North Line, S.W. 1/4, Section 3
125-003-018-00
Auglaize Fish & Game
Deed: Vol. 196, Page 749
23.960 Acre

Parcel 1
4.631 ACRE
Part of S.W. 1/4

125-003-006-02
B. & J. Christler
Deed: Vol. OR 36,
Page 425
2.004 Acre
"G"-782

Parcel 2
3.119 ACRE
Part of S.E. & S.W. 1/4

(0.275 ACRE)
Part of S.W. 1/4

Parcel 3
4.509 ACRE
Part of S.E. & S.W. 1/4

(1.400 ACRE)
Part of S.E. 1/4

Parcel 4
7.095 ACRE
Part of S.W. 1/4

125-003-006-00
Cora H. Kemper
Deed: Vol. OR 550,
Page 1150
41.936 Acre
"G"-779A, PUS-3-2

125-003-006-01
K. Taylor & J. Sudhoff
Deed: Vol. OR 473,
Page 2167
2.060 Acre
"G"-779A

125-003-007-00
Ned Kantner
Deed: Vol. OR 578,
Page 1127
78.500 Acre

LEGEND

- Iron Pin Set
- Iron Pin Found
- ⊗ Mag Nail Set
- Monument Box
- Mag/P.K. Nail Found

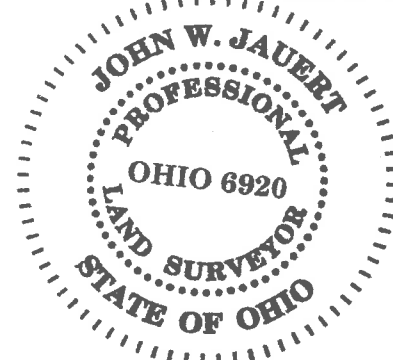

ATTEST:

John W. Jauert
John W. Jauert
Professional Surveyor No. 6920

Jauert
surveying

11584 Monroe Road
Wapakoneta, Ohio
45895
(419) 657-6999

CLIENT: Helen Kemper Survey

COUNTY: Auglaize TOWNSHIP: Pusheta SEC. 3

DRAWN BY: J.W.J. SCALE: 1"=130' DWG.# 15-4166

CHECKED BY: DATE: August 2015

SHEET 1 OF 6 REV 08/23/17 (T-6-S; R-6-E)

5-223

- John Jauert
- 11584 Monroe Road
- Wapakoneta, Ohio 45895



- Phone: (419) 657-6999
- FAX: (419) 657-2745
- E-Mail: jjsurvey@ohiolink.net

KEMPER-CHRISTLER SURVEY PARCEL ONE -4.631 ACRE

The following described tract of land is part of the Southwest Quarter of Section 3, Town 6 South, Range 6 East, Pusheta Township, Auglaize County, Ohio, and part of Parcel No. I25-003-006-00 and is more particularly described as follows:

Commencing at a Monument Box found at the Northwest Corner of the Southwest Quarter of Section 3, Pusheta Township and in the centerline of Township Road 161 (Cemetery Road);

Thence S.88°52'38"E. along the North line of the Southwest Quarter of Section 3, a distance of 1,824.79 feet to an iron pin (set), which is the PLACE OF BEGINNING for the tract of land herein described;

Thence continuing S.88°52'38"E along the above described line, a distance of 573.62 feet to an iron pin (set), passing thru an iron pin (found) at 145.45 feet;

Thence S.01°01'55"W. a distance of 371.20 feet to an iron pin (set);

Thence S.81°18'04"W. a distance of 45.26 feet to an iron pin (set);

Thence N.78°35'17"W. a distance of 62.21 feet to an iron pin (set);

Thence S.85°36'25"W. a distance of 230.54 feet to an iron pin (set);

Thence N.71°27'10"W. a distance of 191.28 feet to an iron pin (set);

Thence N.08°30'13"W. a distance of 337.44 feet to the iron pin, which was the true PLACE OF BEGINNING.

Containing in all 4.631 Acre located in the Southwest Quarter of Section 3, Pusheta Township. The above-described tract of land is subject to all legal easements, restrictions and reservations, if any, of record or in use on said premises. Previous Deed Reference: Volume OR 550, page 1,150. The above description and plat are recorded in Survey Book "S", Page 223, in the Auglaize County Engineer's Office. Basis of bearing is holding the West line of the Southwest Quarter of Section 3 and the centerline of Township Road 161 as N.00°26'49"E. per the Auglaize County Global Positioning Survey. The above description was based on an actual field survey performed by me, John W. Jauert in August 2015.

ATTEST:

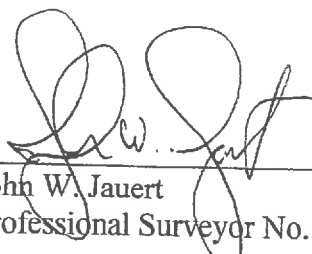

John W. Jauert
Professional Surveyor No. 6920



S-224

- John Jauert
- 11584 Monroe Road
- Wapakoneta, Ohio 45895



- Phone: (419) 657-6999
- FAX: (419) 657-2745
- E-Mail: jjsurvey@ohiolink.net

KEMPER-CHRISTLER SURVEY PARCEL TWO - 3.119 ACRE

The following described tract of land is part of the Southeast and Southwest Quarters of Section 3, Town 6 South, Range 6 East, Pusheta Township, Auglaize County, Ohio, and part of Parcel No. I25-003-006-00 and is more particularly described as follows:

Commencing at a Monument Box found at the Northwest Corner of the Southwest Quarter of Section 3, Pusheta Township and in the centerline of Township Road 161 (Cemetery Road);

Thence S.88°52'38"E. along the North line of the Southwest Quarter of Section 3, a distance of 2,662.91 feet to an iron pin (set) which is the PLACE OF BEGINNING for the tract of land herein described;

Thence continuing S.88°52'38"E. a distance of 259.02 feet to an iron pin (set);

Thence S.01°02'10"W. a distance of 470.16 feet to a point, passing thru an iron pin (set) for reference at 290.02 feet;

Thence N.89°15'23"W. a distance of 370.69 feet to an iron pin (set), passing thru an iron pin (set) for reference at 295.70 feet;

Thence N.01°01'55"E. a distance of 96.35 feet to an iron pin (set);

Thence N.64°08'51"E. a distance of 125.24 feet to an iron pin (found);

Thence N.01°01'55"E. a distance of 319.45 feet to the iron pin (set), which was the true PLACE OF BEGINNING.

Containing in all 3.119 Acre. 0.275 Acre being in the Southwest Quarter and 2.844 Acre being in the Southeast Quarter of Section 3, Pusheta Township. The above-described tract of land is subject to all legal easements, restrictions and reservations, if any, of record or in use on said premises. Previous Deed Reference: Volume OR 550, page 1,150. The above description and plat are recorded in Survey Book "S", Page 223, in the Auglaize County Engineer's Office. Basis of bearing is holding the West line of the Southwest Quarter of Section 3 and the centerline of Township Road 161 as N.00°26'49"E. per the Auglaize County Global Positioning Survey. The above description was based on an actual field survey performed by me, John W. Jauert in August 2015.

Subject to the following ingress-egress easement:

- John Jauert
- 11584 Monroe Road
- Wapakoneta, Ohio 45895



- Phone: (419) 657-6999
- FAX: (419) 657-2745
- E-Mail: jjsurvey@ohiolink.net

KEMPER-CHRISTLER SURVEY – EASEMENT PARCEL TWO - 3.191 ACRE (cont.)

The following described tract of land is part of the Southeast Quarter of Section 3, Town 6 South, Range 6 East, Pusheta Township, Auglaize County, Ohio, and part of Parcel No. I25-003-006-00 and is more particularly described as follows:

Commencing at a Monument Box found at the Northwest Corner of the Southwest Quarter of Section 3, Pusheta Township and in the centerline of Township Road 161 (Cemetery Road);

Thence S.88°52'38"E. along the North line of the Southwest Quarter of Section 3, a distance of 2,662.91 feet to an iron pin (set);

Thence S.01°01'55"W. a distance of 263.39 feet to an iron pin (set), which is the PLACE OF BEGINNING for the tract of land herein described;

Thence N.64°08'51"E. a distance of 4.84 feet to an iron pin (set);

Thence N.90°00'00"E. a distance of 139.35 feet to an iron pin (set);

Thence N.55°37'38"E. a distance of 141.53 feet to an iron pin (set);

Thence S.01°02'10"W. a distance of 61.35 feet to an iron pin (set);

Thence S.55°27'38"W. a distance of 121.45 feet to an iron pin (set);

Thence S.90°00'00"W. a distance of 143.32 feet to an iron pin (set);

Thence S.64°08'51"W. a distance of 18.73 feet to an iron pin (set);

Thence N.01°01'55"E. a distance of 56.07 feet to the iron pin (found), which was the true PLACE OF BEGINNING.

Containing in all 0.328 Acre. The above-described tract of land is subject to all legal easements, restrictions and reservations, if any, of record or in use on said premises. Previous Deed Reference: Volume OR 550, page 1,150. The above description and plat are recorded in Survey Book "S", Page 223 in the Auglaize County Engineer's Office. Basis of bearing is holding the West line of the Southwest Quarter of Section 3 and the centerline of Township Road 161 as N.00°26'49"E. per the Auglaize County Global Positioning Survey. The above description was based on an actual field survey performed by me, John W. Jauert in August 2015.

ATTEST:

John W. Jauert

Professional Surveyor No. 6920

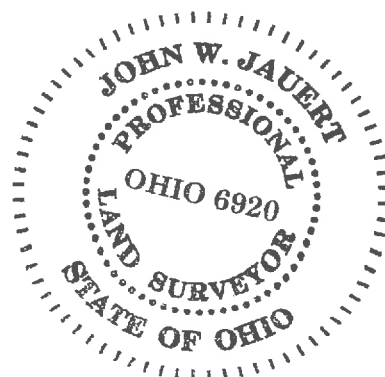

- John Jauert
- 11584 Monroe Road
- Wapakoneta, Ohio 45895



- Phone: (419) 657-6999
- FAX: (419) 657-2745
- E-Mail: jjsurvey@ohiolink.net

KEMPER-TAYLOR-SUDHOFF SURVEY PARCEL THREE -4.509 ACRE

The following described tract of land is part of the Southeast and Southwest Quarters of Section 3, Town 6 South, Range 6 East, Pusheta Township, Auglaize County, Ohio, and part of Parcel No. I25-003-006-00 and is more particularly described as follows:

Commencing at a Monument Box found at the Northwest Corner of the Southwest Quarter of Section 3, Pusheta Township and in the centerline of Township Road 161 (Cemetery Road);

Thence S.88°52'38"E. along the North line of the Southwest Quarter of Section 3, a distance of 2,921.93 feet to an iron pin (set);

Thence S.01°02'10"W. a distance of 470.16 feet to a point, which is the PLACE OF BEGINNING for the tract of land herein described;

Thence S.04°27'48"W. a distance of 338.06 feet to an iron pin (found);

Thence N.43°03'26"W. a distance of 210.72 feet to an iron pin (found);

Thence N.88°45'08"W. a distance of 308.21 feet to an iron pin (found);

Thence S.01°15'59"W. a distance of 221.15 feet to an iron pin (found);

Thence N.88°45'08"W. a distance of 211.53 feet to an iron pin (set);

Thence N.04°49'31"E. a distance of 456.75 feet to an iron pin (set);

Thence N.85°36'25"E. a distance of 25.91 feet to an iron pin (set);

Thence S.78°35'17"E. a distance of 64.14 feet to an iron pin (set);

Thence N.81°18'04"E. a distance of 69.10 feet to an iron pin (set);

Thence N.73°17'38"E. a distance of 136.05 feet to an iron pin (set);

Thence S.01°01'55"W. a distance of 96.35 feet to an iron pin (set);

Thence S.89°15'23"E. a distance of 370.69 feet to the point, passing thru an iron pin (set) for reference at 74.99 feet, said point was the true PLACE OF BEGINNING.

- John Jauert
- 11584 Monroe Road
- Wapakoneta, Ohio 45895.

Jauert Surveying

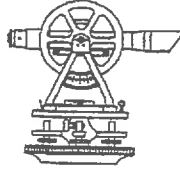

- Phone: (419) 657-6999
- FAX: (419) 657-2745
- E-Mail: jjsurvey@ohiolink.net

**KEMPER-TAYLOR-SUDHOFF SURVEY
PARCEL THREE - 4.509 ACRE (cont.)**

Containing in all 4.509 Acre. 3.109 Acre being in the Southwest Quarter and 1.400 Acre being in the Southeast Quarter of Section 3, Pusheta Township. The above-described tract of land is subject to all legal easements, restrictions and reservations, if any, of record or in use on said premises. Previous Deed Reference: Volume OR 550, page 1,150. The above description and plat are recorded in Survey Book "S", Page 223, in the Auglaize County Engineer's Office. Basis of bearing is holding the West line of the Southwest Quarter of Section 3 and the centerline of Township Road 161 as N.00°26'49"E. per the Auglaize County Global Positioning Survey. The above description was based on an actual field survey performed by me, John W. Jauert in August 2015.

ATTEST:

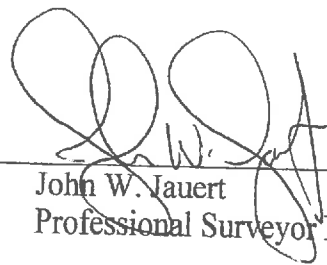
John W. Jauert
Professional Surveyor No. 6920



- John Jauert
- 11584 Monroe Road
- Wapakoneta, Ohio 45895.



- Phone: (419) 657-6999
- FAX: (419) 657-2745
- E-Mail: jjsurvey@ohiolink.net

KEMPER-SUDHOFF SURVEY PARCEL FOUR -7.095 ACRE

The following described tract of land is part of the Southwest Quarter of Section 3, Town 6 South, Range 6 East, Pusheta Township, Auglaize County, Ohio, and part of Parcel No. I25-003-006-00 and is more particularly described as follows:

Commencing at a Monument Box found at the Northwest Corner of the Southwest Quarter of Section 3, Pusheta Township and in the centerline of Township Road 161 (Cemetery Road);

Thence S.88°52'38"E. along the North line of the Southwest Quarter of Section 3, a distance of 1,678.08 feet to a point, being referenced by an iron pin (found) at N.00°28'07"E. a distance of 2.50 feet;

Thence S.00°28'07"E. a distance of 47.50 feet to an iron pin (set), which is the PLACE OF BEGINNING for the tract of land herein described;

Thence S.88°56'48"E. a distance of 103.48 feet to an iron pin (set);

Thence S.08°30'13"E. a distance of 328.48 feet to an iron pin (set);

Thence S.71°27'10"E. a distance of 232.04 feet to an iron pin (set);

Thence N.85°36'25"E. a distance of 207.83 feet to an iron pin (set);

Thence S.04°49'31"W. a distance of 456.75 feet to an iron pin (set);

Thence N.89°12'51"W. along the South line of the North one-third of the Southwest Quarter of Section 3, a distance of 547.68 feet to an iron pin (found);

Thence N.00°28'07"E. a distance of 832.32 feet to the iron pin, which was the true PLACE OF BEGINNING.

Containing in all 7.095 Acre located in the Southwest Quarter of Section 3, Pusheta Township. The above-described tract of land is subject to all legal easements, restrictions and reservations, if any, of record or in use on said premises. Previous Deed Reference: Volume OR 550, page 1,150. The above description and plat are recorded in Survey Book "S", Page 223, in the Auglaize County Engineer's Office. Basis of bearing is holding the West line of the Southwest Quarter of Section 3 and the centerline of Township Road 161 as N.00°26'49"E. per the Auglaize County Global Positioning Survey. The above description was based on an actual field survey performed by me, John W. Jauert in August 2015.

ATTEST: _____

John W. Jauert
Professional Surveyor No. 6920

