

# SHOBE SURVEY

PT. S.W. 1/4, SEC. 29, T-5-S,  
R-5-E, Goshen Township,  
Auglaize County, Ohio.

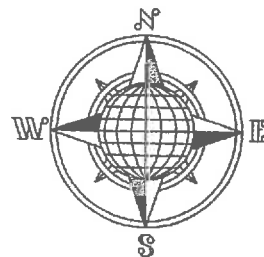

## LOCATION PLAN

Section 29

Wayne Twp.  
Goshen Twp.

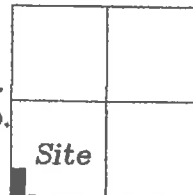

T-5-S, R-8-E, Auglaize  
County, Ohio.

N.W. Corner,  
S.W. Quarter,  
Section 29

D12-029-003-01  
R. & C. Grover  
Deed: Vol. OR 393,  
Page 414.  
"I"-451 & "I"-622

D12-029-003-02  
Highlawn Farms Family  
Limited Partnership  
Deed: Vol. OR 352,  
Page 452.

S.89°58'33"E.

393.69'

Tract 1  
2.852 Ac. Total  
0.185 Ac. R/W

308.44'  
S.00°35'45"W.

N.87°56'26"E.

394.10'

D12-029-003-00  
G. & T. Shobe  
Deed: Vol. OR 651,  
Page 936.  
"I"-512

Tract 2  
3.944 Ac. Total  
0.416 Ac. R/W

443.53'  
S.00°35'45"W.

Basis of Bearing is the West Line  
of the Southwest Quarter of  
Section 29 and the Centerline of  
Waynesfield Road as N.00°35'45"E.  
from previous survey, I-512

This Plat is Recorded in Survey  
Book "S", Page 269 in the Auglaize  
County Engineer's Office.

This Plat and the accompanying  
Legal Description represents an  
actual Boundary Survey completed  
by me, John W. Jauert, in November, 2015.

## LEGEND

- Iron Pin Found
- Iron Pin Set
- Mag Nail Set
- PK Nail Found
- Monument Box



D12-029-003-02  
Highlawn Farms Family  
Limited Partnership  
Deed: Vol. OR 352,  
Page 452.

S.E. Corner,  
S.W. Quarter,  
Section 29

Reference pin Found  
25.00' from C/L

20' R/W Line

393.69'

N.89°58'48"W.

N.89°58'48"W.

2,308.65'

S.W. Corner,  
S.W. Quarter,  
Section 29

County Road 150 (40 R/W)  
(Middle Pike)

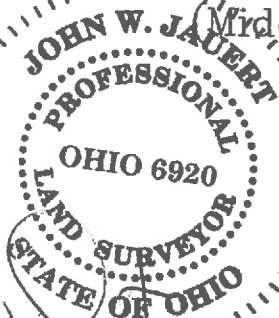

ATTEST:

John W. Jauert  
Professional Surveyor No. 6920

**Jauert**  
surveying

11584 Monroe Road  
Wapakoneta, Ohio  
45895  
(419) 657-6999

CLIENT: Preston Shobe

COUNTY: Auglaize TOWNSHIP: Goshen SEC. 29

DRAWN BY: J.W.J. SCALE: 1"=125' DWG.# 15-4178

CHECKED BY: DATE: November, 2015

SHEET 1 OF 3

(T-5-S; R-8-E)

S-2109

- John Jauert
- 11584 Monroe Road
- Wapakoneta, Ohio 45895



- Phone: (419) 657-6999
- FAX: (419) 657-2745
- E-Mail: jjsurvey@ohiolink.net

## SHOBE DESCRIPTION PARCEL NO. 1 2.852 ACRE

The following described tract of land is part of the Southwest Quarter of Section 29, Town 5 South, Range 8 East, Wayne Township, Auglaize County, Ohio, being part of Parcel No. D12-029-003-00 and is more particularly described as follows:

Commencing at a Monument Box (found) at the Southwest corner of the Southwest Quarter of Section 29, Wayne Township and in the intersection of the centerlines of County Road 261 (Waynesfield Road) and County Road 150 (Middle Pike);

Thence N.00°35'45"E. along the West line of the Southwest Quarter of Section 29 and the centerline of County Road 261, a distance of 429.23 feet to a Mag Nail (set), which is the PLACE OF BEGINNING for the tract of land herein described;

Thence continuing N.00°35'45"E. along the above described line, a distance of 322.77 feet to a P.K. Nail (found);

Thence S.89°58'33"E. a distance of 393.69 feet to an iron pin (found), passing thru an iron pin (found) at 25.00 feet in the East right-of-way line of County Road 261;

Thence S.00°35'45"W, parallel to the West line of the Southwest Quarter of said Section 29 and the centerline of County Road 261, a distance of 308.44 feet to an iron pin (set);

Thence S.87°56'26"W. a distance of 394.10 feet to the Mag Nail (set), passing thru an iron pin (set) for reference at 369.07 feet in the East right-of-way line of County Road 261, said Mag Nail was the true PLACE OF BEGINNING.

Containing in all 2.852 Acres of which 0.185 Acre is subject to easement for highway purposes. The above-described tract of land is subject to all legal easements, restrictions and reservations, if any, of record or in use on said premises. Previous deed reference: Volume OR 651, page 936. This plat is recorded in Survey Book "S", page 269 in the Auglaize County Engineer's Office. Basis of bearing is the West line of the Southwest Quarter of Section 29, Wayne Township and the centerline of County Road 261 as N.00°35'45"E. from a previous survey found in Book "I", page 512. This description is based on an actual field survey, performed by me, John W. Jauert in November 2015.

ATTEST:

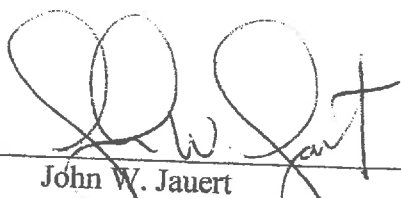
  
John W. Jauert  
Professional Surveyor No. 6920

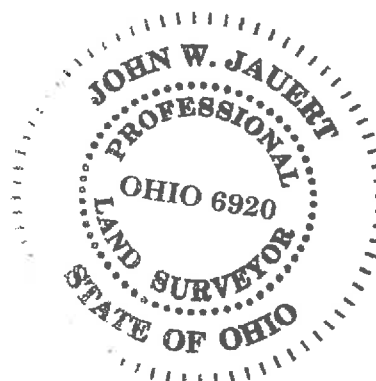

S-270

- John Jauert
- 11584 Monroe Road
- Wapakoneta, Ohio 45895



- Phone: (419) 657-6999
- FAX: (419) 657-2745
- E-Mail: jjsurvey@ohiolink.net

## SHOBE DESCRIPTION PARCEL NO. 2 3.944 ACRE

The following described tract of land is part of the Southwest Quarter of Section 29, Town 5 South, Range 8 East, Wayne Township, Auglaize County, Ohio, being part of Parcel No. D12-029-003-00 and is more particularly described as follows:

The PLACE OF BEGINNING is at a Monument Box (found) at the Southwest corner of the Southwest Quarter of Section 29, Wayne Township and in the intersection of the centerlines of County Road 261 (Waynesfield Road) and County Road 150 (Middle Pike);

Thence N.00°35'45"E. along the West line of the Southwest Quarter of Section 29 and the centerline of County Road 261, a distance of 429.23 feet to a Mag Nail (set);

Thence N.87°56'26"E. a distance of 394.10 feet to an iron pin (set), passing thru an iron pin (set) for reference at 25.03 feet in the East right-of-way line of County Road 261;

Thence S.00°35'45"W, parallel to the West line of the Southwest Quarter of said Section 29 and the centerline of County Road 261, a distance of 443.53 feet to a P.K. Nail (found), passing thru an iron pin (found) at 418.53 feet;

Thence N.89°58'48"W. along the centerline of County Road 150 and the South line of the Southwest Quarter of Section 29, a distance of 393.69 feet to the Monument Box (found), which was the true PLACE OF BEGINNING.

Containing in all 3.944 Acres of which 0.416 Acre is subject to easement for highway purposes. The above-described tract of land is subject to all legal easements, restrictions and reservations, if any, of record or in use on said premises. Previous deed reference: Volume OR 651, page 936. This plat is recorded in Survey Book "S", page 269 in the Auglaize County Engineer's Office. Basis of bearing is the West line of the Southwest Quarter of Section 29, Wayne Township and the centerline of County Road 261 as N.00°35'45"E. from a previous survey found in Book "I", page 512. This description is based on an actual field survey, performed by me, John W. Jauert in November 2015.

ATTEST:

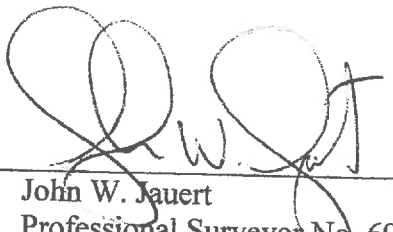
  
John W. Jauert  
Professional Surveyor No. 6920



S-271