

SCHROEDER SURVEY

Part of the Northwest Quarter of Section 18,
Town 5 South, Range 6 East,
Duchouquet Township, Auglaize County, Ohio.

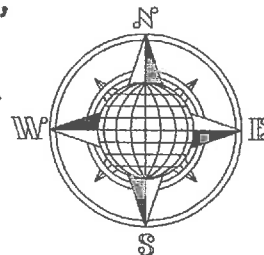

LOCATION PLAN

Section 18

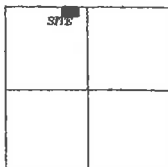

Duchouquet Township,
T-5-S, R-6-E, Auglaize
County, Ohio.

N.E. Corner,
N.W. Quarter,
Section 18.

Ⓢ Township Road 180, 50' R/W
(Wapakoneta-Buckland Road)

N.89°56'54"E.
2,237.39'

N.89°56'54"E.
253.52'

S.89°56'54"W.
109.83'

N.W. Corner,
N.W. Quarter,
Section 18.

25' R/W Line

1.145 ACRE
0.145 AC R/W

B05-018-007-00
J. & B. Schroeder
Deed Vol. OR 435
Page 2262
28.270 Acre

B05-018-007-02
J. & B. Schroeder
Deed Vol. OR 537,
Page 1625
11.730 Acre

Leaving 10.585± acre left out
of the original 11.73 acre tract.

LEGEND

- 5/8"x30" Iron Pin Set/Cap
- ⊗ Mag Nail Set
- Monument Box

Basis of Bearing is the North Line
of the Northwest Quarter of
Section 18 and the Centerline of
Township Road 180 as N.89°56'54"E.
from the Auglaize County GPS Survey.

This Plat is Recorded in Survey
Book "S", Page 316 in the Auglaize
County Engineer's Office.

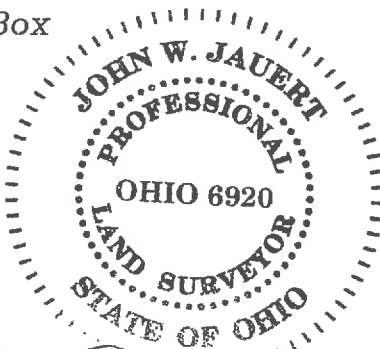

Auglaize Co. Tax Map
Survey Book S-316

ATTEST:

John W. Jauert
John W. Jauert
Professional Surveyor No. 6920

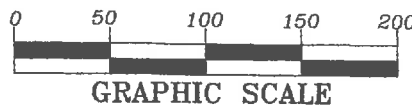

GRAPHIC SCALE

Jauert
surveying

11584 Monroe Road
Wapakoneta, Ohio
45895
(419) 657-6999

CLIENT: John Schroeder	
COUNTY: Auglaize	TOWNSHIP: Duchouquet SEC. 18
DRAWN BY: J.W.J.	SCALE: 1"=100' DWG.# 16-4193
CHECKED BY:	DATE: January 2016
SHEET 1 OF 2	(T-5-S; R-6-E)

- John Jauert
- 11584 Monroe Road
- Wapakoneta, Ohio 45895



- Phone: (419) 657-6999
- FAX: (419) 657-2745
- E-Mail: jjsurvey@ohiolink.net

JOHN SCHROEDER SURVEY 1.145 ACRE

The following described tract of land is part of the Northwest Quarter of Section 18, Town 5 South, Range 6 East, Duchouquet Township, Auglaize County, Ohio, being part of Parcel No. B05-018-007-02 and is more particularly described as follows:

Commencing at a Monument Box (found) at the Northeast corner of the Northwest Quarter of Section 18 and in the centerline of Township Road 180 (Wapakoneta-Buckland Road);

Thence S.89°56'54"W. along the centerline of Township Road 180 and the North line of the Northwest Quarter of said Section 18 a distance of 109.83 feet to a Mag Nail (set), which is the PLACE OF BEGINNING for the tract of land herein described;

Thence S.00°11'02"W. a distance of 195.08 feet to an iron pin (set), passing thru an iron pin (set) for reference at 25.00 feet in the South right-of-way line of County Road 180;

Thence S.89°56'54"W. , parallel to the centerline of Township Road 180 and the North line of the Northwest Quarter of said Section 18, a distance of 258.15 feet to an iron pin (set);

Thence N.01°32'37"E. a distance of 195.15 feet to a Mag Nail (set), passing thru an iron pin (set) for reference at 170.15 feet in the South right-of-way line of Township Road 180;

Thence N.89°56'54"E., along the centerline of Township Road 180, a distance of 253.52 feet to the Mag Nail which was the true PLACE OF BEGINNING.

Containing in all 1.145 Acres of which 0.145 Acre has been used for highway purposes and being subject to all legal easements, restrictions and reservations, if any, of record or in use on said premises. Previous deed reference: Volume OR 537, Page 1625. This plat is recorded in Survey Book "S", Page 316, in the Auglaize County Engineer's Office. Basis for bearings for this tract is holding the centerline of Township Road 180 and the North line of the Northwest Quarter of Section 18, Duchouquet Township as N.89°56'54"E. per the Auglaize County Global Positioning System. This Plat and description was prepared from an actual field survey of the above premises by John W. Jauert, Professional Surveyor No. 6920 in January 2016.

ATTEST:

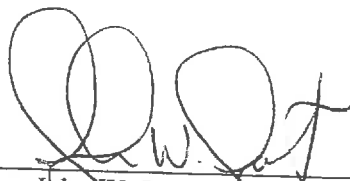
John W. Jauert
Professional Surveyor No. 6920

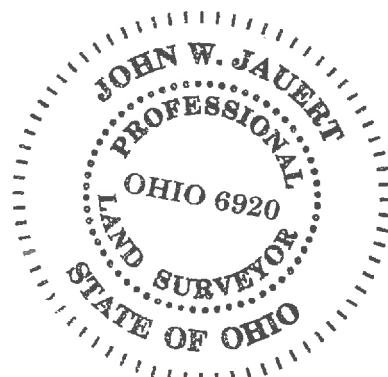

S-317