

SHOBE SURVEY

Part of the Southwest Quarter of Section 35,
Town 5 South, Range 7 East,
Union Township, Auglaize County, Ohio.

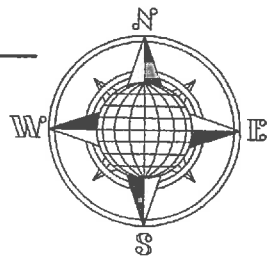

S.89°24'46"E.
990.50'

N.W. Corner,
S.W. Quarter,
Section 35.

LOCATION PLAN

Section 35

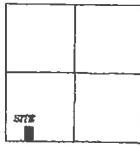

Union Township,
T-5-S, R-7-E, Auglaize
County, Ohio.

L33-035-002-00
G. & T. Shobe
Deed Vol. OR 637,
Page 1694
60.3 Acre
"J"-238

1,733.15'
S.00°56'44"W.

County Road 231
(Wrestle Creek Road)

Basis of Bearing is the West Line
of the Southwest Quarter of Section
35 and the centerline of County Road
231 as N.00°56'44"E. per the Auglaize
County Global Positioning Survey.

This Plat is Recorded in Survey
Book "S", Page 328 in the Auglaize
County Engineer's Office.

L33-035-002-00
G. & T. Shobe
Deed Vol. OR 637,
Page 1694
60.3 Acre
"J"-238

Leaving 55.127± Acre left out
of the original 60.3 Acre tract.

S.89°24'53"E.
250.00'

5.273 ACRE
0.172 AC. R/W

N.00°56'44"E.
918.76'

S.00°56'44"W.
918.76'

L33-035-003-00
J.W. Campbell
Vol.194, Pg. 716
87.919 Acres
"J"-238-239-240

30' R/W Line

740.50'
N.89°24'53"W.

250.00'
N.89°24'53"W.

S.W. Corner,
S.W. Quarter,
Section 35.

State Route 33

LEGEND

- 5/8"x30" Iron Pin Set/Cap
- Iron Pin Found
- ⊗ Mag Nail Set
- Monument Box

Auglaize Co. Tax Map
Survey Book S-328

ATTEST:

John W. Jauert
Professional Surveyor No. 6920

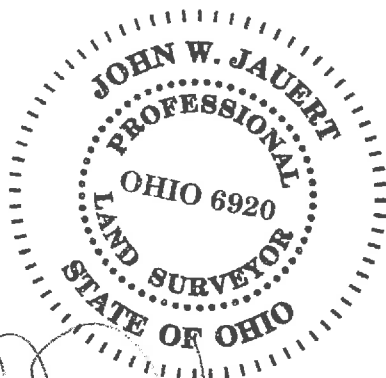

Jauert
surveying

11584 Monroe Road
Wapakoneta, Ohio
45895
(419) 657-6999

CLIENT:	Greg Shobe				
COUNTY:	Auglaize	TOWNSHIP:	Union	SEC.	35
DRAWN BY:	J.W.J.	SCALE:	1"=150'	DWG.#	16-4198
CHECKED BY:		DATE:	February 2016		
SHEET	1 OF 2				(T-5-S; R-7-E)

- John Jauert
- 11584 Monroe Road
- Wapakoneta, Ohio 45895



- Phone: (419) 657-6999
- FAX: (419) 657-2745
- E-Mail: jjsurvey@ohiolink.net

GREG SHOBE SURVEY 5.273 ACRE

The following described tract of land is part of the Southwest Quarter of Section 35, Town 5 South, Range 7 East, Union Township, Auglaize County, Ohio, being part of Parcel No. L33-035-002-00 and is more particularly described as follows:

Commencing at a Monument Box (found) at the Northwest corner of the Southwest Quarter of Section 35 and in the centerline of County Road 231 (Wrestle Creek Road);
 Thence S.89°24'46"E. along the North line of the Southwest Quarter of said Section 35, a distance of 990.50 feet to an iron pin (found);
 Thence S.00°56'44"W. a distance of 1,733.15 feet to an iron pin (set), which is the PLACE OF BEGINNING for the tract of land herein described;
 Thence continuing S.00°56'44"W. a distance of 918.76 feet to a Mag Nail (set), passing thru an iron pin (found) at 888.76 in the North right-of-way line of State Route 33;
 Thence N.89°24'53"W. along the centerline of State Route 33, a distance of 250.00 feet to a Mag Nail (set);
 Thence N.00°56'44"E. a distance of 918.76 feet to an iron pin (set), passing thru an iron pin (set) at 30.00 feet in the North right-of-way line of State Route 33;
 Thence S.89°24'53"E., parallel to the centerline of State Route 33, a distance of 250.00 feet to the iron pin (set), which was the true PLACE OF BEGINNING.

Containing in all 5.273 Acres of which 0.172 Acre has been used for highway purposes and being subject to all legal easements, restrictions and reservations, if any, of record or in use on said premises. Previous deed reference: Volume OR 637, Page 1694. This plat is recorded in Survey Book "S", Page 328, in the Auglaize County Engineer's Office. Basis for bearings for this tract is holding the West line of the Southwest Quarter of Section 35, Union Township and the centerline of County Road 231 as N.00°56'44"E. per the Auglaize County Global Positioning Survey. This plat and description was prepared from an actual field survey of the above premises by John W. Jauert, P.S. in February 2016.

ATTEST:

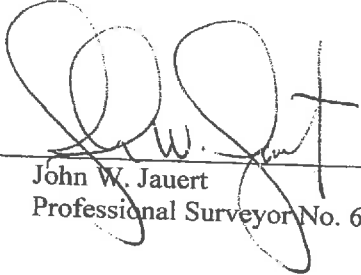
 John W. Jauert
 Professional Surveyor No. 6920

