

# BOWSHER ESTATE SURVEY

Part of the Northwest Quarter of Section 5, T-5-S,  
R-5-E, Logan Township, Auglaize County, Ohio.

## LOCATION PLAN

Section 5

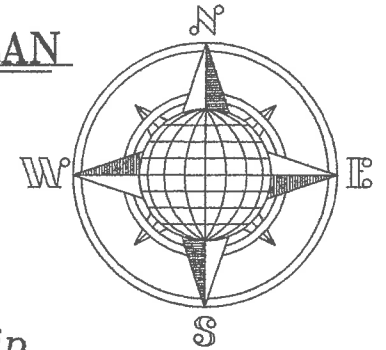
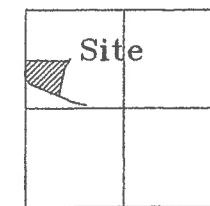

Logan Township,  
T-5-S, R-5-E, Auglaize  
County, Ohio.

N.W. Corner,  
N.W. 1/4,  
Section 5

(Eisley Road)  
C.R. 81 (50' R/W)

19.97'  
N.00°45'53"E. 0.011 AC. R/W

A.P. Bowsher (Trustee)  
F19-005-002-00  
Deed: Vol. OR 548, Pg. 1520  
18.572 Acre

970.42' N.89°28'26"W.

18.434 ACRE  
0.983 AC. R/W

A.P. Bowsher (Trustee)  
F19-005-003-00  
Deed: Vol. OR 548, Pg. 1520  
19.200 Acre

⊕ Foltz Ditch

63.56'  
N.11°51'41"E.

131.69'  
N.09°14'32"E.

27.39'  
N.23°24'13"E.  
43.77'  
N.67°33'19"W.

22.08'  
S.24°54'59"W.

95.99'  
S.41°17'05"W.

82.51'  
S.34°03'17"W.

1.245 ACRE

A.P. Bowsher (Trustee)  
F19-005-005-04  
Deed: Vol. OR 548, Pg. 1520  
43.592 Acre  
D-393

589.14'  
S.11°51'41"W.

234.07'  
S.01°08'12"W.

0.099 ACRE  
0.026 AC. R/W



## LEGEND

- Iron Pin Set
- Iron Pin Found
- ∅ Mag Nail Set
- ✱ Mag Nail Found
- ▲ R.R. Spike Set
- County Monument Box



Basis of Bearing is holding the South Line of the  
Northeast Quarter of Section 5, Logan Township  
as N.89°23'56"W. from the Auglaize Cty. GPS Survey.

This Plat is Recorded in Survey Book "S",  
Page 453, in the Auglaize County Engineer's Office.

ATTEST:

John W. Jauert  
Professional Surveyor No. 6920

This plat is based on an actual field  
survey, performed by me, John W.  
Jauert, P.S. in June 2016.

Jauert  
surveying

11584 Monroe Road  
Wapakoneta, Ohio  
45895  
(419) 657-6999

CLIENT: BOWSHER ESTATE - RUSS / DIANA
COUNTY: Auglaize TOWNSHIP: Logan SEC. 5
DRAWN BY: J.W.J. SCALE: 1"=180' DWG.# 16-42090
CHECKED BY: DATE: June 2016
SHEET 1 OF 4 (T-5-S; R-5-E)

- John Jauert
- 11584 Monroe Road
- Wapakoneta, Ohio 45895



- Phone: (419) 657-6999
- FAX: (419) 657-2745
- E-Mail: jjsurvey@ohiolink.net

## DIANA FISHER TO RUSS BOWSHER SURVEY 1.245 ACRE

The following described tract of land is part of the Northwest Quarter of Section 5, Town 5 South, Range 5 East, Logan Township, Auglaize County, Ohio, being part of Parcel No. F19-005-005-04 and is more particularly described as follows:

Commencing at a Monument Box (found) at the Northwest Corner of the Northwest Quarter of Section 5, Logan Township and in the centerline of County Road 81 (Eisley Road);  
Thence S.00°45'53"W. along the West line of the Northwest Quarter of said Section 5, a distance of 1,399.00 feet to a Mag Nail (set);

Thence S.89°28'26"E. a distance of 1,195.83 feet to a point in the centerline of the Foltz Ditch, passing thru an iron pin (set) for reference at 25.00 feet in the East right-of-way line of County Road 81 and passing thru an iron pin (set) for reference at 1,170.83 feet;

Thence S.24°54'59"W. along the centerline of the Foltz Ditch, a distance of 22.08 feet to a point which is the PLACE OF BEGINNING for the tract of land herein described;

Thence S.41°17'05"W., along the centerline of the Foltz ditch, a distance of 95.99 feet to a point;

Thence S.34°03'17"W., along the centerline of the Foltz ditch, a distance of 82.51 feet to a point;

Thence S.11°51'41"W., along the centerline of the Foltz ditch, a distance of 589.14 feet to a point;

Thence N.01°08'12"E. a distance of 719.29 feet to a point;

Thence S.89°26'44"E. a distance of 216.37 feet to the point which was the true PLACE OF BEGINNING.

Containing in all 1.245 Acres. The above described tract of land is subject to all legal easements, restrictions and reservations, if any, of record or in use on said premises. Previous deed reference: Volume OR 548, Page 1520. This plat is recorded in Survey Book "S", Page 453, in the Auglaize County Engineer's Office. Basis for bearings for this tract is holding the South line of the Northeast Quarter of Section 5, Logan Township as N.89°23'56"W. per the Auglaize County Global Positioning Survey. This plat and description was prepared from an actual field survey of the above premises by John W. Jauert, P.S. in June 2016.

ATTEST:

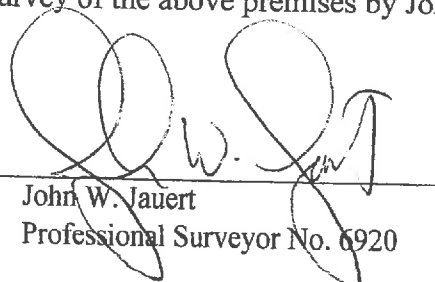
  
John W. Jauert  
Professional Surveyor No. 6920

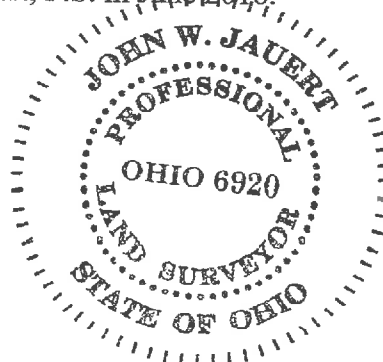

- John Jauert
- 11584 Monroe Road
- Wapakoneta, Ohio 45895



- Phone: (419) 657-6999
- FAX: (419) 657-2745
- E-Mail: jjsurvey@ohiolink.net

## RUSS BOWSHER TO DIANA FISHER SURVEY 0.099 ACRE

The following described tract of land is part of the Northwest Quarter of Section 5, Town 5 South, Range 5 East, Logan Township, Auglaize County, Ohio, being part of Parcel No. F19-005-003-00 and is more particularly described as follows:

Commencing at a Monument Box (found) at the Northwest Corner of the Northwest Quarter of Section 5, Logan Township and in the centerline of County Road 81 (Eisley Road);  
Thence S.00°45'53"W. along the West line of the Northwest Quarter of said Section 5, a distance of 1,916.71 feet to a Mag Nail (found);

Thence S.51°29'14"E. along the centerline of State Route 197 a distance of 228.77 feet to a Monument Box (found) at the P.I. of a curve to the left;

Thence S.67°33'19"E. along the centerline of State Route 197, a distance of 799.18 feet to a Mag Nail (set), which is the PLACE OF BEGINNING for the tract of land herein described;

Thence N.23°24'13"E. a distance of 27.39 feet to a point in the centerline of the Foltz Ditch;

Thence N.09°14'32"E. along the centerline of the Foltz Ditch, a distance of 131.69 feet to a point;

Thence N.11°51'41"E. along the centerline of the Foltz Ditch, a distance of 63.56 feet to a point;

Thence S.01°08'12"W., a distance of 234.07 feet to a Mag Nail (set), passing thru an iron pin (set) in the North right-of-way line of State Route 197;

Thence N.67°33'19"W. along the centerline of State Route 197, a distance of 43.77 feet to the Mag Nail, which was the true PLACE OF BEGINNING.

Containing in all 0.099 Acres of which 0.026 Acre is road right-of-way. The above described tract of land is subject to all legal easements, restrictions and reservations, if any, of record or in use on said premises. Previous deed reference: Volume OR 548, Page 1520. This plat is recorded in Survey Book "S", Page 453, in the Auglaize County Engineer's Office. Basis for bearings for this tract is holding the South line of the Northeast Quarter of Section 5, Logan Township as N.89°23'56"W. per the Auglaize County Global Positioning Survey. This plat and description was prepared from an actual field survey of the above premises by John W. Jauert, P.S. in June 2016.

ATTEST:

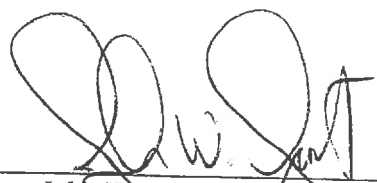
  
\_\_\_\_\_  
John W. Jauert  
Professional Surveyor No. 6920

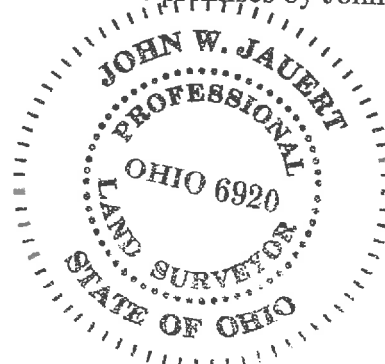

- John Jauert
- 11584 Monroe Road
- Wapakoneta, Ohio 45895



- Phone: (419) 657-6999
- FAX: (419) 657-2745
- E-Mail: [jjsurvey@ohiolink.net](mailto:jjsurvey@ohiolink.net)

## RUSS BOWSHER COMBINED SURVEY 18.434 ACRE

The following described tract of land is part of the Northwest Quarter of Section 5, Town 5 South, Range 5 East, Logan Township, Auglaize County, Ohio, being part of Parcels No. F19-005-003-00, F19-005-002-00 & F19-005-005-04 and is more particularly described as follows:

Commencing at a Monument Box (found) at the Northwest Corner of the Northwest Quarter of Section 5, Logan Township and in the centerline of County Road 81 (Eisley Road);

Thence S.00°45'53"W. along the West line of the Northwest Quarter of said Section 5, a distance of 1,399.00 feet to a Mag Nail (set) which is the PLACE OF BEGINNING for the tract of land herein described;

Thence S.89°28'26"E. a distance of 1,195.83 feet to a point in the centerline of the Foltz Ditch, passing thru an iron pin (set) at 25.00 feet in the East right-of-way line of County Road 81 and passing thru an iron pin (set) for reference at 1,170.83 feet;

Thence S.24°54'59"W. along the centerline of the Foltz Ditch, a distance of 22.08 feet to a point;

Thence S.41°17'05"W. along the centerline of the Foltz Ditch, a distance of 95.99 feet to a point;

Thence S.34°03'17"W. along the centerline of the Foltz Ditch, a distance of 82.51 feet to a point;

Thence S.11°51'41"W. along the centerline of the Foltz Ditch, a distance of 589.14 feet to a point;

Thence S.11°51'41"W. along the centerline of the Foltz Ditch, a distance of 63.56 feet to a point;

Thence S.09°14'32"W. along the centerline of the Foltz Ditch, a distance of 131.69 feet to a point;

Thence S.23°24'13"W. along the centerline of the Foltz Ditch, a distance of 27.39 feet to a Mag Nail (set);

Thence N.67°33'19"W. along the centerline of State Route 197, a distance of 799.18 feet to a Monument Box (found) at the P.I. of a curve to the right;

Thence N.51°29'14"W. along the centerline of State Route 197, a distance of 228.77 feet to a Mag Nail (found);

Thence N.00°45'53"E. along the centerline of County Road 81, a distance of 517.71 feet to the Mag Nail, which was the true PLACE OF BEGINNING.

- John Jauert
- 11584 Monroe Road
- Wapakoneta, Ohio 45895.



- Phone: (419) 657-6999
- FAX: (419) 657-2745
- E-Mail: [jjsurvey@ohiolink.net](mailto:jjsurvey@ohiolink.net)

**RUSS BOWSHER COMBINED SURVEY  
18.434 ACRE, (cont.)**

Containing in all 18.434 Acres of which 0.983 Acre is road right-of-way. The above described tract of land is subject to all legal easements, restrictions and reservations, if any, of record or in use on said premises. Previous deed reference: Volume OR 548, page 1520. This plat is recorded in Survey Book "S", Page 453, in the Auglaize County Engineer's Office. Basis for bearings for this tract is holding the South line of the Northeast Quarter of Section 5, Logan Township as N.89°23'56"W. per the Auglaize County Global Positioning Survey. This plat and description was prepared from an actual field survey of the above premises by John W. Jauert, P.S. in June 2016.

ATTEST:

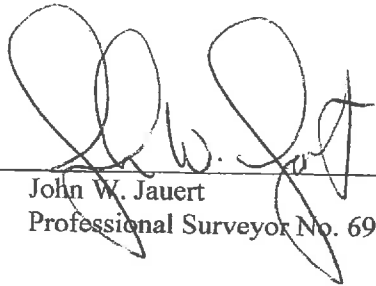
  
John W. Jauert  
Professional Surveyor No. 6920

