

LARRY FISCHBACH SURVEY

Part of the Northeast Quarter of Section 33, & Part of the Northwest Quarter of Section 34, T-5-S, R-5-E, Moulton Township, Auglaize County, Ohio.

LOCATION PLAN

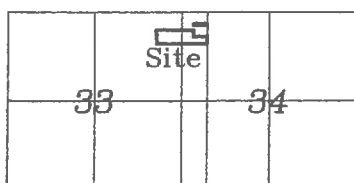

Moulton Township,
T-5-S, R-5-E, Auglaize
County, Ohio.

Basis of Bearing is holding the centerline of Township Road 101 (Bay Road) as S.01°06'54"W. from a previous survey by Lock-Two Surveying dated June 30th, 2005. Survey found recorded in MOU-33-1.

This Plat is Recorded in Survey Book "S",
Page 506, in the Auglaize County Engineer's Office.

L.&T.L. Fischbach Family Trust
G21-033-034-02
Deed: Vol. OR 633,
Page 2382
13.237 Acre
MOU-33-1

L.&T.L. Fischbach Family Trust
G21-034-001-06
Deed: Vol. OR 633,
Page 2382
3.822 Acre
MOU-33-1

N. Line, N.W. 1/4, Sec. 34
N.W. Corner,
N.W. Quarter,
Section 34

L.&T.L. Fischbach Family Trust
G21-034-001-04
Deed: Vol. OR 633,
Page 2382
1.524 Acre
"C"-60

N.89°58'03"E.
295.08'

0.199 ACRE 0.013 AC. R/W

295.00'
N.89°54'42"W.

D.R. Kiefer
G22-034-001-03
Deed: Vol. OR 625,
Page 447
1.63 Acre

295.10'
S.89°54'42"E.

(1.860 Ac. in Sec. 34)

LMN Farm, LLC
G21-033-034-00
Deed: Vol. OR 648,
Page 1438
54.213 Acre
MOU-33-1

L.&T.L. Fischbach Family Trust
G21-033-034-02
Deed: Vol. OR 633,
Page 2382
13.237 Acre
MOU-33-1

LMN Farm, LLC
G21-033-034-00
Deed: Vol. OR 648,
Page 1438
54.213 Acre
MOU-33-1

LMN Farm, LLC
G21-034-001-05
Deed: Vol. OR 648,
Page 1438
11.822 Acre
MOU-33-1

LEGEND

- Iron Pin or Pipe Found
- Iron Pin Set
- ⊗ Mag Nail Set
- Monument Box
- P.K./Mag Nail Found
- ▲ R.R. Spike Found

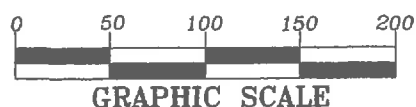

This plat is based on an actual field
survey, performed by me, John W.
Jauert, P.S. in August 2016.

ATTEST:

John W. Jauert
Professional Surveyor No. 6920

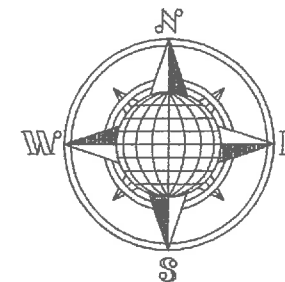
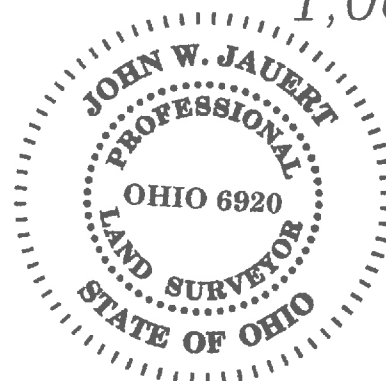

Jauert
surveying

11584 Monroe Road
Wapakoneta, Ohio
45895
(419) 657-6999

CLIENT: Larry Fischbach	
COUNTY: Auglaize	TOWNSHIP: Moulton SEC. 33&34
DRAWN BY: J.W.J.	SCALE: 1"=100' DWG.# 16-4250
CHECKED BY:	DATE: August 2016
SHEET 1 OF 3	(T-5-S; R-5-E)

- John Jauert
- 11584 Monroe Road
- Wapakoneta, Ohio 45895



- Phone: (419) 657-6999
- FAX: (419) 657-2745
- E-Mail: jjsurvey@ohiolink.net

FISCHBACH-LOCHARD SURVEY 6.189 ACRE

The following described tract of land is part of the Northeast Quarter of Section 33 and part of the Northwest Fractional Quarter of Section 34, Town 5 South, Range 5 East, Moulton Township, Auglaize County, Ohio, being part of Parcel No. G21-034-001-06 and Parcel No. G21-033-034-02 and is more particularly described as follows:

Commencing at a Monument Box (found) at the intersection of the centerline of Township Road 101 (Bay Road) with the North line of the Northwest Quarter of Fractional Section 34, Moulton Township;

Thence S.01°06'54"W. along the centerline of Township Road 101 a distance of 719.99 feet to a Mag Nail (found), which is the PLACE OF BEGINNING for the tract of land herein described;

Thence continuing S.01°06'54"W. along the centerline of Township Road 101, a distance of 150.00 feet to a Mag Nail (found);

Thence N.89°54'42"W. a distance of 1,064.14 feet to an iron pin (found), passing thru an iron pin (found) at 44.99 feet in the West right-of-way line of Township Road 101;

Thence N.02°21'13"W. a distance of 290.00 feet to an iron pin (set);

Thence S.89°54'42"E. a distance of 786.64 feet to an iron pin (set);

Thence S.01°08'18"W. a distance of 139.78 feet to an iron pin (found);

Thence S.89°54'42"E. a distance of 295.10 feet to the Mag Nail (found), passing thru an iron pin (set) at 259.83 feet in the West right-of-way line of Township Road 101, said Mag Nail was the true PLACE OF BEGINNING.

Containing in all 6.189 Acres (4.329 Acre in Section 33 and 1.860 Acre in Section 34) of which 0.139 Acre has been used for highway purposes and being subject to all legal easements, restrictions and reservations, if any, of record or in use on said premises. Previous deed reference: Volume OR 633, Page 2382. This plat is recorded in Survey Book "S", Page 506, in the Auglaize County Engineer's Office. Basis for bearings for this tract is holding the centerline of Township Road 101 (Bay Road) as S.01°06'54"W. from a previous survey filed in Survey Book MOU-33-1. This Plat and description was prepared from an actual field survey of the above premises by John W. Jauert, Professional Surveyor No. 6920 in August, 2016.

ATTEST:

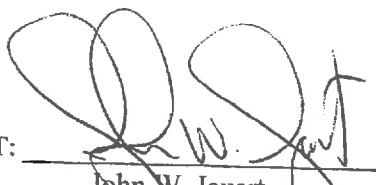
John W. Jauert
Professional Surveyor No. 6920

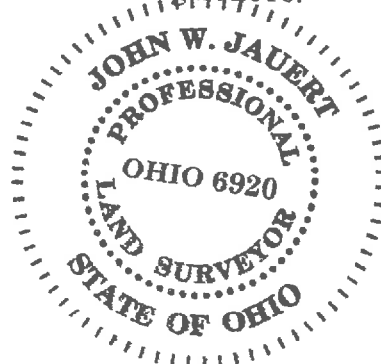

- John Jauert
- 11584 Monroe Road
- Wapakoneta, Ohio 45895



- Phone: (419) 657-6999
- FAX: (419) 657-2745
- E-Mail: jjsurvey@ohiolink.net

FISCHBACH-KIEFER SURVEY 0.199 ACRE

The following described tract of land is part of the Northwest Fractional Quarter of Section 34, Town 5 South, Range 5 East, Moulton Township, Auglaize County, Ohio, being part of Parcel No. G21-034-001-06 and is more particularly described as follows:

Commencing at a Monument Box (found) at the intersection of the centerline of Township Road 101 (Bay Road) with the North line of the Northwest Quarter of Fractional Section 34, Moulton Township;

Thence S.01°06'54"W. along the centerline of Township Road 101 a distance of 450.19 feet to a R.R. Spike (found), which is the PLACE OF BEGINNING for the tract of land herein described;

Thence continuing S.01°06'54"W. along the centerline of Township Road 101, a distance of 29.80 feet to a Mag Nail (found);

Thence N.89°54'42"W. a distance of 295.00 feet to an iron pin (found), passing thru an iron pin (found) at 20.00 feet in the West right-of-way line of Township Road 101;

Thence N.00°59'08"E. a distance of 29.18 feet to an iron pipe (found);

Thence N.89°58'03"E. a distance of 295.08 feet to the R.R. Spike (found), passing thru an iron pin (found) at 275.08 feet in the West right-of-way line of Township Road 101, said R.R. Spike which was the true PLACE OF BEGINNING.

Containing in all 0.199 Acres of which 0.013 Acre has been used for highway purposes and being subject to all legal easements, restrictions and reservations, if any, of record or in use on said premises. Previous deed reference: Volume OR 633, Page 2382. This plat is recorded in Survey Book "S", Page 506, in the Auglaize County Engineer's Office. Basis for bearings for this tract is holding the centerline of Township Road 101 (Bay Road) as S.01°06'54"W. from a previous survey filled in Survey Book MOU-33-1. This Plat and description was prepared from an actual field survey of the above premises by John W. Jauert, Professional Surveyor No. 6920 in August 2016.

ATTEST:

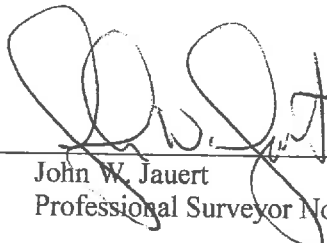
John W. Jauert
Professional Surveyor No. 6920

