

LOCATION PLAN

Section 34

SITE	

N. 89° 29' 12" E.

42.24' S. 53° 01' 38" E. T-
101.99' 41.29'
S. 32° 36' 01"

~~S. 87° 45' 57" E~~
138.89'
58.74'
S. 75° 40' 03" E.

2.684 ACRE

0.139 AC R/W

LEGEND

- | | |
|---|------------------------|
| Ø | Mag Nail Set |
| ● | Mag/P.K. Nail Found |
| ○ | 5/8" Dia. Iron Pin Set |
| ■ | Monument Box Found |



GRAPHIC SCALE

Angle Iron Post
Found 5' West &
1.7' South.

Basis of Bearing is the East line of the Southwest Quarter of Section 34 and the centerline of Township Road 285 as N.00°24'48"E. from the Ohio State Plane-North Coordinate System NAD83 (2011).

D12-034-003-00
D. & A. Sutherland
Deed Vol. OR 564,
Page 2651
18.00 Acre

This Plat is Recorded in Survey Book "S", Page 554 in the Auglaize County Engineer's Office.

Leaving $3.146 \pm$ Acre left out
of the original 5.83 Acre tract.

S.E. Corner,
-S.W. Quarter,
Section 34

Jauert surveying

11584 Monroe Road
Wapakoneta, Ohio
45895
(419) 657-6999

CLIENT: Larry Williams

COUNTY: Auglaize TOWNSHIP: Goshen SEC. 34

DRAWN BY: J.W.J. SCALE: 1"=75' DWG.# 16-4255

CHECKED BY: DATE: September 2016

SHEET 1 OF 2

(T-5 -S; R-8 -E)

ATTEST:

John W. Jauert
Professional Surveyor No. 6920

S-554

- John Jauert
- 11584 Monroe Road
- Wapakoneta, Ohio 45895



- Phone: (419) 657-6999
- FAX: (419) 657-2745
- E-Mail: jjsurvey@ohiolink.net

LARRY WILLIAMS SURVEY 2.684 ACRE

The following described tract of land is part of the Southwest Quarter of Section 34, Town 5 South, Range 8 East, Goshen Township, Auglaize County, Ohio, being part of Parcel No. D12-034-010-02 and is more particularly described as follows:

Commencing at a Mag Nail (found) at the Southeast corner of the Southwest Quarter of Section 34 and in the intersection of the centerlines of Township Road 285 (Campbell Road) and State Route 385;

Thence N.00°24'48"E. along the centerline of Township Road 285 and the East line of the Southwest Quarter of said Section 34 a distance of 1,148.98 feet to a Mag Nail (set), which is the PLACE OF BEGINNING for the tract of land herein described;

Thence N.89°10'48"W. a distance of 342.50 feet to an iron pin (set), passing thru an iron pin (set) for reference at 20.00 feet in the West right-of-way line of Township Road 285;

Thence N.00°24'48"E. , parallel to the centerline of Township Road 285 and the East line of the Southwest Quarter of said Section 34, a distance of 414.25 feet to an iron pin (set);

Thence N.89°29'12"E. a distance of 42.24 feet to an iron pin (set);

Thence S.53°01'38"E. a distance of 101.99 feet to an iron pin (set);

Thence S.32°36'07"E. a distance of 41.29 feet to an iron pin (set);

Thence S.75°40'03"E. a distance of 58.74 feet to an iron pin (set);

Thence S.87°45'57"E. a distance of 138.89 feet to a Mag Nail (set), passing thru an iron pin (set) for reference at 118.89 feet in the West right-of-way line of Township Road 285;

Thence S.00°24'48"W., along the centerline of Township Road 285, a distance of 303.45 feet to the Mag Nail which was the true PLACE OF BEGINNING.

Containing in all 2.684 Acres of which 0.139 Acre has been used for highway purposes and being subject to all legal easements, restrictions and reservations, if any, of record or in use on said premises. Previous deed reference: Volume 223, Page 303. This plat is recorded in Survey Book "S", Page 554, in the Auglaize County Engineer's Office. Basis for bearings for this tract is holding the centerline of Township Road 285 and the East line of the Southwest Quarter of Section 34, Goshen Township as N.00°24'48"E. per the Ohio State Plane-North Coordinate System NAD83 (2011). This Plat and description was prepared from an actual field survey of the above premises by John W. Jauert, Professional Surveyor No. 6920 in September of 2016.

ATTEST:

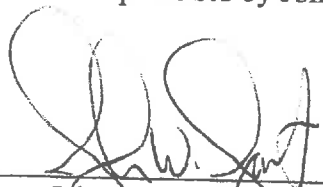
John W. Jauert
Professional Surveyor No. 6920

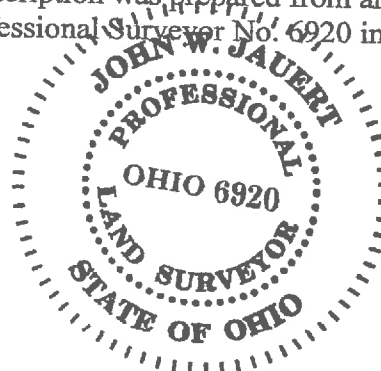

S-555