

DAN KAECK SURVEY

Being the part of the Northeast and Southeast Quarters of
Section 16, T-6-S, R-6-E, Pusheta Township, Auglaize County, Ohio.

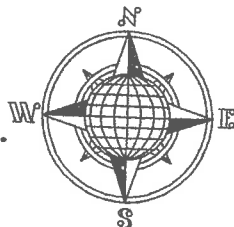

€ Township Road 120 (Pusheta Road)

N.W. Corner,
N.E. Quarter,
Section 16

125-016-001-01
J.P. & J.L. & J.J. Zwiebel
Deed Volume:
OR 582/1894 & 582/2326
Survey Book Q, Page 323
Survey PUS-16-1 & 16-2

17.389 ACRES
0.630 AC. L/A R/W (I-75)

R/W Sta.
143+00, 125' Lt.

S.89°10'48"E.
1,323.97'

N.86°17'03"W.
577.51'

R/W Sta.
138+00, 125' Lt.

S.02°39'00"W.
597.32'

S.89°16'29"W.
240.55'

N.00°45'41"E.
12.00'

S.89°09'12"W.
501.42'

Stone Found at the
Center of Section
16, Pusheta Township

52.590 ACRES
13.352 AC. Total R/W
(39.341 AC. S.E. Quarter)

€ Data for
25' Easement

128.11'

© N.07°07'48"W.

105.36'

ⓑ N.17°48'13"W.

159.08'

Ⓐ N.14°12'49"W.

705.30'

N.00°45'41"E.

705.30'

N.00°36'05"E.

563.00'

N.00°45'41"E.

705.30'

N.00°36'05"E.

563.00'

N.00°45'41"E.

705.30'

N.00°36'05"E.

563.00'

N.00°45'41"E.

705.30'

N.00°36'05"E.

563.00'

N.00°45'41"E.

705.30'

N.00°36'05"E.

563.00'

N.00°45'41"E.

705.30'

N.00°36'05"E.

563.00'

N.00°45'41"E.

705.30'

N.00°36'05"E.

563.00'

N.00°45'41"E.

705.30'

N.00°36'05"E.

563.00'

N.00°45'41"E.

705.30'

N.00°36'05"E.

563.00'

N.00°45'41"E.

705.30'

N.00°36'05"E.

563.00'

N.00°45'41"E.

705.30'

N.00°36'05"E.

563.00'

N.00°45'41"E.

705.30'

N.00°36'05"E.

563.00'

N.00°45'41"E.

705.30'

N.00°36'05"E.

563.00'

N.00°45'41"E.

705.30'

N.00°36'05"E.

563.00'

N.00°45'41"E.

705.30'

N.00°36'05"E.

563.00'

N.00°45'41"E.

705.30'

N.00°36'05"E.

563.00'

N.00°45'41"E.

705.30'

N.00°36'05"E.

563.00'

N.00°45'41"E.

705.30'

N.00°36'05"E.

563.00'

N.00°45'41"E.

705.30'

N.00°36'05"E.

563.00'

N.00°45'41"E.

705.30'

N.00°36'05"E.

563.00'

N.00°45'41"E.

705.30'

N.00°36'05"E.

563.00'

N.00°45'41"E.

705.30'

N.00°36'05"E.

563.00'

N.00°45'41"E.

705.30'

N.00°36'05"E.

563.00'

N.00°45'41"E.

705.30'

N.00°36'05"E.

563.00'

N.00°45'41"E.

705.30'

N.00°36'05"E.

563.00'

N.00°45'41"E.

705.30'

N.00°36'05"E.

563.00'

N.00°45'41"E.

705.30'

N.00°36'05"E.

563.00'

N.00°45'41"E.

705.30'

N.00°36'05"E.

563.00'

N.00°45'41"E.

705.30'

N.00°36'05"E.

563.00'

N.00°45'41"E.

705.30'

N.00°36'05"E.

563.00'

N.00°45'41"E.

705.30'

N.00°36'05"E.

563.00'

N.00°45'41"E.

705.30'

N.00°36'05"E.

563.00'

N.00°45'41"E.

705.30'

N.00°36'05"E.

563.00'

N.00°45'41"E.

705.30'

N.00°36'05"E.

563.00'

N.00°45'41"E.

705.30'

N.00°36'05"E.

563.00'

N.00°45'41"E.

705.30'

N.00°36'05"E.

563.00'

N.00°45'41"E.

705.30'

N.00°36'05"E.

563.00'

N.00°45'41"E.

705.30'

N.00°36'05"E.

563.00'

N.00°45'41"E.

705.30'

N.00°36'05"E.

563.00'

N.00°45'41"E.

705.30'

N.00°36'05"E.

563.00'

N.00°45'41"E.

705.30'

N.00°36'05"E.

563.00'

N.00°45'41"E.

705.30'

N.00°36'05"E.

563.00'

N.00°45'41"E.

705.30'

N.00°36'05"E.

563.00'

N.00°45'41"E.

705.30'

N.00°36'05"E.

563.00'

N.00°45'41"E.

705.30'

N.00°36'05"E.

563.00'

N.00°45'41"E.

705.30'

N.00°36'05"E.

563.00'

N.00°45'41"E.

705.30'

N.00°36'05"E.

563.00'

N.00°45'41"E.

705.30'

N.00°36'05"E.

563.00'

N.00°45'41"E.

705.30'

N.00°36'05"E.

563.00'

N.00°45'41"E.

705.30'

N.00°36'05"E.

563.00'

N.00°45'41"E.

705.30'

N.00°36'05"E.

563.00'

N.00°45'41"E.

705.30'

N.00°36'05"E.

563.00'

N.00°45'41"E.

705.30'

N.00°36'05"E.

563.00'

N.00°45'41"E.

705.30'

N.00°36'05"E.

563.00'

N.00°45'41"E.

705.30'

N.00°36'05"E.

563.00'

N.00°45'41"E.

705.30'

N.00°36'05"E.

563.00'

N.00°45'41"E.

705.30'

N.00°36'05"E.

563.00'

N.00°45'41"E.

705.30'

N.00°36'05"E.

563.00'

N.00°45'41"E.

705.30'

N.00°36'05"E.

563.00'

N.00°45'41"E.

705.30'

N.00°36'05"E.

563.00'

N.00°45'41"E.

705.30'

N.00°36'05"E.

563.00'

N.00°45'41"E.

705.30'

N.00°36'05"E.

563.00'

N.00°45'41"E.

705.30'

N.00°36'05"E.

563.00'

N.00°45'41"E.

705.30'

N.00°36'05"E.

563.00'

N.00°45'41"E.

705.30'

N.00°36'05"E.

- John Jauert
- 11584 Monroe Road
- Wapakoneta, Ohio 45895



- Phone: (419) 657-6999
- FAX: (419) 657-2745
- E-Mail: jjsurvey@ohiolink.net

DAN KAECK SURVEY 5.011 ACRE

The following described tract of land is part of the Southeast Quarter of Section 16, Town 6 South, Range 6 East, Pusheta Township, Auglaize County, Ohio, being part of Parcel No. I25-016-006-00 and is more particularly described as follows:

Commencing at a Monument Box (found) at the Southwest Corner of the Southeast Quarter of Section 16, Pusheta Township and in the centerline of Township Road 110 (Fryburg Drive);

Thence S.89°05'42"E. along the South line of the Southeast Quarter of said Section 16, a distance of 831.28 feet to a Mag Nail (set) which is the PLACE OF BEGINNING for the tract of land herein described;

Thence N.00°35'54"E., along a line in a 50.00 foot Ingress-Egress easement, a distance of 1,107.57 feet to a point;

Thence N.01°06'17"E. a distance of 522.45 feet to an iron pin (set);

Thence N.06°04'35"W. a distance of 100.00 feet to a point in a concrete bridge;

Thence N.01°06'17"E. a distance of 47.06 feet to an iron pin (set);

Thence N.14°12'49"W. a distance of 58.95 feet to an iron pin (set);

Thence S.82°28'58"W. a distance of 78.13 feet to an iron pin (set);

Thence N.15°50'51"W. a distance of 94.38 feet to an iron pin (set);

Thence S.82°28'58"W. a distance of 325.19 feet to an iron pin (set);

Thence N.14°48'50"W. a distance of 130.50 feet to an iron pin (found);

Thence N.01°29'28"E. a distance of 200.96 feet to an iron pin (set);

Thence N.87°24'54"E. a distance of 573.23 feet to a an iron pin (set);

Thence S.00°27'53"W. a distance of 375.67 feet to an iron pin (set);

Thence S.82°28'58"W. a distance of 91.65 feet to an iron pin (set);

Thence S.13°25'16"E. a distance of 62.54 feet to an iron pin (set);

Thence S.01°06'17"W. along the East line of a 50.00 foot Ingress-Egress Easement, a distance of 668.85 feet to a point;

Thence S.00°35'54"W. along the east line of a 50.00 foot Ingress-Egress Easement, a distance of 1,107.50 feet to a Mag Nail (set), passing thru an iron pin set for reference at 1,040.51 feet in the North right-of-way line of Township Road 110;

Thence N.89°05'42"W., along the centerline of Township Road 110, a distance of 12.50 feet to the Mag Nail (set), which was the true PLACE OF BEGINNING.

- John Jauert
- 11584 Monroe Road
- Wapakoneta, Ohio 45895



- Phone: (419) 657-6999
- FAX: (419) 657-2745
- E-Mail: jjsurvey@ohiolink.net

DAN KAECK SURVEY 5.011 ACRE, (cont.)

Containing in all 5.011 Acres of which 0.019 Acre is road right-of-way. The above described tract of land is subject to all legal easements, restrictions and reservations, if any, of record or in use on said premises. Previous deed reference: Volume OR 575, page 56 and OR 579, page 2335. This plat is recorded in Survey Book "S", Page 622, in the Auglaize County Engineer's Office. Basis for bearings for this tract is holding the South line of the Southeast Quarter of Section 16, Pusheta Township and the centerline of Township Road 110 as S.89°05'42"E. per the Auglaize County Global Positioning Survey. This plat and description was prepared from an actual field survey of the above premises by John W. Jauert, P.S. in December 2016.

Subject to an easement for Ingress-Egress, 25 feet in width as described as follows:

Commencing at a Monument Box (found) at the Southwest Corner of the Southeast Quarter of Section 16, Pusheta Township and in the centerline of Township Road 110 (Fryburg Drive);

Thence S.89°05'42"E. along the South line of the Southeast Quarter of said Section 16, a distance of 831.28 feet to a Mag Nail (set);

Thence N.00°35'54"E., along a line in a 50.00 foot Ingress-Egress easement, a distance of 1,107.57 feet to an iron pin (set);

Thence N.01°06'17"E. a distance of 522.45 feet to an iron pin (set);

Thence N.06°04'35"W. a distance of 100.00 feet to a point in a concrete bridge;

Thence N.01°06'17"W. a distance of 47.06 feet to an iron pin (set);

Thence N.14°12'49"W. a distance of 58.95 feet to an iron pin (set), which is the PLACE OF BEGINNING for the centerline of an easement, 25 feet in width and located parallel and adjacent of the following described courses;

Thence N.14°12'49"W. a distance of 159.08 feet to a point;

Thence N.17°48'13"W. a distance of 105.36 feet to a point;

Thence N.07°07'48"W. a distance of 128.11 feet to an iron pin (set) and there to terminate.

ATTEST: _____

John W. Jauert
Professional Surveyor No. 6920



- John Jauert
- 11584 Monroe Road
- Wapakoneta, Ohio 45895.



- Phone: (419) 657-6999
- FAX: (419) 657-2745
- E-Mail: jjsurvey@ohiolink.net

DAN KAECK SURVEY 6.381 ACRE

The following described tract of land is part of the Southeast Quarter of Section 16, Town 6 South, Range 6 East, Pusheta Township, Auglaize County, Ohio, being part of Parcel No. I25-016-006-00 and is more particularly described as follows:

Commencing at a Monument Box (found) at the Southwest Corner of the Southeast Quarter of Section 16, Pusheta Township and in the centerline of Township Road 110 (Fryburg Drive);

Thence S.89°05'42"E. along the South line of the Southeast Quarter of said Section 16, a distance of 818.78 feet to a Mag Nail (set) which is the PLACE OF BEGINNING for the tract of land herein described;

Thence N.00°35'54"E., along the centerline of a 50.00 foot Ingress-Egress easement, a distance of 1,107.50 feet to an iron pin (found);

Thence N.89°26'14"W. a distance of 225.74 feet to an iron pin (found);

Thence N.14°48'50"W. a distance of 787.86 feet to an iron pin (set);

Thence N.82°28'58"E. a distance of 325.19 feet to an iron pin (set);

Thence S.15°50'51"E. a distance of 94.38 feet to an iron pin (set);

Thence N.82°28'58"E. a distance of 78.13 feet to an iron pin (set);

Thence S.14°12'49"E. a distance of 58.95 feet to an iron pin (set);

Thence S.01°06'17"W. a distance of 47.06 feet to a point in the center of a concrete bridge;

Thence S.06°04'35"E. a distance of 100.00 feet to an iron pin (set);

Thence S.01°06'17"W. a distance of 522.45 feet to a point;

Thence S.00°35'54"W. a distance of 1,107.57 feet to a Mag Nail (set), passing thru an iron pin set for reference at 1,041.48 feet in the North right-of-way line of Township Road 110;

Thence N.89°05'42"W., along the centerline of Township Road 110, a distance of 12.50 feet to the Mag Nail (set), which was the true PLACE OF BEGINNING.

- John Jauert
- 11584 Monroe Road
- Wapakoneta, Ohio 45895.



- Phone: (419) 657-6999
- FAX: (419) 657-2745
- E-Mail: jjsurvey@ohiolink.net

DAN KAECK SURVEY
6.381 ACRE, (cont.)

Containing in all 6.381 Acres of which 0.019 Acre is road right-of-way. The above described tract of land is subject to all legal easements, restrictions and reservations, if any, of record or in use on said premises. Previous deed reference: Volume OR 575, page 56 and OR 579, page 2335. This plat is recorded in Survey Book "S", Page 622, in the Auglaize County Engineer's Office. Basis for bearings for this tract is holding the South line of the Southeast Quarter of Section 16, Pusheta Township and the centerline of Township Road 110 as S.89°05'42"E. per the Auglaize County Global Positioning Survey. This plat and description was prepared from an actual field survey of the above premises by John W. Jauert, P.S. in December 2016.

ATTEST:

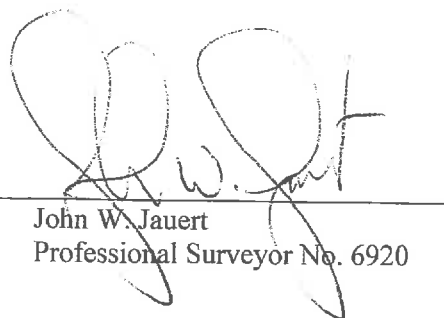
 John W. Jauert
 Professional Surveyor No. 6920



- John Jauert
- 11584 Monroe Road
- Wapakoneta, Ohio 45895



- Phone: (419) 657-6999
- FAX: (419) 657-2745
- E-Mail: jjsurvey@ohiolink.net

DAN KAECK DESCRIPTION 17.389 ACRE

The following described tract of land is part of the Northeast Quarter of Section 16, Town 6 South, Range 6 East, Pusheta Township, Auglaize County, Ohio, being part of Parcel Number I25-016-006-00 and is more particularly described as follows:

Commencing at a Monument Box found at the Northwest corner of the Northeast Quarter of Section 16, Pusheta Township and in the centerline of Township Road 120 (Pusheta Road);

Thence S.00°51'54"W. along the West line of the Northeast Quarter of Section 16 a distance of 1,664.96 feet to an iron pin (found), which is the PLACE OF BEGINNING for the tract of land herein described;

Thence S.89°10'48"E. a distance of 1,323.97 feet to a point, passing thru an iron pin (found) at 1,157.30 feet in the West Limited Access right-of-way line of Interstate 75;

Thence S.00°43'25"W. a distance of 169.24 feet to a point;

Thence N.86°17'03"W. a distance of 577.51 feet to an iron pin (set), passing thru an iron pin (set) at 166.16 feet in the West Limited Access right-of-way line of Interstate 75;

Thence S.02°39'00"W. a distance of 537.32 feet to an iron pin (set);

Thence S.89°16'29"W. a distance of 240.55 feet to an iron pin (set);

Thence S.01°04'08"E. a distance of 320.71 feet to an iron pin (set);

Thence S.89°09'12"W. a distance of 501.42 feet to an iron pin (set);

Thence N.00°45'41"E. a distance of 12.00 feet to a stone (found) at the center Section 16;

Thence N.00°51'54"E. along the West line of the Northeast Quarter of Section 16, a distance of 1,006.74 feet to the iron pin, which was the true PLACE OF BEGINNING.

Containing in all 17.389 Acre of which 0.630 Acre is subject to Limited Access right-of-way of Interstate 75. The above-described tract of land is subject to all legal easements, restrictions and reservations, if any, of record or in use on said premises. Previous deed reference: Volume OR 575, page 56 and OR 579, page 2335. This plat is recorded in Survey Book "S", page 622, in the Auglaize County Engineer's Office. Basis of bearing is the South line of the Southeast Quarter of Section 16 and the centerline of Township Road 110 as S.89°05'42"E. from the Auglaize County Global Positioning Survey. This description is based on an actual field survey, performed by John W. Jauert in December 2016.

ATTEST:

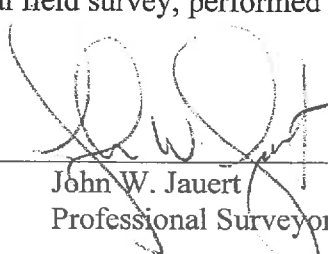
John W. Jauert
Professional Surveyor No. 6920

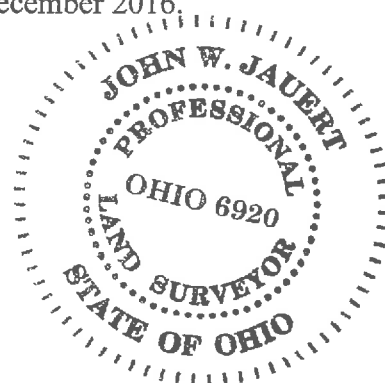

- John Jauert
- 11584 Monroe Road
- Wapakoneta, Ohio 45895



- Phone: (419) 657-6999
- FAX: (419) 657-2745
- E-Mail: jjsurvey@ohiolink.net

DAN KAECK SURVEY 52.590 ACRE

The following described tract of land is part of the Northeast and Southeast Quarters of Section 16, Town 6 South, Range 6 East, Pusheta Township, Auglaize County, Ohio, being part of Parcel No. I25-016-006-00 and is more particularly described as follows:

Commencing at a Monument Box (found) at the Southwest Corner of the Southeast Quarter of Section 16, Pusheta Township and in the centerline of Township Road 110 (Fryburg Drive);

Thence S.89°05'42"E. along the South line of the Southeast Quarter of said Section 16, a distance of 843.78 feet to a Mag Nail (set) which is the PLACE OF BEGINNING for the tract of land herein described;

Thence N.00°35'54"E., along the East side of a 50.00 foot Ingress-Egress easement, a distance of 1,107.50 feet to an iron pin (set);

Thence N.01°06'17"E., along the East side of a 50.00 foot Ingress-Egress easement, a distance of 668.85 feet to an iron pin (set);

Thence N.13°25'16"W. a distance of 62.54 feet to an iron pin (set);

Thence N.82°28'58"E. a distance of 91.65 feet to an iron pin (set);

Thence N.00°27'53"E. a distance of 375.67 feet to an iron pin (set);

Thence S.87°24'54"W. a distance of 573.23 feet to an iron pin (set), passing thru an iron pin (set) for reference at 206.26 feet;

Thence S.01°29'28"W. a distance of 200.96 feet to an iron pin (found);

Thence S.80°57'54"W. a distance of 348.33 feet to an iron pin (found);

Thence N.00°45'41"E. a distance of 705.30 feet to an iron pin (set);

Thence N.89°09'12"E. a distance of 501.42 feet to an iron pin (set);

Thence N.01°04'08"W. a distance of 320.71 feet to an iron pin (set);

Thence N.89°16'29"E. a distance of 240.55 feet to an iron pin (set);

Thence N.02°39'00"E. a distance of 537.32 feet to an iron pin (set);

Thence S.86°17'03"E. a distance of 577.51 feet to a point, passing thru an iron pin (set) for reference at 411.34 feet in the West limited Access Right-of-Way line of Interstate 75;

Thence S.00°43'25"W. along the East line of the Northeast Quarter of Section 16, a distance of 830.62 feet to a point;

- John Jauert
- 11584 Monroe Road
- Wapakoneta, Ohio 45895.



- Phone: (419) 657-6999
- FAX: (419) 657-2745
- E-Mail: jjsurvey@ohiolink.net

DAN KAECK SURVEY 52.590 ACRE, (cont.)

Thence S.00°42'05"W. along the East line of the Southeast Quarter of said Section 16, a distance of 2,656.19 feet to a Mag Nail (set);

Thence N.89°05'42"W., along the centerline of Township Road 110 and the South line of the Southeast Quarter of Section 16, a distance of 485.45 feet to the Mag Nail (set), which was the true PLACE OF BEGINNING.

Containing in all 52.590 Acres of which 13.352 Acre is road right-of-way. 13.249 Acre being in the N.E. Quarter and 39.341 Acre in the S.E Quarter of Section 16. The above described tract of land is subject to all legal easements, restrictions and reservations, if any, of record or in use on said premises. Previous deed reference: Volume OR 575, page 56 and OR 579, page 2335. This plat is recorded in Survey Book "S", Page 622, in the Auglaize County Engineer's Office. Basis for bearings for this tract is holding the South line of the Southeast Quarter of Section 16, Pusheta Township and the centerline of Township Road 110 as S.89°05'42"E. per the Auglaize County Global Positioning Survey. This plat and description was prepared from an actual field survey of the above premises by John W. Jauert, P.S. in December 2016.

2.330 ACRE INGRESS-EGRESS EASEMENT

The following described tract of land is part of the Southeast Quarter of Section 16, Town 6 South, Range 6 East, Pusheta Township, Auglaize County, Ohio, being part of Parcel No's. I25-016-006-00, I25-016-006-01 and is more particularly described as follows:

Commencing at a Monument Box (found) at the Southwest Corner of the Southeast Quarter of Section 16, Pusheta Township and in the centerline of Township Road 110 (Fryburg Drive);

Thence S.89°05'42"E. along the South line of the Southeast Quarter of said Section 16, a distance of 793.78 feet to a Mag Nail (set) which is the PLACE OF BEGINNING for the tract of land herein described;

Thence N.00°35'54"E., along the West line of a 50.00 foot Ingress-Egress easement, a distance of 1,107.50 feet to a point;

Thence N.01°06'17"E. a distance of 668.85 feet to a point;

Thence N.15°06'31"W. a distance of 55.39 feet to a point;

Thence N.82°28'58"E. a distance of 12.59 feet to a point;

Thence N.14°12'49"W. a distance of 157.22 feet to a point;

- John Jauert
- 11584 Monroe Road
- Wapakoneta, Ohio 45895



- Phone: (419) 657-6999
- FAX: (419) 657-2745
- E-Mail: jjsurvey@ohiolink.net

DAN KAECK SURVEY 2.330 ACRE, (cont.)

Thence N.17°48'13"W. a distance of 106.13 feet to a point;
 Thence N.07°07'48"W. a distance of 130.27 feet to a point;
 Thence N.87°24'54"E. a distance of 12.54 feet to an iron pin (set);
 Thence N.87°24'54"E. a distance of 12.54 feet to a point;
 Thence S.07°07'48"E. a distance of 125.95 feet to a point;
 Thence S.17°48'13"E. a distance of 104.58 feet to a point;
 Thence S.14°12'49"E. a distance of 160.94 feet to a point;
 Thence N.82°28'58"E. a distance of 12.59 feet to an iron pin (set);
 Thence S.13°25'16"E. a distance of 62.43 feet to an iron pin (set);
 Thence S.01°06'17"W. a distance of 668.85 feet to a point;
 Thence S.00°35'54"W a distance of 1,107.50 feet to a Mag Nail (set) in the centerline of Township Road 110;
 Thence N.89°05'42"W., along the centerline of Township Road 110, a distance of 50.00 feet to the Mag Nail (set), which was the true PLACE OF BEGINNING.

Containing in all 2.330 Acres of which 0.023 Acre is road right-of-way. The above described tract of land is subject to all legal easements, restrictions and reservations, if any, of record or in use on said premises. Previous deed reference: Volume OR 575, page 56, OR 579, page 2335 and OR 343, page 378. This plat is recorded in Survey Book "S", Page 622, in the Auglaize County Engineer's Office. Basis for bearings for this tract is holding the South line of the Southeast Quarter of Section 16, Pusheta Township and the centerline of Township Road 110 as S.89°05'42"E. per the Auglaize County Global Positioning Survey. This plat and description was prepared from an actual field survey of the above premises by John W. Jauert, P.S. in December 2016.

ATTEST:

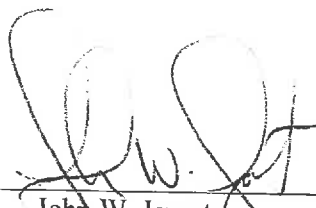
 John W. Jauert
 Professional Surveyor No. 6920



- John Jauert
- 11584 Monroe Road
- Wapakoneta, Ohio 45895



- Phone: (419) 657-6999
- FAX: (419) 657-2745
- E-Mail: jjsurvey@ohiolink.net

DAN KAECK SURVEY 2.330 ACRE INGRESS-EGRESS EASEMENT

The following described tract of land is part of the Southeast Quarter of Section 16, Town 6 South, Range 6 East, Pusheta Township, Auglaize County, Ohio, being part of Parcel No's. I25-016-006-00, I25-016-006-01 and is more particularly described as follows:

Commencing at a Monument Box (found) at the Southwest Corner of the Southeast Quarter of Section 16, Pusheta Township and in the centerline of Township Road 110 (Fryburg Drive);

Thence S.89°05'42"E. along the South line of the Southeast Quarter of said Section 16, a distance of 793.78 feet to a Mag Nail (set) which is the PLACE OF BEGINNING for the tract of land herein described;

Thence N.00°35'54"E., along the West line of a 50.00 foot Ingress-Egress easement, a distance of 1,107.50 feet to a point;

Thence N.01°06'17"E. a distance of 668.85 feet to a point;

Thence N.15°06'31"W. a distance of 55.39 feet to a point;

Thence N.82°28'58"E. a distance of 12.59 feet to a point;

Thence N.14°12'49"W. a distance of 157.22 feet to a point;

Thence N.17°48'13"W. a distance of 106.13 feet to a point;

Thence N.07°07'48"W. a distance of 130.27 feet to a point;

Thence N.87°24'54"E. a distance of 12.54 feet to an iron pin (set);

Thence N.87°24'54"E. a distance of 12.54 feet to a point;

Thence S.07°07'48"E. a distance of 125.95 feet to a point;

Thence S.17°48'13"E. a distance of 104.58 feet to a point;

Thence S.14°12'49"E. a distance of 160.94 feet to a point;

Thence N.82°28'58"E. a distance of 12.59 feet to an iron pin (set);

Thence S.13°25'16"E. a distance of 62.43 feet to an iron pin (set);

Thence S.01°06'17"W. a distance of 668.85 feet to a point;

Thence S.00°35'54"W a distance of 1,107.50 feet to a Mag Nail (set) in the centerline of Township Road 110;

Thence N.89°05'42"W., along the centerline of Township Road 110, a distance of 50.00 feet to the Mag Nail (set), which was the true PLACE OF BEGINNING.

- John Jauert
- 11584 Monroe Road
- Wapakoneta, Ohio 45895



- Phone: (419) 657-6999
- FAX: (419) 657-2745
- E-Mail: jjsurvey@ohiolink.net

DAN KAECK SURVEY
2.330 ACRE INGERSS-EGRESS EASEMENT, (cont.)

Containing in all 2.330 Acres of which 0.023 Acre is road right-of-way. The above described tract of land is subject to all legal easements, restrictions and reservations, if any, of record or in use on said premises. Previous deed reference: Volume OR 575, page 56, OR 579, page 2335 and OR 343, page 378. This plat is recorded in Survey Book "S", Page 622, in the Auglaize County Engineer's Office. Basis for bearings for this tract is holding the South line of the Southeast Quarter of Section 16, Pusheta Township and the centerline of Township Road 110 as S.89°05'42"E. per the Auglaize County Global Positioning Survey. This plat and description was prepared from an actual field survey of the above premises by John W. Jauert, P.S. in December 2016.

ATTEST:

 John W. Jauert
 Professional Surveyor No. 6920

