

# QUINTER SURVEY

Being part of the Southwest Quarter of Section 34, T-7-S, R-4-E, Jackson Township, Auglaize County, Ohio.

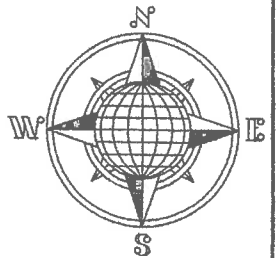

This Plat and the accompanying Legal Description represents an actual Boundary Survey completed John W. Jauert, in February, 2017.

## LOCATION PLAN

Section 34

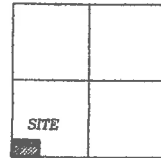

Jackson Township,  
T-7-S, R-4-E, Auglaize  
County, Ohio.

County Road 26 (50' R/W)  
(Minster-Egypt Pike)

Monument Box at the  
N.W. Corner of the  
S.W. Quarter of Section  
34, Jackson Township

Basis of Bearing is the West Line  
of the Southwest Quarter of  
Section 34 as N.01°54'27"E. from  
the Ohio State Plane - North  
Coordinate System NAD-83 (2011).

This Plat is Recorded in Survey  
Book "S", Page 649 in the Auglaize  
County Engineer's Office.

E14-034-004-03  
M. & A. Quinter  
V. OR 607, Pg. 1331  
22.304 Acre  
"H"-179, 616 & "R"-12

S.89°04'56"E.  
995.87'

**3.775 ACRE**

**0.088 AC. R/W**

N.89°04'56"W.  
649.59'

29.21'  
N.01°54'27"E.

E14-034-004-02  
P. & C. Quinter  
V. OR 623, Pg. 841  
13.811 Acre  
"H"-179, 616 & "R"-12

**10.035 ACRE**

**0.258 AC. R/W**

E14-034-005-00  
Quinter Farms LLC  
V. OR 623, Pg. 839  
22.304 Acre  
"R"-12

S.89°04'56"E.  
334.53'

S.01°54'27"W.  
184.21'  
419.64'

N.89°04'56"W.  
346.28'

AUGLAIZE COUNTY

995.89'  
N.89°07'10"W.

SHELBY COUNTY

Monument Box at the  
S.W. Corner of the  
S.W. Quarter of Section  
34, Jackson Township

## LEGEND

- 5/8"x30" Iron Pin Set/Cap
- 5/8" Dia. Iron Pin Found
- Ø Mag Nail Set
- Mag Nail Found
- Monument Box



GRAPHIC SCALE

**Jauert  
surveying**

11584 Monroe Road  
Wapakoneta, Ohio  
45895  
(419) 657-6999

CLIENT: Matt Quinter

COUNTY: Auglaize TOWNSHIP: Jackson SEC. 34

DRAWN BY: J.W.J. SCALE: 1"=180' DWG.# 17-3840A

CHECKED BY: DATE: February 2017

SHEET 1 OF 3

(T-7-S, R-4-E)

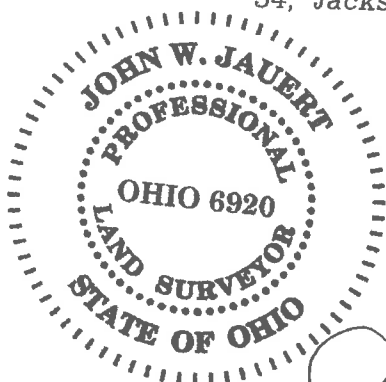

ATTEST:

John W. Jauert  
Professional Surveyor No. 6920

- John Jauert
- 11584 Monroe Road
- Wapakoneta, Ohio 45895.



- Phone: (419) 657-6999
- FAX: (419) 657-2745
- E-Mail: jjsurvey@ohiolink.net

## MATTHEW QUINTER SURVEY 3.775 ACRE

The following described tract of land is part of the Southwest Quarter of Section 34, Town 7 South, Range 4 East, Jackson Township, Auglaize County, Ohio, being part of Parcel No. E14-034-004-02 and is more particularly described as follows:

Commencing at a Monument Box (found) at the Southwest corner of the Southwest Quarter of Section 34, Jackson Township and in the centerline of County Road 41 (Eiting Road);  
Thence N.01°54'27"E. along the centerline of County Road 41 and the West line of the Southwest Quarter of said Section 34 a distance of 449.49 feet to a Mag Nail (set), which is the PLACE OF BEGINNING for the tract of land herein described;

Thence continuing N.01°54'27"E. along the West line of the Southwest Quarter of Section 34, a distance of 155.00 feet to a Mag Nail (found);

Thence S.89°04'56"E. a distance of 995.87 feet to an iron pin (found), passing thru an iron pin (found) at 25.00 feet in the East right-of-way line of County Road 41;

Thence S.01°54'27"W. , parallel to the centerline of County Road 41 and the West line of the Southwest Quarter of said Section 34, a distance of 184.21 feet to an iron pin (set);

Thence N.89°04'56"W. a distance of 346.28 feet to an iron pin (set);

Thence N.01°54'27"E. , parallel to the centerline of County Road 41 and the West line of the Southwest Quarter of said Section 34, a distance of 29.21 feet to an iron pin (set);

Thence N.89°04'56"W. a distance of 649.59 feet to a Mag Nail (set), passing thru an iron pin (set) for reference at 624.59 feet in the East right-of-way line of County Road 41, said Mag Nail was the true PLACE OF BEGINNING.

Containing in all 3.775 Acres of which 0.088 Acre has been used for highway purposes and being subject to all legal easements, restrictions and reservations, if any, of record or in use on said premises. Previous deed reference: Volume OR 623, Page 841. This plat is recorded in Survey Book "S", Page 649, in the Auglaize County Engineer's Office. Basis for bearings for this tract is holding the centerline of County Road 41 and the West line of the Southwest Quarter of Section 34, Jackson Township as N.01°54'27"W. from the Ohio State Plane-North Coordinate System NAD83 (2011). This Plat and description was prepared from an actual field survey of the above premises by John W. Jauert, Professional Surveyor No. 6920 in February 2017.

ATTEST:

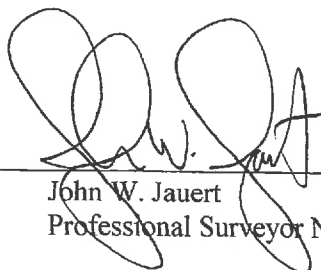
  
John W. Jauert  
Professional Surveyor No. 6920

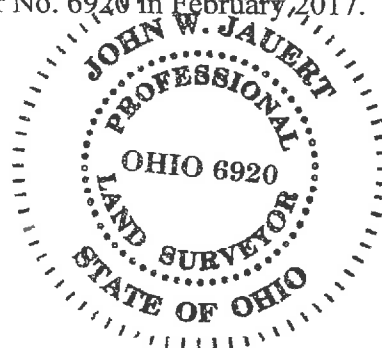

- John Jauert
- 11584 Monroe Road
- Wapakoneta, Ohio 45895



- Phone: (419) 657-6999
- FAX: (419) 657-2745
- E-Mail: jjsurvey@ohiolink.net

## PAUL QUINTER SURVEY 10.035 ACRE

The following described tract of land is part of the Southwest Quarter of Section 34, Town 7 South, Range 4 East, Jackson Township, Auglaize County, Ohio, being part of Parcel No. E14-034-004-02 and is more particularly described as follows:

The PLACE OF BEGINNING is at a Monument Box (found) at the Southwest corner of the Southwest Quarter of Section 34, Jackson Township and in the centerline of County Road 41 (Eiting Road);

Thence N.01°54'27"E. along the centerline of County Road 41 and the West line of the Southwest Quarter of said Section 34 a distance of 449.49 feet to a Mag Nail (set);

Thence S.89°04'56"E. a distance of 649.59 feet to an iron pin (set), passing thru an iron pin (set) at 25.00 feet in the East right-of-way line of County Road 41;

Thence S.01°54'27"W. , parallel to the centerline of County Road 41 and the West line of the Southwest Quarter of said Section 34, a distance of 29.21 feet to an iron pin (set);

Thence S.89°04'56"E. a distance of 346.28 feet to an iron pin (set);

Thence S.01°54'27"W. , parallel to the centerline of County Road 41 and the West line of the Southwest Quarter of said Section 34, a distance of 419.64 feet to an iron pin (found);

Thence N.89°07'10"W. along the South line of the Southwest Quarter of Section 34, a distance of 995.89 feet to the Monument Box which was the true PLACE OF BEGINNING.

Containing in all 10.035 Acres of which 0.258 Acre has been used for highway purposes and being subject to all legal easements, restrictions and reservations, if any, of record or in use on said premises. Previous deed reference: Volume OR 623, Page 841. This plat is recorded in Survey Book "S", Page 649, in the Auglaize County Engineer's Office. Basis for bearings for this tract is holding the centerline of County Road 41 and the West line of the Southwest Quarter of Section 34, Jackson Township as N.01°54'27"W. from the Ohio State Plane-North Coordinate System NAD83 (2011). This Plat and description was prepared from an actual field survey of the above premises by John W. Jauert, Professional Surveyor No. 6920 in February 2017.

ATTEST:

John W. Jauert  
Professional Surveyor No. 6920

