

LEGEND

- = IRON BAR IN MON. BOX FOUND.
- = 5/8 INCH IRON BAR FOUND.
- ⌘ = SPINDLE FOUND.
- ⊙ = 5/8 INCH IRON BAR SET.
- ⊗ = MAG NAIL SET.

LOCATION SKETCH

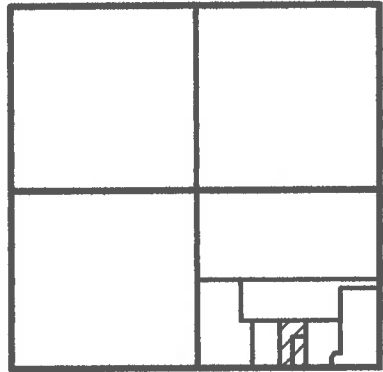

JAMES & KATHLEEN
RIETHMAN
19.964 ACRES
O.R. 456 PG. 428

SECTION 24

NOTES:

- 1) REFER TO BOECKER SURVEY BY J. KENT, P.S.6792, 3-19-02.
- 2) THE S. LINE OF S. 88°31'17" E. IS BASED ON AUG. CO. LOCAL GPS DATUM.

MICHAEL & JANE
HORSTMAN
6.16 ACRES
O.R. 456 PG. 1587

CURTIS & KATHERINE
KREMER
6.16 ACRES
O.R. 616 PG. 2252

B&H FARMS, LLC
7.783 ACRES
O.R. 555 PG. 2437

TRACT ONE
3.953 ACRES
(0.108 AC. IN R/W)

TRACT TWO
2.207 ACRES
(0.103 AC. IN R/W)

PARCEL #
E1402400408

SURVEYED BY

JAMES W. GEESLIN
P.S. No. 7764



S.W. COR. -
S.E. 1/4 -
SEC. 24

25' R/W LINE
1307.57' 188.55' 179.02' 965.30'
S 88°31'17" E 2640.44'
S. LINE - S.E. 1/4 - SEC. 24 & G BENSAN RD. (50' R/W)

S.E. COR. -
SEC. 24

KREMER SURVEY

OF PART OF THE SOUTHEAST QUARTER OF SECTION 24, TOWN 7 SOUTH, RANGE 4 EAST,
(JACKSON TOWNSHIP), AUGLAIZE COUNTY, OHIO.

MARCH 7, 2017

SCALE 1" = 100'



**GEESLIN
LAND SURVEYING**

525 S. SECOND ST.
COLDWATER, OHIO 45828
PHONE (419) 678-7232

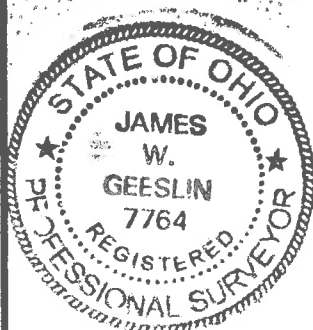

PERMANENT PARCEL No. _____			
Part of: _____ Sec. _____ T. _____ R. _____ Township _____			
Grantor: _____		Area Retained: _____ Acres	
Grantee: _____		Area Transferred: _____ Acres	
Deed References: _____			
APPROVALS: AGENCY: DATE:	Board of Health	Township Zoning Officer	County Engineer

March 7, 2017

KREMER SURVEY DESCRIPTION (TRACT ONE)

Being a part of parcel Number E1402400408 in Jackson Township, Auglaize County, Ohio, in the southeast quarter of Section 24, Township 7 South, Range 4 East. Being more particularly described as follows :

Commencing for reference at an iron bar in a monument box at the southwest corner of the southeast quarter of said Section 24 -

Thence, South 88°31'17" East, along the south line of the southeast quarter of said Section 24 and the centerline of Bensman Road, a distance of 1307.57 feet to a spindle found. Said point being the place of beginning for the parcel of land to be conveyed by this instrument -

Thence, continuing, South 88°31'17" East, along the last described line, a distance of 188.55 feet to a Mag nail set -

Thence, North 01°10'27" East, a distance of 537.06 feet to a 5/8 inch iron bar set -

Thence, South 88°31'17" East, a distance of 179.02 feet to a 5/8 inch iron bar set -

Thence, North 01°10'27" East, a distance of 192.94 feet to a 5/8 inch iron bar found -

Thence, North 88°31'17" West, a distance of 367.57 feet to a 5/8 inch iron bar found -

Thence, South 01°10'27" West, a distance of 730.00 feet to the place of beginning.

Containing 3.953 total acres of land more or less of which 0.108 acre lie in the road right-of-way.

The south line of the southeast quarter of Section 24 bears South 88°31'17" East in agreement with the Auglaize County Local GPS Datum.

Subject to all easements and right-of-way of record.

Reference is made to a survey of this area by James W. Geeslin, Professional Surveyor 7764, dated March 7, 2017. On file in the County Engineer's Office.

Surveyed by James W. Geeslin
James W. Geeslin
P.S. 7764

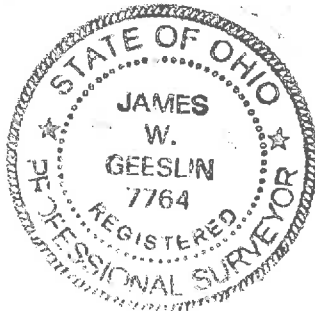

GEESLIN LAND SURVEYING 525 S. SECOND ST. COLDWATER , OHIO 45828 PHONE: (419) 678-7232		PERMANENT PARCEL No. _____	
		Part of _____ Sec. _____ T. _____ R. _____ Township _____	
		Grantor: _____	Area Retained: _____ Acres
		Grantee: _____	Area Retained: _____ Acres
Bearing References: _____		APPROVALS:	
		AGENCY: _____	Board of Health _____ Date _____
			Township Zoning Officer _____ Date _____
			County Engineer _____ Date _____

March 7, 2017

KREMER SURVEY DESCRIPTION (TRACT TWO)

Being a part of parcel Number E1402400408 in Jackson Township, Auglaize County, Ohio, in the southeast quarter of Section 24, Township 7 South, Range 4 East. Being more particularly described as follows :

Commencing for reference at an iron bar in a monument box at the southwest corner of the southeast quarter of said Section 24 -

Thence, South 88°31'17" East, along the south line of the southeast quarter of said Section 24 and the centerline of Bensman Road, a distance of 1496.12 feet to a Mag nail set. Said point being the place of beginning for the parcel of land to be conveyed by this instrument -

Thence, continuing, South 88°31'17" East, along the last described line, a distance of 179.02 feet to a spindle found -

Thence, North 01°10'27" East, a distance of 537.06 feet to a 5/8 inch iron bar set -

Thence, North 88°31'17" West, a distance of 179.02 feet to a 5/8 inch iron bar set -

Thence, South 01°10'27" West, a distance of 537.06 feet to the place of beginning.

Containing 2.207 total acres of land more or less of which 0.103 acre lie in the road right-of-way.

The south line of the southeast quarter of Section 24 bears South 88°31'17" East in agreement with the Auglaize County Local GPS Datum.

Subject to all easements and right-of-way of record.

Reference is made to a survey of this area by James W. Geeslin, Professional Surveyor 7764, dated March 7, 2017. On file in the County Engineer's Office.

Surveyed by James W. Geeslin
James W. Geeslin
P.S. 7764



GEESLIN LAND SURVEYING 525 S. SECOND ST. COLDWATER , OHIO 45828 PHONE: (419) 678-7232		PERMANENT PARCEL No. _____				
		Part of _____ Sec. _____ T. _____ R. _____ Township				
		Grantee: _____ Area Retained: _____ Acres				
		Grantee: _____ Area Retained: _____ Acres				
Deed References: _____		APPROVALS AGENCY: _____		Board of Health _____ Date _____	Township Zoning Officer _____ Date _____	County Engineer _____ Date _____