

# AXE SURVEY

Part of Section 33, Town-5-South,  
Range-4-East, Noble Township,  
City of St. Marys, Auglaize County, Ohio  
as evidenced by Deed Volume 621, Page 1548  
(Parcel # H4303301300).

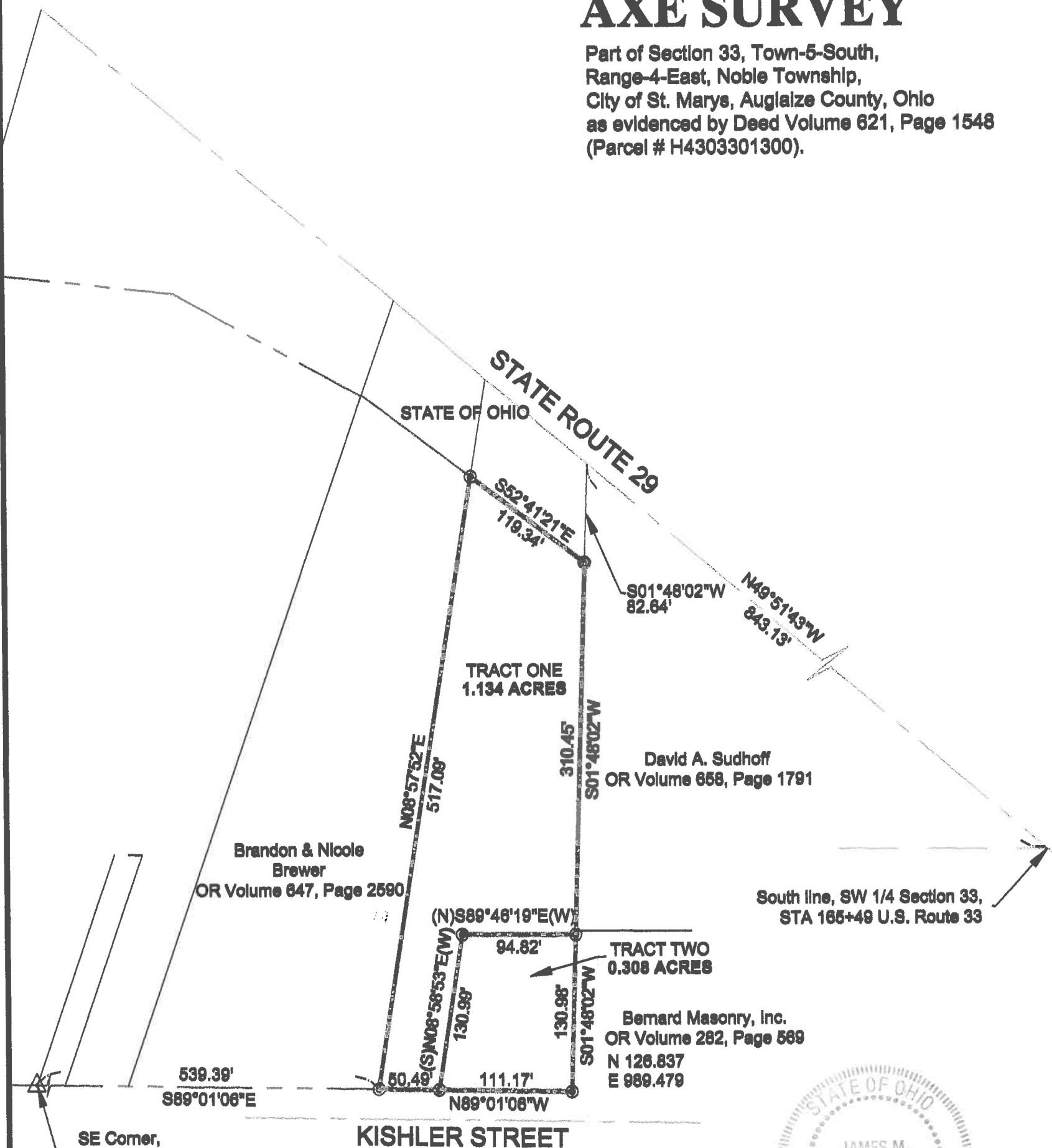

## kent surveying, inc.

acad-Axe, Bob  
drawing #5581  
April 17, 2016

corrected Point of Commencement 4/20/16  
and dimension west line of Tract One 4/25/16

Robert Axe  
Tract One



### SURVEYOR'S DESCRIPTION

scale:

Being a part of the southwest quarter of Section 33, Town-5-South, Range-4-East, Noble Township, Auglaize County, Ohio as evidenced by Official Record Volume 621, Page 1548 (Parcel No. H4303301300 and more particularly described as follows:

Commencing for reference at concrete monument (found) at the southeast corner of the West Oaks Lake Addition; thence, S 89° 01' 06" E along the north right-of-way line of Kishler Street for a distance of 539.39 feet to a 5/8" re-rod w/cap (set) at the **POINT OF BEGINNING** for the tract herein described;

thence, N 08° 57' 52" E for a distance of 517.09 feet to a 5/8" re-rod w/cap (set);

thence, S 52° 41' 21" E for a distance of 119.34 feet to a 5/8" re-rod w/cap (set)

thence, S 01° 48' 02" W for a distance of 310.45 feet to a 5/8" re-rod w/cap (set);

thence, N 89° 46' 19" W for a distance of 94.82 feet to a 5/8" re-rod w/cap (set);

thence, S 08° 58' 53" W for a distance of 130.99 feet to a 5/8" re-rod w/cap (set) on the north right-of-way line of Kishler Street;

thence, N 89° 01' 06" W along the aforesaid right-of-way line for a distance of 50.49 feet to a 5/8" re-rod w/cap (set) at the **POINT OF BEGINNING** containing therein 1.134 acres. Basis of bearings is per Kent Surveying, Inc. drawing #5488 dated May 2, 2014. Prepared by James M. Kent, Professional Surveyor No. 6792 with reference herein made to a plat of Survey, drawing #5581 dated April 17, 2016.

*Corrected Point of Commencement 4/20/16*

*Corrected dimension on west side of tract One 4/25/16*

  
James M. Kent, PS 6792

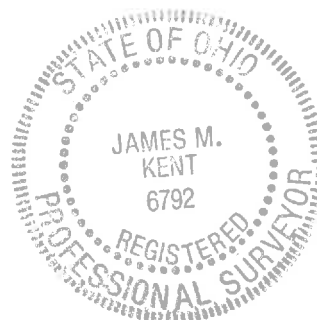

CLIENT AXE DATE 4-25-16  
COUNTY AUGLAIZE TOWNSHIP NOBLE  
SECTION 33 T-5-S; R-4-E DRAWN BY JMK  
SHEET 1 OF 2 DWG. # 5581

 **kent surveying, inc.**  
P.O. Box 96 - 1750 Bellefontaine Street  
Wapakoneta, OH 45895  
419-738-5677 fax 419-738-7894

Robert Axe  
Tract Two



### SURVEYOR'S DESCRIPTION

scale:

Being a part of the southwest quarter of Section 33, Town-5-South, Range-4-East, Noble Township, Auglaize County, Ohio as evidenced by Official Record Volume 621, Page 1548 (Parcel No. H4303301300 and more particularly described as follows:

Commencing for reference at concrete monument (found) at the southeast corner of the West Oaks Lake Addition; thence, S 89° 01' 06" E along the north right-of-way line of Kishler Street for a distance of 589.88 feet to a 5/8" re-rod w/cap (set) at the **POINT OF BEGINNING** for the tract herein described;

thence, N 08° 58' 53" E for a distance of 130.99 feet to a 5/8" re-rod w/cap (set);

thence, S 89° 46' 19" E for a distance of 94.82 feet to a 5/8" re-rod w/cap (set);

thence, S 01° 48' 02" W for a distance of 130.99 feet to a 5/8" re-rod w/cap (set) on the north right-of-way line of Kishler Street;

thence, N 89° 01' 06" W along the aforesaid right-of-way line for a distance of 111.17 feet to a 5/8" re-rod w/cap (set) at the **POINT OF BEGINNING** containing therein 0.308 acres. Basis of bearings is per Kent Surveying, Inc. drawing #5488 dated May 2, 2014. Prepared by James M. Kent, Professional Surveyor No. 6792 with reference herein made to a plat of Survey, drawing #5581 dated April 17, 2016.

*Corrected Point of Commencement - 4/20/16*

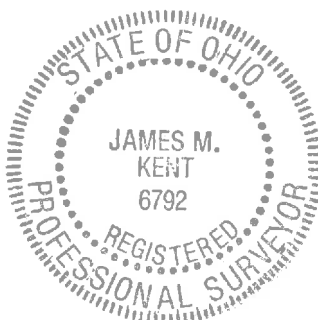

  
James M. Kent, PS 6792

CLIENT ~~Rex~~ R. AXE DATE 3-28-17  
COUNTY AUGLAIZE TOWNSHIP NOBLE  
SECTION 33 T-5-S; R-4-E DRAWN BY JMK  
SHEET 2 OF 2 DWG. # 6792

 **kent surveying, inc.**  
P.O. Box 96 - 1750 Bellefontaine Street  
Wapakoneta, OH 45895  
419-738-5677 fax 419-738-7894