

FLEDDERJOHANN SURVEY

Being Part of the Northeast
Quarter of Section 26, T-6-S, R-4-E, St. Marys
Township, Auglaize County, Ohio.

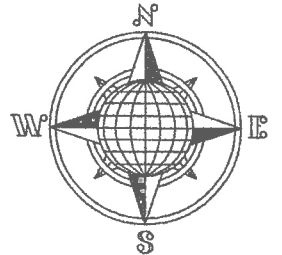

LOCATION PLAN

Section 26

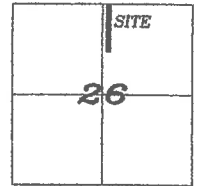

St. Marys Township,
T-6-S, R-4-E, Auglaize
County, Ohio.

N.W. Corner,
N.E. Quarter,
Section 26

State Route 219

30' R/W Line

S.88°57'29"E.
88.09'

S.88°57'29"E.
30.00'

K30-026-002-00
D. & C. Heidt (Trustees)
Deed Volume:
OR 557, Page 1556 & 1559
11.000 Acre

K30-026-004-01
D. & M. Dickman & others
Deed Volume:
226, Page 368
76.459 Acre

0.678 Acre, Heidt
to Fledderjohann

Basis of Bearing is the North line
of the Northeast Quarter of Section 26
and the centerline of State Route 219
as S.88°57'29"E. from the Ohio State-
Plane-North Coordinate System NAD83
(2011).

This Plat is Recorded in Survey
Book "T", Page 94 in the Auglaize
County Engineer's Office.

This plat and the accompanying
legal description represents an
actual boundary survey
completed by John W. Jauert,
P.S. No. 6920 in October, 2017.

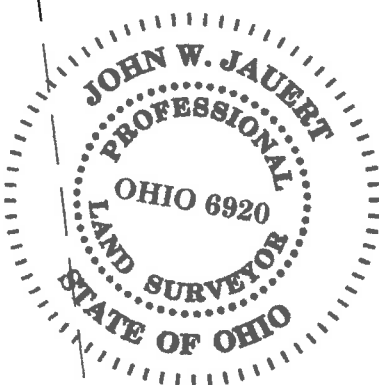

1/2 Section Line

985.46'

S.01°19'22"W.

N.01°19'22"E.

985.46'

N.88°56'55"W.
30.00'

N.01°19'22"E.
346.62'

346.62'

S.01°19'22"W.

0.238 Acre, Easement
Dickman to Fledderjohann

K30-026-004-01
D. & M. Dickman & others
Deed Volume:
226, Page 368
76.459 Acre

S.88°56'55"E.
288.27'

Iron Pin set for
reference only, not
on Canal R/W

K30-026-003-00
T. & D. Fledderjohann (Trustees)
Deed Volume:
OR 236, Page 613
64.500 Acre

ATTEST:

John W. Jauert
Professional Surveyor No. 6920

LEGEND

- Iron Pin Set
- Iron Pin Found
- ⊗ Mag Nail Set
- ⊙ Mag Nail Found
- ⊙ O.D.O.T. Monument Found
- ⊗ Wood Corner Post
- ⊕ Flat Iron Post

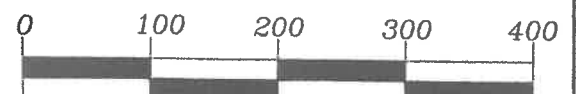

GRAPHIC SCALE

Jauert
surveying

11584 Monroe Road
Wapakoneta, Ohio
45895
(419) 657-6999

CLIENT: Tom Fledderjohann

COUNTY: Auglaize TOWNSHIP: St. Marys SEC. 23

DRAWN BY: J.W.J. SCALE: 1"=150' DWG.# 17-4323

CHECKED BY: DATE: October 2017

SHEET 1 OF 4

(T-6-S; R-4-E)

T-94

- John Jauert
- 11584 Monroe Road
- Wapakoneta, Ohio 45895



- Phone: (419) 657-6999
- FAX: (419) 657-2745
- E-Mail: jjsurvey@ohiolink.net

HEIDT TO FLEDDERJOHANN 0.678 ACRE EASEMENT

The following described tract of land is part of the Northeast Quarter of Section 26, Town 6 South, Range 4 East, St. Marys Township, Auglaize County, Ohio, being part of Parcel No. K30-026-002-00 and is more particularly described as follows:

Commencing at a Mag Nail (found) at the Northwest corner of the Northeast Quarter of Section 26, St. Marys Township and in the centerline of State Route 219;

Thence S.88°57'29"E. along the centerline of State Route 219 and the North line of the Northeast Quarter of Section 26, a distance of 88.09 feet to a Mag Nail (set) which is the PLACE OF BEGINNING for the tract of land herein described;

Thence continuing S.88°57'29"E. along the above described line, a distance of 30.00 feet to a Mag Nail (set);

Thence S.01°19'22"W. a distance of 985.46 feet to an iron pin (set);

Thence N.88°56'55"W. a distance of 30.00 feet to an iron pin (set);

Thence N.01°19'22"E. a distance of 985.46 feet to the Mag Nail (set), passing thru an iron pin (set) for reference at 955.46 feet in the North right-of-way line of State Route 219, said Mag Nail was the true PLACE OF BEGINNING.

Containing in all 0.678 Acres of which 0.021 Acre has been used for highway purposes and being subject to all legal easements, restrictions and reservations, if any, of record or in use on said premises. Previous deed reference: Volume OR 557, Page 1556 & 1559. This plat is recorded in Survey Book "T", Page 94, in the Auglaize County Engineer's Office. Basis for bearings for this tract is holding the centerline of State Route 219 and the South line of the Southeast Quarter of Section 23, St. Marys Township as N.88°57'29"W. from the Ohio State Plane-North Coordinate System NAD83 (2011). This Plat and description was prepared from an actual field survey of the above premises by John W. Jauert, Professional Surveyor No. 6920 in October 2017.

ATTEST:

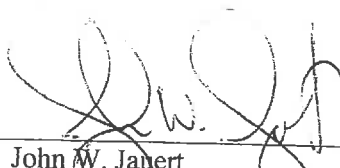

John W. Jauert
Professional Surveyor No. 6920

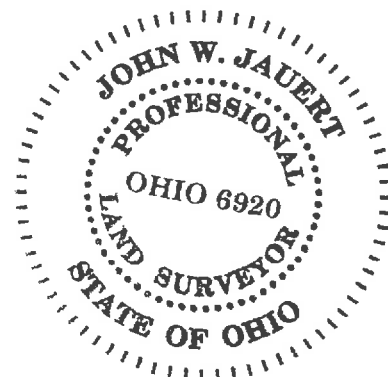

- John Jauert
- 11584 Monroe Road
- Wapakoneta, Ohio 45895.



- Phone: (419) 657-6999
- FAX: (419) 657-2745
- E-Mail: jjsurvey@ohiolink.net

DICKMAN TO FLEDDERJOHANN 0.238 ACRE EASEMENT

The following described tract of land is part of the Northeast Quarter of Section 26, Town 6 South, Range 4 East, St. Marys Township, Auglaize County, Ohio, being part of Parcel No. K30-026-004-01 and is more particularly described as follows:

Commencing at a Mag Nail (found) at the Northwest corner of the Northeast Quarter of Section 26, St. Marys Township and in the centerline of State Route 219;

Thence S.88°57'29"E. along the centerline of State Route 219 and the North line of the Northeast Quarter of Section 26, a distance of 118.09 feet to a Mag Nail (set);

Thence S.01°19'22"W. a distance of 985.46 feet to an iron pin (set), which is the PLACE OF BEGINNING for the tract of land herein described;

Thence continuing S.01°19'22"W. a distance of 346.62 feet to an iron pin set;

Thence N.88°56'55"W. a distance of 30.00 feet to an iron pin (set);

Thence N.01°19'22"E. a distance of 346.62 feet to an iron pin (set);

Thence S.88°56'55"E. a distance of 30.00 feet to the iron pin, which was the true PLACE OF BEGINNING.

Containing in all 0.238 Acres and being subject to all legal easements, restrictions and reservations, if any, of record or in use on said premises. Previous deed reference: Volume 226, Page 368. This plat is recorded in Survey Book "T", Page 94, in the Auglaize County Engineer's Office. Basis for bearings for this tract is holding the centerline of State Route 219 and the South line of the Southeast Quarter of Section 23, St. Marys Township as N.88°57'29"W. from the Ohio State Plane-North Coordinate System NAD83 (2011). This Plat and description was prepared from an actual field survey of the above premises by John W. Jauert, Professional Surveyor No. 6920 in October 2017.

ATTEST:

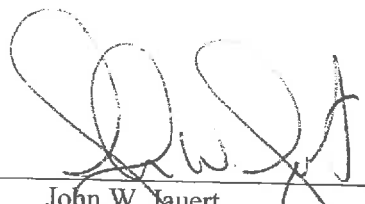

John W. Jauert
Professional Surveyor No. 6920

