

LORE/WIEST SURVEY
PT LOT #195 AND PT LOT #198
VILLA NOVA ON THE LAKE SUBDIVISION
ST. MARYS TWP., AUGLAIZE COUNTY, OH

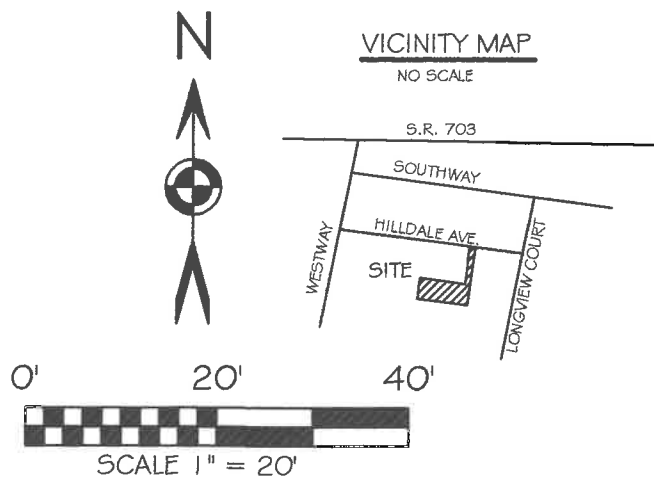
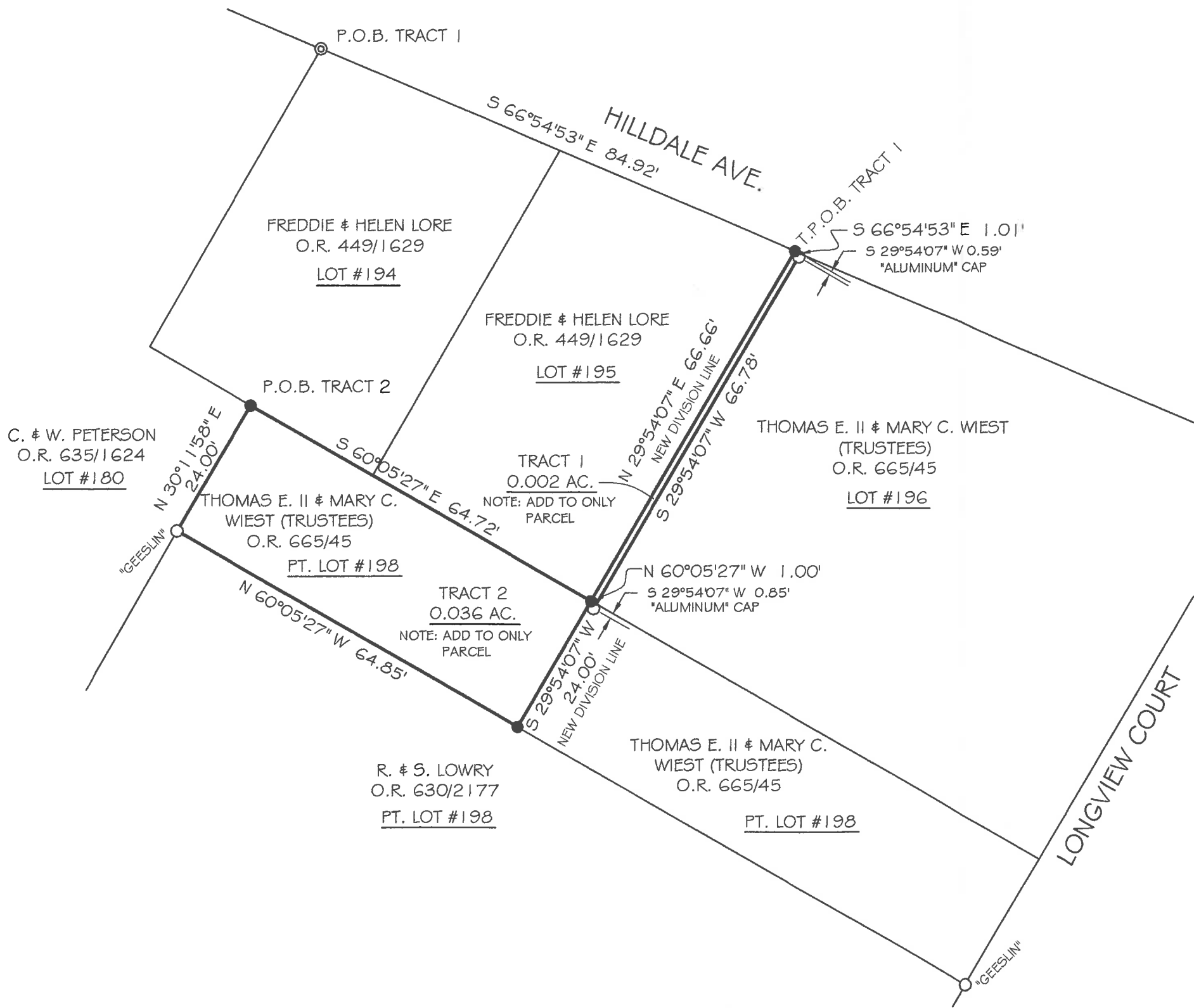

BASIS OF BEARING: BEARINGS ARE OHIO DEPARTMENT OF TRANSPORTATION VRS NAD88(2011 ADJ).

- LEGEND**
- 5/8x30" IRON PIN (SET) W/PINK PLASTIC CAP STAMPED "LOCK TWO 7988"
 - IRON PIN (FOUND)
 - ⊙ IRON PIPE (FOUND)
 - ⊗ RAILROAD SPIKE (FOUND)

Christopher S. Harmon
CHRISTOPHER S. HARMON P.S. #7988
DATE 11/3/17

SURVEY NOTE:
I HEREBY STATE THAT THIS IS A TRUE AND ACCURATE SURVEY AS PERFORMED BY MYSELF. ALL ADJOINING OWNERS, MONUMENTS AND THERE CONDITION ARE CURRENT AS OF THE TIME THE FIELD WORK WAS PERFORMED IN OCTOBER, 2017 AND DONE WITHOUT THE BENEFIT OF A TITLE SEARCH.



FILED IN SURVEY BOOK "T", PAGE 97 IN THE AUGLAIZE COUNTY TAX MAP OFFICE.

LOCK-TWO SURVEYING
5166 LOCK TWO RD. NEW BREMEN, OH
419-753-3332

LOCKTWSURVEYING@NKTLCO.NET #17052

Lock Two Surveying, LLP.
5166 Lock Two Rd.
New Bremen, Oh 45869
419-753-3332

Cell: Jenny Saintignon 419-733-9606
Chris Harmon P.S. 419-733-9607

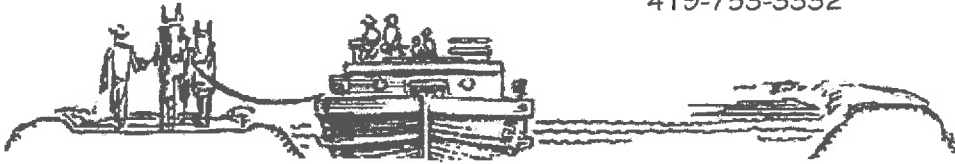

**LORE/WIEST SURVEY
P.T. LOT 195
VILLA NOVA ON THE LAKE SUBDIVISION
PARCEL # K3103919000**

BEING A PART OF LOT 195 TO VILLA NOVA ON THE LAKE SUBDIVISION, ST. MARYS TOWNSHIP, AUGLAIZE COUNTY OHIO, AS SHOWN IN PLAT BOOK A PAGE 15 OWNED BY FRDDIE AND HELEN LORE AS DESCRIBED IN OFFICIAL RECORD 449 PAGE 1629 AND BEING MORE PARTICULLARY DESCRIBED AS FOLLOWS:

Beginning for reference at the northwest corner of Lot 194 of said Villa Nova on the Lake Subdivision and the south right of way line of Hilldale Ave;

Thence, with the south right of way line of Hilldale Avenue and the North line of Lot 194 and Lot 195, owned by Freddie and Helen Lore as recorded in Official Record 449, Page 1629 South 66°54'53" East, 84.92 feet to an iron pin set, said iron pin marking the **True Point of Beginning** of the tract herein described;

Thence, continuing with the south line of Lot 195 and the south right of way line of Hilldale Avenue, South 66°54'53" East, 1.01 feet to a point, witnessing at South 29°54'07" West, 0.59 feet a 5/8 inch iron pin found with "Geeslin" cap;

Thence, with the west line of Lot 196 owned by Thomas E. II & Mary C. Wiest (Trustee) as recorded in Official Record 665 Page 45, South 29°54'07" West, 66.78 feet to a point, witnessing at South 29°54'07" West, 0.85 feet a 5/8 inch iron pin found with "Geeslin" cap;

Thence, with the north line of the North Part Lot 198, North 60°05'27" West, 1.00 feet to an iron pin set;

Thence, with a new division line, North 29°54'07" East, 66.66 feet to the **True Point of Beginning**, containing 0.002 acres more or less and being subject to all legal rights of way, easements, agreements and restrictions of record.

Basis of bearings is based on the Ohio Department of Transportation V.R.S., NAD 88(2011ADJ). The Official Records and Deed Volumes are all recorded in Auglaize County Recorder's Office. Pins noted as set are 5/8" x 30" re-bar with pink plastic caps stamped "Lock-Two 7988".

The above description was prepared by Lock-Two Survey, LLP from a survey performed by Christopher S. Harmon, Professional Surveyor #7988 in October 2017 and filed in Survey Book "T" Page 97 of the Auglaize County Tax Map Office.

Christopher S. Harmon P.S. #7988



11/3/17
Date

Lock Two Surveying, LLP.
5166 Lock Two Rd.
New Bremen, Oh 45869
419-753-3332

Cell: Jenny Santignon 419-733-9606
Chris Harmon P.S. 419-733-9607



**LORE\WIEST SURVEY
P.T. LOT 198
VILLA NOVA ON THE LAKE SUBDIVISION
PARCEL #K3103919300**

BEING A PART OF LOT 198 TO VILLA NOVA ON THE LAKE SUBDIVISION, ST. MARYS TOWNSHIP, AUGLAIZE COUNTY OHIO, AS SHOWN IN PLAT BOOK A PAGE 15 OWNED BY THOMAS E. II & MARY C. WIEST (TRUSTEES) AS DESCRIBED IN OFFICIAL RECORD 665 PAGE 45 AND BEING MORE PARTICULARLY DESCRIBED AS FOLLOWS:

Commencing at a iron pin set at the northeast corner of Lot 180 of said Villa Nova on the Lake Subdivision owned by C. & W. Peterson as recorded in Official Record 635, Page 1624, said iron pin marking the **Point of Beginning** of the tract herein described;

Thence, with the south lines of Lot 194 and Lot 195, owned by Freddie and Helen Lore as recorded in Official Record 449, Page 1629, South $60^{\circ}05'27''$ East, 64.72 feet, to an iron pin set;

Thence, with a new division line, South $29^{\circ}54'07''$ West, 24.00 feet to a iron pin set in the north line of the south half of Part Lot 198 owned by R. & S. Lowry as recorded in Official Record 630, Page 2177;

Thence, with the north line of said south half of Part Lot 198, North $60^{\circ}05'27''$ West, 64.85 feet to a iron pin with "Geeslin" cap found;

Thence, with the east line of said Lot 180, North $30^{\circ}11'58''$ East, 24.00 feet to the **True Point of Beginning**, containing 0.036 acres more or less and being subject to all legal rights of way, easements, agreements and restrictions of record.

Basis of bearings is based on the Ohio Department of Transportation V.R.S., NAD 88(2011ADJ). The Official Records and Deed Volumes are all recorded in Auglaize County Recorder's Office. Pins noted as set are 5/8" x 30" re-bar with pink plastic caps stamped "Lock-Two 7988".

The above description was prepared by Lock-Two Survey, LLP from a survey performed by Christopher S. Harmon, Professional Surveyor #7988 in October 2017 and filed in Survey Book "T" Page 97 of the Auglaize County Tax Map Office.

Christopher S. Harmon P.S. #7988



11/10/17
Date