

JOY & MATTHEW ROHM SURVEY

Being Part of the Southeast Quarter of Section
16, T-6-S, R-7-E, Clay Township,
Auglaize County, Ohio.

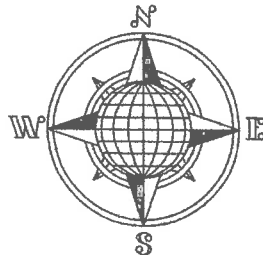

LOCATION PLAN

Section 16

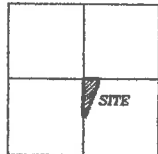

Clay Township,
T-6-S, R-7-E, Auglaize
County, Ohio.

This plat and the accompanying
legal description represents an
actual boundary survey completed
by John W. Jauert, P.S. No. 6920
in December, 2017.

Ⓢ Township Road 116
(Gutman Road 40' R/W)

N.E. Corner,
S.E. Quarter,
Section 16

N.W. Corner,
S.E. Quarter,
Section 16

A03-016-002-01
R.R. Walters (Trustee)
Deed Vol. OR 585,
Page 848 & 854
40 Acre
CLA-16-1

10.122 ACRE
0.244 AC R/W

A03-016-003-01
J. & M. & S. Rohm
Deed Vol. OR 669,
Page 1197
80.619 Acre

A03-016-003-00
G. & T. Randall
Deed Vol. OR 671,
Page 1184 & 1187
4.281 Acre
S-497 & S-565

Basis of Bearing is the North line
of the Southeast Quarter of Section 16
and the centerline of Township Road
Road 116 as S.89°11'52"E. from the
Ohio State Plane-North Coordinate
System NAD83 (2011).

This Plat is Recorded in Survey
Book "T", Page 132 in the Auglaize
County Engineer's Office.

Leaving 70.497± Acre left out
of the original 80.619 Acre tract.

LEGEND

- Ø Mag Nail Set
- Mag Nail Found
- 5/8" Dia. Iron Pin Set
- 5/8" Dia. Iron Pin Found
- Monument Box Found

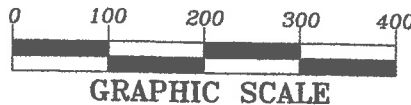

GRAPHIC SCALE

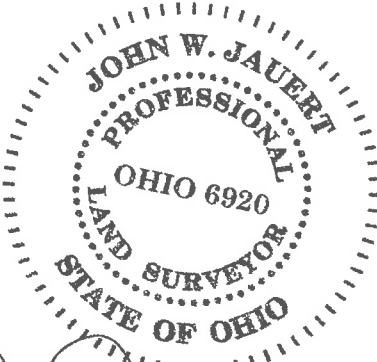

ATTEST:

John W. Jauert
Professional Surveyor No. 6920

**Jauert
surveying**

11584 Monroe Road
Wapakoneta, Ohio
45895
(419) 657-6999

CLIENT: Matthew Rohm		
COUNTY: Auglaize	TOWNSHIP: Clay	SEC. 16
DRAWN BY: J.W.J.	SCALE: 1"=200'	DWG.# 17-4350
CHECKED BY:	DATE: December 2017	
SHEET 1 OF 2	(T-6-S; R-7-E)	

- John Jauert
- 11584 Monroe Road
- Wapakoneta, Ohio 45895.



- Phone: (419) 657-6999
- FAX: (419) 657-2745
- E-Mail: jjsurvey@ohiolink.net

JOY & MATTHEW ROHM SURVEY 10.122 ACRE

The following described tract of land is part of the Southeast Quarter of Section 16, Town 6 South, Range 7 East, Clay Township, Auglaize County, Ohio, being part of Parcel No. A03-016-003-01 and is more particularly described as follows:

The PLACE OF BEGINNING is at a Monument Box (found) at the Northwest corner of the Southeast Quarter of Section 16, Clay Township and in the centerline of Township Road 116 (Gutman Road);

Thence S.89°11'50"E. along the centerline of Township Road 116 and the North line of the Southeast Quarter of said Section 16 a distance of 533.12 feet to a Mag Nail (set);

Thence S.08°37'19"W. along the centerline of an open ditch, a distance of 211.16 feet to a point;

Thence S.22°20'25"W. along the centerline of an open ditch, a distance of 183.79 feet to a point;

Thence S.13°42'05"W. along the centerline of an open ditch, a distance of 101.47 feet to a point;

Thence S.21°36'58"W. along the centerline of an open ditch, a distance of 430.16 feet to a point;

Thence S.21°59'22"W. along the centerline of an open ditch, a distance of 290.38 feet to a point;

Thence S.22°09'35"W. along the centerline of an open ditch, a distance of 173.93 feet to a point;

Thence N.89°27'12"W. a distance of 88.85 feet to an iron pin (found), passing thru an iron pin (found) at 20.00 feet in the top of the ditch bank;

Thence N.00°36'56"E. a distance of 1,314.29 feet to the Monument Box (found), passing thru an iron pin (found) at 1,294.29 feet in the South right-of-way line of Township Road 116, said Monument Box was the true PLACE OF BEGINNING.

Containing in all 10.122 Acres of which 0.244 Acre has been used for highway purposes and being subject to all legal easements, restrictions and reservations, if any, of record or in use on said premises. Previous deed reference: Volume OR 699, Page 1197. This plat is recorded in Survey Book "T", Page 132, in the Auglaize County Engineer's Office. Basis for bearings for this tract is holding the centerline of Township Road 116 and the North line of the Southeast Quarter of Section 16, Clay Township as N.89°11'52"W. from the Ohio State Plane-North Coordinate System NAD83 (2011). This Plat and description was prepared from an actual field survey of the above premises by John W. Jauert, Professional Surveyor No. 6920 in December 2017.

ATTEST:

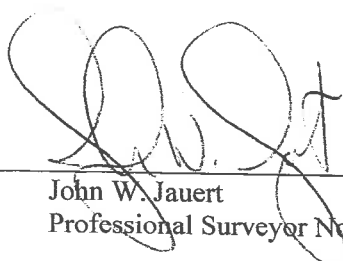
John W. Jauert
Professional Surveyor No. 6920

