

# WHITE-MUSSELMAN SURVEY

Being Part of the Northeast Quarter of Section 10 and Part of the Northwest Quarter of Section 11, Town 5 South, Range 6 East, Duchouquet Twp., Auglaize County, Ohio.

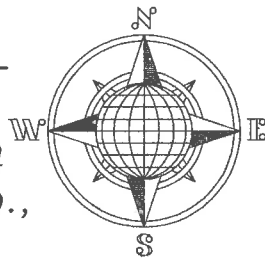

County Road 190  
(Buckland-Holden Road)

## LOCATION PLAN

Section 10 & 11

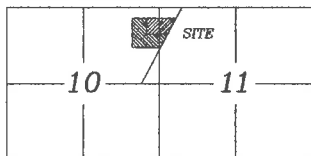

Duchouquet Township,  
T-5-S, R-6-E, Auglaize  
County, Ohio.

N.E. Corner,  
N.E. Quarter,  
Section 10

N.E. Corner,  
N.W. Quarter,  
Section 11

B05-010-001-00  
D.&K. Green  
Deed Vol. OR 657,  
Page 829.  
11.11 Acre  
"0"-75

B05-011-002-00  
D.&K. Green  
Deed Vol. OR 657,  
Page 829.  
7.217 Acre  
"0"-75

B05-011-002-02  
R. Sharp Sr.  
Deed Vol. OR 681,  
Page 637.  
1.016 Acre  
"H"-220

S.89°46'01"E.  
261.19'

S.89°46'01"E.  
243.75'

S.89°52'08"E.  
304.64'

B05-010-017-02

B05-011-001-00

3.250 ACRE

0.352 AC R/W

B05-010-017-02  
Debra K. White  
Deed Vol. OR 684,  
Page 1317.  
6.35 Acre  
"I"-74  
"I"-80

1.679 Acre  
Sec. 10

1.571 Acre  
Sec. 11

N.89°14'13"W.  
393.06'

0.484 Acre  
Sec. 11

5.163 ACRE

0.289 AC R/W

4.679 Acre  
Sec. 10

B05-010-017-03  
B.&M. Musselman  
Deed Vol. OR 105,  
Page 405.  
5.01 Acre  
"I"-74

Basis of Bearing is the North line of  
of the Northwest Quarter of Section  
11 and the centerline of County Road  
190 as N.89°57'12"W. from the Ohio  
State Plane-North Coordinate System  
NAD83 (2011).

This Plat is Recorded in Survey  
Book "T", Page 390 in the Auglaize  
County Engineer's Office.

This plat and the accompanying  
legal descriptions represents an  
actual boundary survey completed  
by John W. Jauert, P.S. No. 6920  
in August, 2018.



ATTEST:

John W. Jauert  
Professional Surveyor No. 6920

SECTION 10  
SECTION 11

SECTION 10  
SECTION 11

- LEGEND
- Ø Mag Nail Set
  - Mag/P.K. Nail Found
  - 5/8" Dia. Iron Pin Set
  - 5/8" Dia. Iron Pin Found
  - Monument Box Found



Jauert  
surveying

11584 Monroe Road  
Wapakoneta, Ohio  
45895  
(419) 657-6999

CLIENT: White-Musselman Survey		
COUNTY: Auglaize	TOWNSHIP: Duchouquet	SEC. 10,11
DRAWN BY: J.W.J.	SCALE: 1"=125'	DWG.# 18-4384
CHECKED BY:	DATE: August 2018	
SHEET 1 OF 3		(T-5-S; R-6-E)

- John Jauert
- 11584 Monroe Road
- Wapakoneta, Ohio 45895



- Phone: (419) 657-6999
- FAX: (419) 657-2745
- E-Mail: jjsurvey@ohiolink.net

## WHITE-MUSSELMAN SURVEY 5.163 ACRE TRACT

The following described tract of land is part of the Northeast Quarter of Section 10 and part of the Northwest Quarter of Section 11, Town 5 South, Range 6 East, Duchouquet Township, Auglaize County, Ohio, being part of Parcels No. B05-010-017-02 and B05-011-001-00 and is more particularly described as follows:

Commencing at a Monument Box (found) at the Northeast corner of the Northeast Quarter of Section 10, Duchouquet Township and in the centerline of County Road 190 (Buckland-Holden Road);

Thence S.00°37'47"W. along the East line of the Northeast Quarter of said Section 10, a distance of 728.64 feet to an iron pin (set);

Thence N.89°46'01"W. a distance of 243.75 feet to an iron pin (set) which is the PLACE OF BEGINNING for the tract of land herein described;

Thence S.00°45'46"W. a distance of 298.57 feet to an iron pin (set);

Thence S.89°14'13"E. a distance of 393.06 feet to a Mag Nail (set), passing thru an iron pin (set) for reference at 342.54 feet in the Westerly right-of-way line of County Road 25-A;

Thence S.27°48'38"W., along the centerline of County Road 25-A, a distance of 279.92 feet to a P.K. Nail (found);

Thence N.89°14'13"W. a distance of 526.94 feet to an iron pin (found), passing thru an iron pin (found) for reference at 50.52 feet in the Westerly right-of-way line of C.R. 25-A;

Thence N.00°45'46"E. a distance of 545.46 feet to an iron pin (found);

Thence S.89°46'01"E. a distance of 261.19 feet to the iron pin (set), which was the true PLACE OF BEGINNING.

Containing in all 5.163 Acres of which 0.289 Acre has been used for highway purposes and being subject to all legal easements, restrictions and reservations, if any, of record or in use on said premises. Previous deed reference: Volume OR 684, Page 1317. This plat is recorded in Survey Book "T", Page 390, in the Auglaize County Engineer's Office. Basis for bearings for this tract is holding the centerline of County Road 190 and the North line of the Northwest Quarter of Section 11, Duchouquet Township as N.89°57'12"W. from the Ohio State Plane-North Coordinate System NAD83 (2011). This Plat and description was prepared from an actual field survey of the above premises by John W. Jauert, Professional Surveyor No. 6920 in August 2018.

ATTEST:

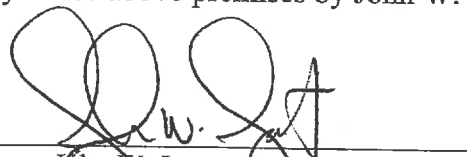
  
John W. Jauert  
Professional Surveyor No. 6920

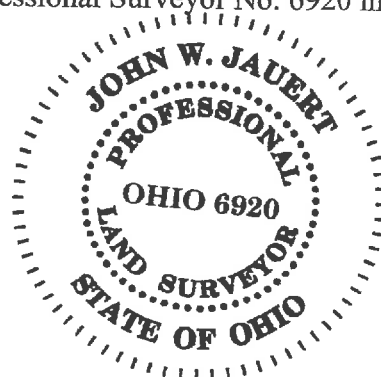

- John Jauert
- 11584 Monroe Road
- Wapakoneta, Ohio 45895.



- Phone: (419) 657-6999
- FAX: (419) 657-2745
- E-Mail: jjsurvey@ohiolink.net

## WHITE-MUSSELMAN SURVEY 3.250 ACRE TRACT

The following described tract of land is part of the Northeast Quarter of Section 10 and part of the Northwest Quarter of Section 11, Town 5 South, Range 6 East, Duchouquet Township, Auglaize County, Ohio, being part of Parcels No. B05-010-017-02 and B05-011-001-00 and is more particularly described as follows:

Commencing at a Monument Box (found) at the Northeast corner of the Northeast Quarter of Section 10, Duchouquet Township and in the centerline of County Road 190 (Buckland-Holden Road);

Thence S.00°37'47"W. along the East line of the Northeast Quarter of said Section 10, a distance of 728.64 feet to an iron pin (set) which is the PLACE OF BEGINNING for the tract of land herein described;

Thence S.89°52'08"E. a distance of 304.64 feet to a Mag Nail (set), passing thru an iron pin (set) for reference at 253.83 feet in the Westerly right-of-way line of County Road 25-A;

Thence S.27°48'38"W., along the centerline of County Road 25-A, a distance of 341.53 feet to a Mag Nail (set);

Thence N.89°14'13"W. a distance of 393.06 feet to an iron pin (set), passing thru an iron pin (set) for reference at 50.52 feet in the Westerly right-of-way line of County Road 25-A;

Thence N.00°45'46"E. a distance of 298.57 feet to an iron pin (set);

Thence S.89°46'01"E. a distance of 243.75 feet to the iron pin (set), which was the true PLACE OF BEGINNING.

Containing in all 3.250 Acres of which 0.352 Acre has been used for highway purposes and being subject to all legal easements, restrictions and reservations, if any, of record or in use on said premises. Previous deed reference: Volume OR 684, Page 1317. This plat is recorded in Survey Book "T", Page 390, in the Auglaize County Engineer's Office. Basis for bearings for this tract is holding the centerline of County Road 190 and the North line of the Northwest Quarter of Section 11, Duchouquet Township as N.89°57'12"W. from the Ohio State Plane-North Coordinate System NAD83 (2011). This Plat and description was prepared from an actual field survey of the above premises by John W. Jauert, Professional Surveyor No. 6920 in August 2018.

ATTEST:

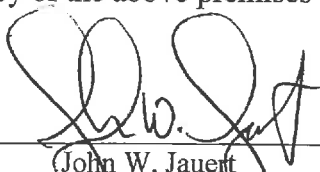
  
John W. Jauert  
Professional Surveyor No. 6920

