

PLAT OF
SURVEY
FOR
E. MARKLEY

SITUATED IN:
THE SE. 1/4, SECTION 36
TOWN 4 S. RANGE 6E.,
DUCHOUQUET TOWNSHIP,
AUGLAIZE COUNTY, OHIO

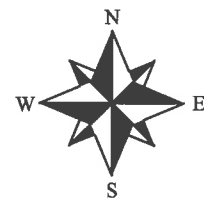

NORTH AND BEARING
SYSTEM BASED ON
OHIO NORTH STATE
PLANE GRID, NAD 83
ADJ. 2011.

NORTHEAST CORNER
SOUTHEAST QUARTER
SECTION 36

TOWNLIN - LIMA ROAD

JOHN AND BRENDA
PLESCHER
D.V. 244, PG. 833
1.0 AC.

VON MARKLEY, TR.
O.R. 406, PG. 588
11.5 AC.

LUCY E. HAYWOOD
D.V. 171, PG. 528
7.5 AC.

N89°18'16"W
290.40'

POB
0.135 AC.

S00°42'53"W
22.54'

S00°42'53"W
17.87'

S89°18'16"E
1034.61'
0.733 ACRES

S89°46'27"W
1034.47'

N00°18'27"E
39.18'

SOUTHEAST CORNER
SOUTHEAST QUARTER
SECTION 36

S00°42'53"W
2221.06'

25.00'
25.00'

LEGEND:

- △ SPIKE FOUND
- MONUMENT BOX FOUND
- 5/8" IRON PIN FOUND
- ⊙ 1/2" IRON PIPE FOUND
- MAG NAIL SET
- 5/8" IRON PIN W/ CAP SET

THIS PLAT IS BASED ON AN ACTUAL FIELD SURVEY.

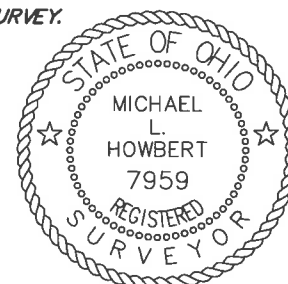

MICHAEL L. HOWBERT
REGISTERED PROFESSIONAL
SURVEYOR NO. 7959 IN OHIO
JANUARY 7, 2019

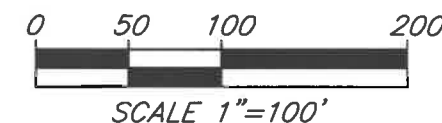

NOTES:

FOUND MONUMENTATION IN GOOD CONDITION
UNLESS OTHERWISE NOTED.
DATA SOURCES INCLUDE DOCUMENTS CITED.
A TITLE SEARCH IS RECOMMENDED TO DETERMINE
EASEMENTS, RESTRICTIONS, AND/OR OTHER
ENCUMBRANCES AFFECTING THE PROPERTY
SHOWN HEREON.

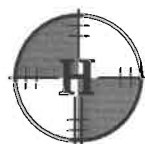

**HOWBERT
SURVEYING, L.L.C.**

8477 MERICLE ROAD
FORT JENNINGS, OHIO 43844
PH. 419-682-1085

DATE: 1/7/19
CLIENT: E. MARKLEY
JOB #: 3-01-19

REV.:
SCALE: 1" = 100'
CHK:

FILE: E:\MARKLEY.DWG



HOWBERT SURVEYING, L.L.C.
8477 Mericle Road
Fort Jennings, OH 45844
419-863-0289

Description
0.733 Acres

- Situated in the Southeast Quarter of Section 36, Town 4 South, Range 6 East, Duchouquet Township, Auglaize County, Ohio, being part of a 7.500 acre tract as described in Deed Volume 171, Page 528, Part of Parcel # B0503603200, and being more particularly described as follows;
- Commencing at the northeast corner of the southeast quarter of said section 36, being a monument box found;
- Thence along the east line of said southeast quarter, S.00°42'53"W., a distance of 412.96 feet to a spike found;
- Thence along the north line of said 7.500 acre tract, N.89°18'16"W., a distance of 290.40 feet to a 5/8" iron pin set at the *Principal Point of Beginning*;
- Thence along a new division line on the following two (2) courses and distances:
1. S.00°42'53"W., a distance of 22.54 feet to a 5/8" iron pin set;
2. S.89°46'27"W., a distance of 1034.47 feet to a 1/2" iron pipe found;
- Thence along the westerly line of said 7.500 acre tract, N.00°18'27"E., a distance of 39.18 feet to a 5/8" iron pin found that the northwest corner of said 7.500 acre tract;
- Thence on the northerly line of said 7.500 acre tract, S.89°18'16"E., a distance of 1034.61 feet to the Principal Point of Beginning;
- Containing 0.733 acres, more or less, and being subject to all legal highways, rights-of-way, easements, restrictions, covenants, and/or conditions of record.

The above description is based on a survey prepared by Michael L. Howbert, Registered Professional Surveyor, No. 7959, in January of 2019, and bearing system is based on Ohio North State Plane Grid, NAD 83 Adjustment 2011.

Michael L. Howbert, P.S.

