

# NICK SCHULTZ SURVEY

15.000 Acres being a part of the East Half of the Southeast Quarter of Section 5,  
Clay Township, Town-6-South, Range-7-East,  
Auglaize County, Ohio



*Ted K. Schnell*

Ted K. Schnell  
Professional Engineer 51963  
Professional Surveyor 7216

I do hereby Attest that this Survey and Plat as Recorded is a true  
and accurate representation of the measurements taken under my  
direct supervision on the 3rd day of February, 2020.



Nicholas E. Schultz  
Deed Vol OR 625, Page 1159  
Parcel # A03-005-014-00

A B C D  
INGRESS - EGRESS EASEMENT  
E S. 89°-20'-45" E. 528.32'

## EASEMENT TRAVERSE

A N. 00°-40'-35" E. 35.00'  
B S. 89°-20'-45" E. 456.51'  
C S. 00°-40'-35" W. 35.00'  
D N. 89°-20'-45" W. 40.00'  
E N. 89°-20'-45" W. 416.51'

Easement Area = 0.367 Ac.

15.000 Acres  
(0.243 Ac. R/W)

## LOCATION PLAN

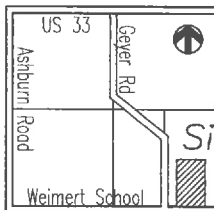

Section 5, Clay Twp  
Auglaize County, Ohio

## SURVEY REF'S

Kent Survey - Keller/Bailey  
Survey CLA-005-002  
Auglaize County Map Office  
October 10, 1997

Kent Survey - Van Voorhis  
Survey CLA-005-001  
Auglaize County Map Office  
July 1, 1996

## LEGEND

- Iron Pin (set)
- Pipe (fd)
- ⊗ Gin Spindle (fd)
- Monument Box (fd)
- △ Mag Nail (set)
- ⊠ Perma-Marker (set)

SCALE



Southwest Corner  
of the East Half  
of the Southeast Quarter,  
Section 5, Clay Twp.

Nicholas E. Schultz  
Deed Vol OR 625, Page 1159  
Parcel # A03-005-014-00

## NOTES

The bearings used for this Survey were  
based upon Auglaize County GPS coordinates  
and bearings.

This Survey Plat and Legal Description is  
filed in Survey Book \_\_\_\_\_, Page \_\_\_\_\_  
Auglaize County Map Office.

CLAY ROAD  
(T.R. # 126)

WEIMERT SCHOOL ROAD  
(T.R. # 130)

Ted K. Schnell PE, PS

913 Fieldstone Court Wapakoneta, Ohio 45895

NICK SCHULTZ

client

CLAY

township

AUGLAIZE

county

5

section

OHIO

state



02/05/2020

date

Ted K. Schnell PE, PS  
913 Fieldstone Court  
Wapakoneta, Ohio 45895  
Phone (419) 230-7896  
e-mail: kschnell7216@gmail.com



### Surveyor's Description of 15.000 Acre Parcel

The following described parcel of land is a part of the East half of the Southeast Quarter of Section 5, Clay Township, Town-6-South, Range-7-East, Auglaize County, Ohio, and is more particularly described as follows:

Commencing for reference at a Monument Box (found) situated at the Southwest corner of the East half of the Southeast Quarter of said Section 5, Clay Township, Town-6-South, Range-7-East, also being the intersection of Geyer Road (County Road #207) with Weimert School Road (Township Road #130);

Thence with a bearing of S. 89°-00'-05" E. along the South line of the East half of the Southeast Quarter of said Section 5, Clay Township, and the centerline of Weimert School Road (Township Road #130) for a distance of 416.52 feet to a Mag Nail (set), and the PLACE OF BEGINNING;

Thence with a bearing of N. 00°-40'-35" E. and parallel with the centerline of Geyer Road (County Road #207), for a distance of 1,235.16 feet to a Perma-Marker (set), and passing thru an Iron Pin (set) for reference at a distance of 20.00 feet;

Thence with a bearing of S. 89°-20'-45" E. for a distance of 528.32 feet to a point;

Thence with a bearing of S. 00°-40'-35" W. and parallel with the centerline of Geyer Road (County Road #207), for a distance of 1,238.33 feet to a Mag Nail (set), and passing thru an Iron Pin (set) for reference at a distance of 1,218.33 feet;

Thence with a bearing of N. 89°-00'-05" W. along the South line of the East half of the Southeast Quarter of said Section 5, Clay Township, and the centerline of Weimert School Road (Township Road #130) for a distance of 528.33 feet to a Mag Nail (set), and the original PLACE OF BEGINNING.

Containing in all, 15.000 Acres of land, of which, 0.243 Acre being previously dedicated for highway purposes. The above described tract of land is subject to any or all legal easements, reservations, or restrictions of record upon said premises.

The basis of bearings used for this description were determined from the Auglaize County Engineer's Global Positioning Survey and Coordinate System, whereas the centerline of Geyer Road bears N. 00°-40'-35" E.

This legal description was prepared from an actual field survey performed by Ted K. Schnell, Professional Land Surveyor #7216, on February 3rd of 2020. A survey plat of this field survey is recorded with the Auglaize County Engineer's Map Office. Refer to SURVEY BOOK \_\_\_\_\_, PAGE \_\_\_\_\_.

Grantor's Prior Deed References: Deed Volume OR 625, Page 1159, Auglaize County Recorder's Office.

This parcel is a split out of permanent parcel #A03-005-014-00.

Prepared By:

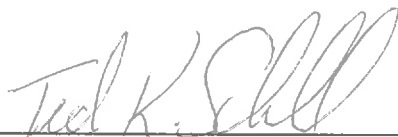

Ted K. Schnell  
Professional Engineer 51963  
Professional Surveyor 7216

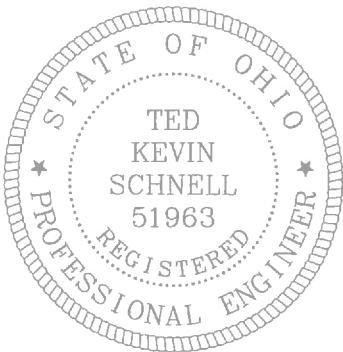

Ted K. Schnell PE, PS  
913 Fieldstone Court  
Wapakoneta, Ohio 45895  
Phone (419) 230-7896  
e-mail: kschnell7216@gmail.com



### Surveyor's Description of Ingress-Egress Easement

The following described parcel of land is intended to be used as an Ingress-Egress easement and is a part of the East half of the Southeast Quarter of Section 5, Clay Township, Town-6-South, Range-7-East, Auglaize County, Ohio, and is more particularly described as follows:

Commencing for reference at a Monument Box (found) situated at the Southwest corner of the East half of the Southeast Quarter of said Section 5, Clay Township, Town-6-South, Range-7-East, also being the intersection of Geyer Road (County Road #207) with Weimert School Road (Township Road #130);

Thence with a bearing of N.  $00^{\circ}-40'-35''$  E. along the centerline of Geyer Road (County Road #207), for a distance of 1,232.65 feet to a point, said point being the PLACE OF BEGINNING;

Thence continuing with a bearing of N.  $00^{\circ}-40'-35''$  E. along the centerline of Geyer Road (County Road #207), for a distance of 35.00 feet to a point;

Thence with a bearing of S.  $89^{\circ}-20'-45''$  E. for a distance of 456.51 feet to a point;

Thence with a bearing of S.  $00^{\circ}-40'-35''$  W. and parallel with the centerline of Geyer Road (County Road #207), for a distance of 35.00 feet to a point;

Thence with a bearing of N.  $89^{\circ}-20'-45''$  W. for a distance of 40.00 feet to a Perma-Marker (set);

Thence continuing with a bearing of N.  $89^{\circ}-20'-45''$  W. for a distance of 416.51 feet to a point in the centerline of Geyer Road, and the original PLACE OF BEGINNING.

The above described Ingress-Egress Easement containing in all, 0.367 Acres of land. The above described tract of land is subject to any or all legal easements, reservations, or restrictions of record upon said premises.

The basis of bearings used for this description were determined from the Auglaize County Engineer's Global Positioning Survey and Coordinate System, whereas the centerline of Geyer Road bears N.  $00^{\circ}-40'-35''$  E.

This legal description was prepared from an actual field survey performed by Ted K. Schnell, Professional Land Surveyor #7216, on February 3rd of 2020. A survey plat of this field survey is recorded with the Auglaize County Engineer's Map Office. Refer to SURVEY BOOK \_\_\_\_\_, PAGE \_\_\_\_\_.

Grantor's Prior Deed References: Deed Volume OR 625, Page 1159, Auglaize County Recorder's Office.

This parcel is an Ingress-Egress easement upon permanent parcel #A03-005-014-00.

Prepared By:



Ted K. Schnell  
Professional Engineer 51963  
Professional Surveyor 7216

