

THIS PLAT REPRESENTS AN ACTUAL FIELD SURVEY PERFORMED
UNDER MY SUPERVISION, AS DATED HEREIN

ATTEST: JAMES W. GEESLIN
PROFESSIONAL SURVEYOR 7764

LEGEND

- △ = P.K. NAIL FOUND.
- = 5/8 INCH IRON BAR FOUND.
- ✱ = RAILROAD SPIKE FOUND.
- = 5/8 INCH IRON BAR SET.
- ⊗ = MAG NAIL SET.



THOMAS & SHARON MENCHOFFER
66.265 AC.
O.R. 617 PG. 1420

BEVERLY'S DESTINY, LLC
30.064 AC.
O.R. 692 PG. 624

TRACT "A"
0.382 AC
(0.021 AC. IN R/W)

N. LINE - S. 1/2 - S.E. 1/4 - SEC. 8

APPROXIMATE CREEK
S 89°26'43" W 594.18'
544.18'
50.00'
S 04°31'18" W 82.37'
S 39°20'33" E 259.30'

SHAE & KAITLYN MULLINS
6.015 ACRES
O.R. 698 PG. 3028
PARCEL # H2300800305

DIANE SHANER, LLC
28.999 AC.
O.R. 611 PG. 2491

S 39°19'19" E 44.96'
S 13°56'38" E 66.50'

S 24°41'26" E 66.79'

DANNY & KATHY MULLINS
3.365 AC.
O.R. 639 PG. 1809
PARCEL # H23-008-00-304

DANNY & KATHY MULLINS
4.649 AC.
O.R. 639 PG. 1809
PARCEL # H23-008-00-302

DENNIS & ADELE WALLS
9.294 AC.
O.R. 161 PG. 471

TRACT "B"
2.984 ACRES
N 00°12'45" W 394.93'
329.08'
29.91'
S 89°27'15" W 554.73'
S 89°26'43" W 594.18'
S 89°27'15" W 883.80'
S 00°12'45" E 365.07'
S 89°27'15" E 1249.32'
654.59'
329.07'
524.73'
50.00'

GARAGE
METAL BLDG
2 STY FRAME
WELL
CO TANK
POND
LEECH FILTRATION

30.00'
395.07'
30' R/W LINE
N 00°12'45" W 1330.17'
E. LINE - S.E. 1/4 - SEC. 8 & S.R. 116

*** THE E. LINE OF THE S.E. 1/4 BEARS N. 00°12'45" W. IN
AGREEMENT WITH PRIOR SURVEYS BY J. JAURET, P.S.
6920 DATED 8/22/88 AND G. GEESLIN, P.S. 5372 DATED
4/23/96.

LOCATION SKETCH

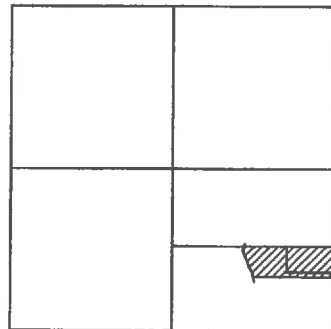

SECTION 8

MULLINS SURVEY

PART OF THE S. 1/2 - S.E. 1/4 - SEC. 8, TOWN 5 SOUTH, RANGE 4 EAST,
(NOBLE TOWNSHIP), AUGLAIZE COUNTY, OHIO.

MARCH 25, 2019

SCALE 1" = 200'

REVISED 4/15/19 TO SHOW EXISTING IMPROVEMENTS.
REVISED 8/26/20 TO SHOW TRACT "A" (AN ADD ON TO PARCEL H2300800302),
AND ALSO TO SHOW TRACT "B" (AN ADD ON TO PARCEL H2300800305).



| | | |
|-------------------------|------------------------|-------------------------|
| PERMANENT PARCEL No. | Part of: Sec. T. R. | Township |
| | Grantor: | Area Retained: Acres |
| | Grantee: | Area Retained: Acres |
| Dead References: | APPROVALS: | County Engineer |
| AGENCY: | Board of Health | Township Zoning Officer |
| DATE: | | |

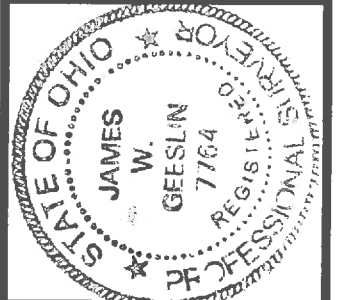

GEESLIN
LAND SURVEYING

525 S. SECOND ST.
COLDWATER, OHIO 45828

PHONE: (419)678-7233
geeslinsurveying@gmail.com

August 26, 2020

MULLINS SURVEY DESCRIPTION (TRACT "A")

Being a part of Parcel Number H23-008-00-304 and being a part of a 14.029 acre parcel of land conveyed to Danny and Kathy Mullins by deed recorded at Official Record 639, page 1809, in Noble Township, Auglaize County, Ohio, in the south half of the southeast quarter of Section 8, Township 5 South, Range 4 East. Being more particularly described as follows:

Commencing for reference at an iron bar in a monument box at the southeast corner of said Section 8 -

Thence, North 00°12'45" West, along the east line of the southeast quarter of said Section 8 and the centerline of State Route 116, a distance of 1300.17 feet to a P.K. nail found. Said point being the place of beginning for the parcel of land to be conveyed by this instrument -

Thence, continuing, North 00°12'45" West, along the last described line, a distance of 30.00 feet to a railroad spike found -

Thence, South 89°26'43" West, along the north line of the south half of the southeast quarter of said Section 8, a distance of 554.73 feet to point -

Thence, South 00°12'45" East, a distance of 29.91 feet to a 5/8 inch iron bar found -

Thence, North 89°27'15" East, a distance of 554.73 feet to the place of beginning.

Containing 0.382 acre of land more or less.

The east line of the southeast quarter of said Section 8 was assumed to bear North 00°12'45" West in agreement with surveys by John Jauret, Professional Surveyor 6920 dated August 22, 1988 and Gordon Geeslin, Professional Surveyor 5372 dated April 23, 1996. Both surveys are on file in the County Engineer's Office.

Subject to all easements and right-of-way of record.

Reference is made to an actual field survey of this area by James W. Geeslin, Professional Surveyor 7764, dated March 25, 2019 and revised on April 15, 2019 and August 26, 2020. On file in the County Engineer's Office.

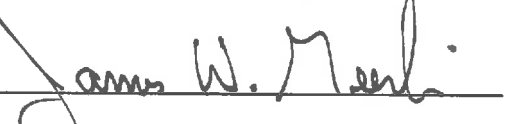
Attest: James W. Geeslin, P.S. No. 7764

**GEESLIN
LAND SURVEYING**

525 S. SECOND ST.
COLDWATER, OHIO 45828

PHONE: (419)678-7233
geeslinsurveying@gmail.com

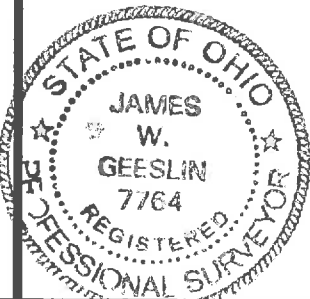

| | | | |
|-------------------------------|----------------------------|-------------------------|-------------------|
| PERMANENT PARCEL No. _____ | | | |
| Part of: _____ | Sec. _____ | T. _____ | R. _____ Township |
| Grantor: _____ | Area Retained: _____ Acres | | |
| Grantee: _____ | Area Retained: _____ Acres | | |
| Deed References: _____ | | | |
| APPROVALS: | | | |
| AGENCY: _____ | Board of Health | Township Zoning Officer | County Engineer |
| DATE: _____ | | | |

U-155

August 26, 2020

MULLINS SURVEY DESCRIPTION (TRACT "B")

Being a part of Parcel Number H23-008-00-304 and being a part of a 14.029 acre parcel of land conveyed to Danny and Kathy Mullins by deed recorded at Official Record 639, page 1809, in Noble Township, Auglaize County, Ohio, in the south half of the southeast quarter of Section 8, Township 5 South, Range 4 East. Being more particularly described as follows:

Commencing for reference at an iron bar in a monument box at the southeast corner of said Section 8 -

Thence, North 00°12'45" West, along the east line of the southeast quarter of said Section 8 and the centerline of State Route 116, a distance of 1330.17 feet to a R.R. spike found -

Thence, South 89°26'43" West, along the north line of the south half of the southeast quarter of said Section 8, a distance of 554.73 feet to point. Said point being the place of beginning for the parcel of land to be conveyed by this instrument -

Thence, continuing, South 89°26'43" West, along the last described line, a distance of 329.08 feet to a 5/8 inch iron bar set -

Thence, South 00°12'45" East, a distance of 394.93 feet to a 5/8 inch iron bar set -

Thence, North 89°27'15" East, a distance of 329.07 feet to a 5/8 inch iron bar set -

Thence, North 00°12'45" West, passing through a 5/8 inch iron bar found at 365.07, a total distance of 394.98 feet to the place of beginning.

Containing 2.984 acre of land more or less.

The east line of the southeast quarter of said Section 8 was assumed to bear North 00°12'45" West in agreement with surveys by John Jauret, Professional Surveyor 6920 dated August 22, 1988 and Gordon Geeslin, Professional Surveyor 5372 dated April 23, 1996. Both surveys are on file in the County Engineer's Office.

Subject to all easements and right-of-way of record.

Reference is made to an actual field survey of this area by James W. Geeslin, Professional Surveyor 7764, dated March 25, 2019 and revised on April 15, 2019 and August 26, 2020. On file in the County Engineer's Office.

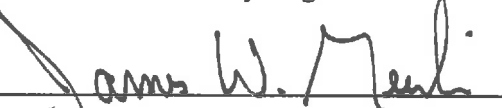

Attest: James W. Geeslin, P.S. No. 7764

**GEESLIN
LAND SURVEYING**

525 S. SECOND ST.
COLDWATER, OHIO 45828

PHONE: (419)678-7233
geeslinsurveying@gmail.com

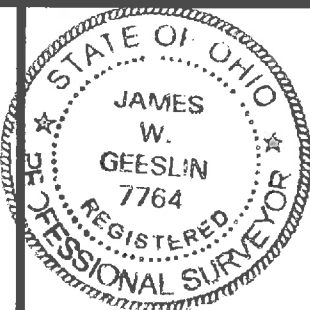

| | | | |
|-------------------------------|----------------------------|-------------------------|-------------------|
| PERMANENT PARCEL No. _____ | | | |
| Part of: _____ | Sec. _____ | T. _____ | R. _____ Township |
| Grantor: _____ | Area Retained: _____ Acres | | |
| Grantee: _____ | Area Retained: _____ Acres | | |
| Deed References: _____ | | | |
| APPROVALS: | | | |
| AGENCY: | Board of Health | Township Zoning Officer | County Engineer |
| DATE: _____ | | | |