

# BERNARD E. STROHM, JR. ESTATE SURVEY

Part of the N.E. Quarter and Part of the Northwest Quarter of Section 26,  
Town 5 South, Range 6 East, Duchouquet Township, Auglaize County, Ohio,  
being Parcel No. B05-026-002-00.

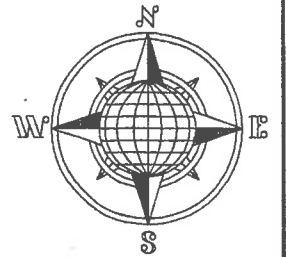

## LOCATION PLAN

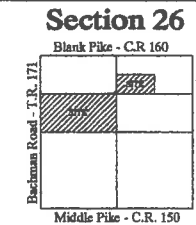

Duchouquet Township,  
T-5-S, R-6-E, Auglaize  
County, Ohio.

Basis of Bearing is the West Line  
of the Northeast Quarter of Section  
26, Duchouquet Township and  
the centerline of Township Road  
171 as N.00°44'53"E. from the Ohio  
State Plane - North Coordinate  
System NAD-83 (2011).

This Plat is Recorded in Survey  
Book U, page 224, in the Auglaize  
County Engineer's Office.

This Plat and the accompanying  
Legal Description represents an  
actual Boundary Survey completed  
by John W. Jauert, in November, 2020.

## LEGEND

- 5/8"x30" Iron Pin Set/Cap
- ⊗ Mag Nail Set
- Monument Box
- ⊙ 10" Wood Post Found
- ⊠ 12" Concrete Post Found

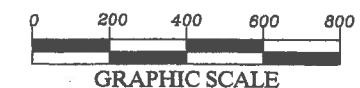

**Jauert**  
surveying

11584 Monroe Road  
Wapakoneta, Ohio  
45895  
(419) 657-6999

CLIENT: Bernard E. Strohm, Jr. Estate Survey		
COUNTY: Auglaize	TOWNSHIP: Duchouquet	SEC. 26
DRAWN BY: J.W.J.	SCALE: 1"=500'	DWG.# 20-4541
CHECKED BY:	DATE: November 2020	
SHEET 1 OF 2		(T-5-S; R-6-E)

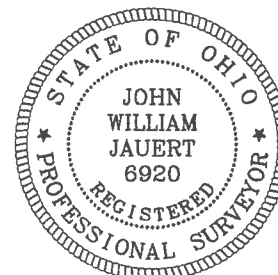

ATTEST:

John W. Jauert  
Professional Surveyor No. 6920

- John Jauert
- 11584 Monroe Road
- Wapakoneta, Ohio 45895



- Phone: (419) 657-6999
- FAX: (419) 657-2745
- E-Mail: jjsurvey@ohiolink.net

## BERNARD E. STROHM, JR. ESTATE SURVEY

### 100.157 ACRE TRACT

517

The following described tract of land is part of the Northeast and Northwest Quarters of Section 26, Town 5 South, Range 6 East, Duchouquet Township, Auglaize County, Ohio, being Parcel No. B05-026-002-00 and is more particularly described as follows:

The PLACE OF BEGINNING is at a Monument Box (found) at the Southwest corner of the Northwest Quarter of Section 26, Duchouquet Township and in the centerline of Township Road 171 (Bachman Road);

Thence N.00°44'53"E. along the West line of the Northwest Quarter of said Section 26 and along the centerline of Township Road 171, a distance of 1,327.13 feet to a Mag Nail (set);

Thence N.89°48'34"E. along the North line of the South one-half of the Northwest Quarter of said Section 26, a distance of 2,617.48 feet to a 5/8-inch iron pin (set), passing thru a 5/8-inch iron pin (set) for reference at 15.00 feet in the occupied right-of-way line of Township Road 171;

Thence N.45°12'57"E. a distance of 28.48 feet to a 5/8-inch iron pin (set);

Thence N.00°37'20"E. along the East line of the Northwest Quarter of Section 26, a distance of 643.96 feet to a 5/8-inch iron pin (set);

Thence N.89°45'58"E. a distance of 1,317.90 feet to a 5/8-inch iron pin (set);

Thence S.00°33'40"W. a distance of 664.42 feet to a 10-inch wood post (found);

Thence S.89°47'11"W. along the South line of the North one-half of the Northeast Quarter of said Section 26, a distance of 1,318.60 feet to a 5/8-inch iron pin (set);

Thence S.00°37'20"W. along the East line of the Northwest Quarter of said Section 26, a distance of 1,327.92 feet to a 12-inch concrete post (found) at the Southeast corner of the Northwest Quarter of said Section 26, Duchouquet Township;

Thence S.89°49'39"W. along the South line of the Northwest Quarter of Section 26, a distance of 2,640.39 feet to the Monument Box at the Southwest corner of the Northwest Quarter of said Section 26 which was the true PLACE OF BEGINNING.

Containing in all 100.517 Acres of which 0.457 acres are being used for highway purposes. The above described tract of land is also subject to all legal easements, restrictions and reservations, if any, of record or in use on said premises. Previous Deed Reference: O.R. 80, Page 142. This plat is recorded in Survey Book U, Page 224 in the Auglaize County Engineer's Office. Basis of bearings for this tract is holding the centerline of Township Road 171 and the West line of the Northwest Quarter of Section 26, Duchouquet Township as N.00°44'53"E. from the Ohio State Plane-North Coordinate System NAD83 (2011). This Plat and description was prepared from an actual field survey of the above premises by John W. Jauert, Professional Surveyor No. 6920 in November 2020.

ATTEST:

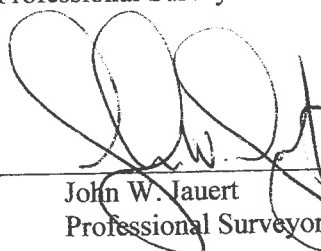
  
 John W. Jauert  
 Professional Surveyor No. 6920

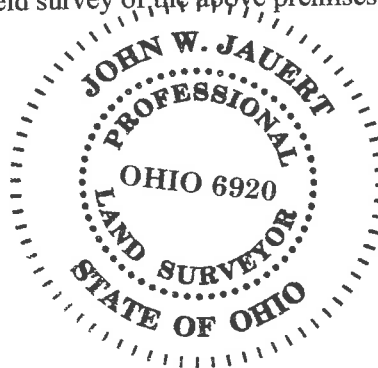

U-225