

ALLEMEIER - MADDEN SURVEY

Part of the Southeast Quarter of Section 14, Town 5 South,
Range 5 East, Moulton Township, Auglaize County, Ohio,
being Parcel No. G22-014-008-05.

G22-014-008-04
William & Mary Eisert
OR 165, Pg. 270
5.279 Acre

LOCATION PLAN

Section 14

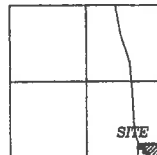

Moulton Township,
T-5-S, R-5-E, Auglaize
County, Ohio.

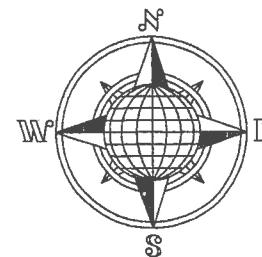

Basis of Bearing is the South Line
of the Southeast Quarter of Section
14, Moulton Township as S.88°35'37"E.
from the Ohio State Plane - North
Coordinate System NAD-83 (2011).

This Plat is Recorded in Survey
Book U, page 315, in the Auglaize
County Engineer's Office.

This Plat and the accompanying
Legal Description represents an
actual Boundary Survey completed
by John W. Jauert, in January, 2021.

PARCEL NO. 1
5.097 ACRE
0.052 Ac. R/W

PARCEL NO. 2
5.649 ACRE
0.058 Ac. R/W

LEGEND

- 5/8" x 30" Iron Pin Set/Cap
- 5/8" Iron Pin Found (Marbaugh)
- ⊗ Mag Nail Set
- ⊙ Mag Nail Found
- ⊕ Iron Pipe Found
- ▲ R.R. Spike Found
- Monument Box
- ⊗ Section Stone Found
- ⊙ 5/8" x 30" Iron Pin Set/Cap @
- ⊙ Obliterated R.R. Tie Post Found

Stone Found
S.E. Corner of the
S.E. Quarter of
Section 14, Moulton Twp.

SURVEY REFERENCE

B-325 -	R. Pion - 1976
C-79 -	T. Kuck - 1977
D-338 -	T. Kuck - 1978
F-42 -	T. Steinke - 1981
F-237 -	R. Morrsey - 1982
H-641 -	R. Morrsey - 1982
MOU-14-1 -	T. Schnell - 1994
L-275 -	K. Marbaugh - 1999
MOU-23-2 -	J. Kent - 2000
M-181 -	J. Jauert - 2001
O-68 -	T. Steinke - 2002
O-111 -	J. Jauert - 2002



GRAPHIC SCALE
1"=100'

ATTEST:

John W. Jauert
Professional Surveyor No. 6920

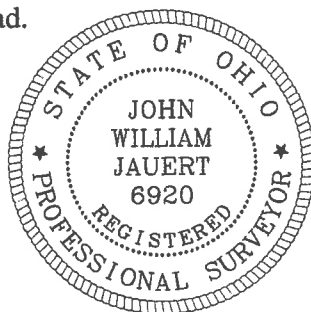

Jauert
surveying

11584 Monroe Road
Wapakoneta, Ohio
45895
(419) 657-6999

CLIENT: Jamie Lynn & Michael Shane Allemeier

COUNTY: Auglaize TOWNSHIP: Moulton SEC. 14

DRAWN BY: J.W.J. SCALE: 1"=100' DWG.# 20-4548

CHECKED BY: DATE: January 2021

SHEET 1 OF 5 (T-5-S; R-5-E)

U-315

- John Jauert
- 11584 Monroe Road
- Wapakoneta, Ohio 45895



- Phone: (419) 657-6999
- FAX: (419) 657-2745
- E-Mail: jjsurvey@ohiolink.net

ALLEMEIER - MADDEN SURVEY PARCEL 1 - 5.097 ACRE TRACT

The following described tract of land is part of the Southeast Quarter of Section 14, Town 5 South, Range 5 East, Moulton Township, Auglaize County, Ohio, being part of Parcel No. G22-014-008-05 and is more particularly described as follows:

Commencing at a Section Stone (found) at the Southeast corner of the Southeast Quarter of Section 14, Moulton Township;

Thence N.00°38'27"E. along the East line of the Southeast Quarter of said Section 14, a distance of 40.00 feet to an iron pipe (found) which is the PLACE OF BEGINNING for the tract of land herein described;

Thence N.88°35'37"W., parallel to and 40.00 feet North of the South line of the Southeast Quarter of Section 14, a distance of 270.00 feet to an iron pin (set);

Thence N.00°41'26"E. a distance of 359.79 feet to an iron pin (set);

Thence N.40°45'17"W. a distance of 163.98 feet to an iron pin (set);

Thence N.87°43'45"W. a distance of 239.52 feet to an iron pin (set);

Thence S.89°48'08"W. a distance of 433.53 feet to a Mag Nail (set), passing thru an iron pin (set) for reference at 403.28 feet in the East right-of-way line of County Road 117A (Buckland-River Road);

Thence N.07°09'38"E. along the centerline of County Road 117A, a distance of 75.54 feet to a Mag Nail (set);

Thence N.89°48'08"E., along the common property line of William and Mary Eisert and Jamie and Michael Allemeier, a distance of 1,042.54 feet to an iron pin (set), passing thru an iron pin (set) for reference at 30.25 feet in the East right-of-way line of County Road 117A and passing thru an iron pipe at 233.45 feet;

Thence S.00°38'27"W. along the East line of the Southeast Quarter of Section 14, a distance of 577.21 feet to the iron pipe (found), which was the true PLACE OF BEGINNING.

Containing in all 5.097 Acres of which 0.052 Acre has been used for highway purposes and being subject to all legal easements, restrictions and reservations, if any, of record or in use on said premises. Previous deed reference: Volume OR 697, Page 2979. This plat is recorded in Survey Book "U", Page 315, in the Auglaize County Engineer's Office. Basis for bearings for this tract is holding the South line of the Southeast Quarter of Section 14, Moulton Township as S.88°35'37"E. from the Ohio State Plane-North Coordinate System NAD83 (2011). This Plat and description was prepared from an actual field survey of the above premises by John W. Jauert, Professional Surveyor No. 6920 in January 2021.

ATTEST:

John W. Jauert
Professional Surveyor No. 6920

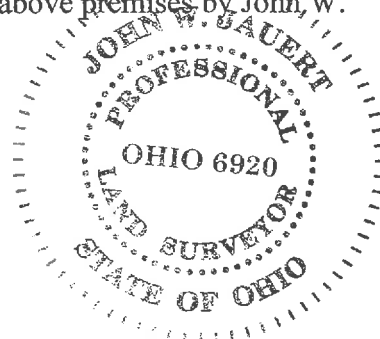

U-316

- John Jauert
- 11584 Monroe Road
- Wapakoneta, Ohio 45895



- Phone: (419) 657-6999
- FAX: (419) 657-2745
- E-Mail: jjsurvey@ohiolink.net

ALLEMEIER - MADDEN SURVEY PARCEL 2 - 5.649 ACRE TRACT

The following described tract of land is part of the Southeast Quarter of Section 14, Town 5 South, Range 5 East, Moulton Township, Auglaize County, Ohio, being part of Parcel No. G22-014-008-05 and is more particularly described as follows:

Commencing at a Section Stone (found) at the Southeast corner of the Southeast Quarter of Section 14, Moulton Township;

Thence N.00°38'27"E. along the East line of the Southeast Quarter of said Section 14, a distance of 40.00 feet to an iron pipe (found);

Thence N.88°35'37"W., parallel to and 40.00 feet North of the South line of the Southeast Quarter of Section 14, a distance of 270.00 feet to an iron pin (set) which is the PLACE OF BEGINNING for the tract of land herein described;

Thence continuing N.88°35'37"W. along the above described line, a distance of 404.45 feet to an iron pipe (found);

Thence N.00°38'42"E. a distance of 198.08 feet to an iron pipe (found);

Thence N.88°37'22"W. a distance of 144.49 feet to an iron pin (found);

Thence N.10°21'09"E. a distance of 155.04 feet to an iron pin (found);

Thence N.76°23'45"W. a distance of 83.48 feet to an iron pin (found);

Thence N.00°44'38"E. a distance of 61.59 feet to an iron pin (found);

Thence S.78°00'51"W. a distance of 191.60 feet to a Mag Nail (found), passing thru an iron pin (set) for reference at 159.84 feet in the East right-of-way line of County Road 117A (Buckland-River Road);

Thence N.07°09'38"E. along the centerline of County Road 117A, a distance of 87.25 feet to a Mag Nail (set);

Thence N.89°48'08"E. a distance of 433.53 feet to an iron pin (set), passing thru an iron pin (set) for reference at 30.25 feet in the East right-of-way line of County Road 117A and passing thru an iron pin (set) at 350.00 feet;

Thence S.87°43'45"E. a distance of 239.52 feet to an iron pin (set);

Thence S.40°45'17"E. a distance of 163.98 feet to an iron pin (set);

Thence S.00°41'26"W. a distance of 359.79 feet to the iron pin (set), which was the true PLACE OF BEGINNING.

Containing in all 5.649 Acres of which 0.058 Acre has been used for highway purposes and being subject to all legal easements, restrictions and reservations, if any, of record or in use on said premises. Previous deed reference: Volume OR 697, Page 2979. This plat is recorded in Survey Book "U", Page 315, in the Auglaize County Engineer's Office.

- John Jauert
- 11584 Monroe Road
- Wapakoneta, Ohio 45895



- Phone: (419) 657-6999
- FAX: (419) 657-2745
- E-Mail: jjsurvey@ohiolink.net

**ALLEMEIER - MADDEN SURVEY
PARCEL 2 - 5.649 ACRE TRACT, cont.**

Basis for bearings for this tract is holding the South line of the Southeast Quarter of Section 14, Moulton Township as S.88°35'37"E. from the Ohio State Plane-North Coordinate System NAD83 (2011). This Plat and description was prepared from an actual field survey of the above premises by John W. Jauert, Professional Surveyor No. 6920 in January 2021.

ATTEST:

A handwritten signature in black ink, appearing to read 'John W. Jauert', is written over a horizontal line.

John W. Jauert
Professional Surveyor No. 6920



- John Jauert
- 11584 Monroe Road
- Wapakoneta, Ohio 45895



- Phone: (419) 657-6999
- FAX: (419) 657-2745
- E-Mail: jjsurvey@ohiolink.net

ALLEMEIER - MADDEN SURVEY EASEMENT AREA - 0.333 ACRE TRACT

The following described tract of land is part of the Southeast Quarter of Section 14, Town 5 South, Range 5 East, Moulton Township, Auglaize County, Ohio, being part of Parcel No. G22-014-008-05 and is more particularly described as follows:

Commencing at a Monument Box (found) at the intersection of the centerline of County Road 117A (Buckland-River Road) and the South line of the Southeast Quarter of Section 14, Moulton Township;

Thence N.02°29'48"E. along the centerline of County Road 117A, a distance of 89.51 feet to a R.R. Spike (found);

Thence N.07°09'38"E. along the centerline of County Road 117A, a distance of 425.44 feet to a Mag Nail (set) which is the PLACE OF BEGINNING for the tract of land herein described;

Thence continuing N.07°09'38"E. along the above described line, a distance of 50.41 feet to a point;

Thence N.89°48'08"E. a distance of 229.91 feet to an iron pin (set);

Thence S.66°26'49"E. a distance of 124.14 feet to an iron pin (set);

Thence S.89°48'08"W. a distance of 350.00 feet to the Mag Nail (set), passing thru an iron pin (set) for reference at 319.75 feet in the East right-of-way line of County Road 117A, said Mag Nail was the true PLACE OF BEGINNING.

Containing in all 0.333 Acres of which 0.034 Acre has been used for highway purposes and being subject to all legal easements, restrictions and reservations, if any, of record or in use on said premises. This 0.333 Acre easement is expressly for the purpose of ingress-egress access for the adjacent 5.676 Acre tract (Parcel No. 2). Previous deed reference: Volume OR 697, Page 2979. This plat is recorded in Survey Book "U", Page 315, in the Auglaize County Engineer's Office. Basis for bearings for this tract is holding the South line of the Southeast Quarter of Section 14, Moulton Township as S.88°35'37"E. from the Ohio State Plane-North Coordinate System NAD83 (2011). This Plat and description was prepared from an actual field survey of the above premises by John W. Jauert, Professional Surveyor No. 6920 in January 2021.

ATTEST: _____

John W. Jauert
Professional Surveyor No. 6920



U-319