

ARDLE - MORRIS SURVEY

Part of the Southeast Quarter of Section 36, Town 4 South,
Range 6 East, Duchouquet Township, Auglaize County, Ohio,
being part of Parcel No. B05-036-034-02.

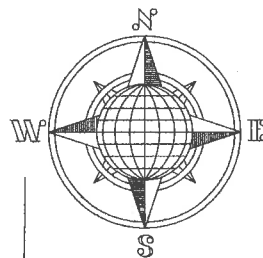

LOCATION PLAN

Section 36

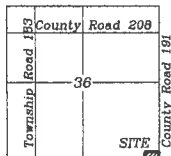

Duchouquet Township,
T-4-S, R-6-E, Auglaize
County, Ohio.

Basis of Bearing is the East Line of the
Southeast Quarter of Section 36, Duchouquet
Township and the Centerline of County Road
191, Townline-Lima Road as N.00°42'52"E.
from the Ohio State Plane - North
Coordinate System NAD-83 (2011).

This Plat is Recorded in Survey
Book U, page 538, in the Auglaize
County Engineer's Office.

This Plat and the accompanying
Legal Description represents an
actual Boundary Survey completed
by John W. Jauert, in October, 2021.

Leaving 7.253± Acre left out of the
Original 8.961 Acre Tract.
Parcel No. B05-036-034-02.

SURVEY REFERENCE

J-288 -	Kuck & Morrissey - 1992
J-289 -	Kuck & Morrissey - 1992
O-382 -	R. Tschanz - 1992
O-386 -	Kohli & Kaliher - 1992
S-255 -	S. Fox - 2015
P-636 -	J. Kent - 2007
Q-100 -	J. Kent - 2007

LEGEND

○	5/8" x 30" Iron Pin Set/Cap
●	5/8" Iron Pin Found
⊗	3/4" Iron Pipe Found
⊙	Mag Nail Set
■	Monument Box

County Road 183
(Mudsock Road)

5/8" Pin Found @
0.2' E. & 0.13' N.
of Corner.

B05-036-034-01
Daniel E. Martin
OR 675, Pg. 2524
9.765 Acre
O - 382

3,582.02'
N.89°18'22"W.

5/8" Pin Found @
0.5' S. & 0.11' W. of Corner.

1/2" Pin Found @
0.12' W. & 0.32' S.
of Corner.

B05-036-034-02
R.W. & P.S. Ardle
OR 644, Pg. 339
8.961 Acre
O - 382

B05-001-021-02
C. Buell & J. Schroeder
OR 491, Pg. 228
13.975 Acre
J - 288, J - 289

N.02°08'20"E.

241.37'

3/4" Pipe Found @
40.15' W. of CL
(Kohli & Kaliher)

1.438 ACRE
0.089 Ac. R/W

5/8" Pin Found @
30' W. of CL

Monument Box Found
S.E. Corner of the
S.E. Quarter of
Section 36, Duchouquet Twp.

North Line, S.E. 1/4, Section 36, Duchouquet Twp.

Monument Box Found
N.E. Corner of the
S.E. Quarter of
Section 36, Duchouquet Twp.

Duchouquet Township
Section 36

AUGLAIZE COUNTY

1,988.82'

N.00°42'52"E.

215.25'

N.00°42'52"E.

ALLEN COUNTY

Perry Township
Section 31

50.00'

N.00°42'52"E.

25' R/W Line

S.00°42'52"W.

241.30'

E. Line, S.E. 1/4, Sec. 36, Duchouquet Twp.

241.30'

S.00°42'52"W.

156.49'

S.00°42'52"W.

Allen County
POB Perry Township

Union Township
Auglaize County

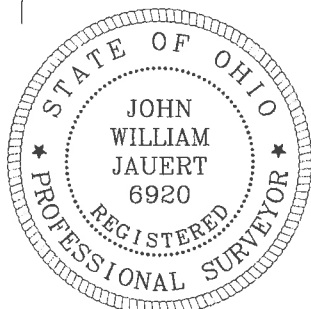

ATTEST:

John W. Jauert
Professional Surveyor No. 6920



Jauert
surveying

11584 Monroe Road
Wapakoneta, Ohio
45895
(419) 657-6999

CLIENT: Robert W. Ardle

COUNTY: Auglaize TOWNSHIP: Duchouquet SEC. 36

DRAWN BY: J.W.J. SCALE: 1"=100' DWG.# 21-4620

CHECKED BY: DATE: October 2021

SHEET 1 OF 2

(T-4 -S; R-6 -E)

U-538

- John Jauert
- 11584 Monroe Road
- Wapakoneta, Ohio 45895.



- Phone: (419) 657-6999
- FAX: (419) 657-2745
- E-Mail: jjsurvey@ohiolink.net

ARDLE - MORRIS SURVEY 1.438 ACRE TRACT

The following described tract of land is part of the Southeast Quarter of Section 36, Town 4 South, Range 6 East, Duchouquet Township, Auglaize County, Ohio, being part of Parcel No. B05-036-034-02 and is more particularly described as follows:

The PLACE OF BEGINNING is at a Monument Box (found) at the Southeast corner of the Southeast Quarter of Section 36, Duchouquet Township and in the centerline of County Road 191 (Townline-Lima Road;

Thence N.89°18'22"W. along the South line of the Southeast Quarter of said Section 36, a distance of 400.00 feet to a 5/8-inch iron pin (set), passing thru a 5/8-inch iron pin (set) for reference at 25.00 feet in the West right-of-way line of County Road 191;

Thence N.00°42'52"E., parallel to the East line of the Southeast Quarter of Section 36 and the centerline of County Road 191, a distance of 156.80 feet to a 5/8-inch iron pin (set);

Thence S.89°15'42"E. a distance of 400.00 feet to a Mag Nail (set) in the centerline of County Road 191 and the East line of the Southeast Quarter of said Section 36, passing thru a 5/8-inch iron pin (set) for reference at 375.00 feet in the West right-of-way line of County Road 191;

Thence S.00°42'52"W., along the East line of the Southeast Quarter of said Section 36 and the centerline of County Road 191, a distance of 156.49 feet to the Monument Box (found), which was the true PLACE OF BEGINNING.

Containing in all 1.438 Acres of which 0.089 Acre has been used for highway purposes. The above described tract of land is subject to all legal easements, restrictions and reservations, if any, of record or in use on said premises. Previous Deed Reference: Volume OR 644, Page 339. This plat is recorded in Survey Book "U", Page 538, in the Auglaize County Engineer's Office. Basis for bearings for this tract is holding the centerline of County Road 191 and the East line of the Southeast Quarter of Section 36, Duchouquet Township as N.00°42'52"E. from the Ohio State Plane-North Coordinate System NAD83 (2011). This Plat and description was prepared from an actual field survey of the above premises by John W. Jauert, Professional Surveyor No. 6920 in October 2021.

ATTEST:

John W. Jauert
Professional Surveyor No. 6920

