

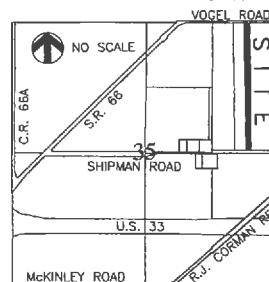

Being a part of the Northeast Quarter of Section 35,
Noble Township, Town-5-South, Range-4-East, Auglaize County,
and is a split out of Permanent Parcel #H23-035-010-01
Containing 1.000 ACRE (0.008 Ac R/W)

LOCATION



I do hereby Attest that this Survey and Plat as recorded is a true and accurate representation of the measurements taken under my direct supervision on the 15th day of January, 2022. Permanent monumentation to be set within 60 days

Ted K. Schell

A circular professional engineer seal for the State of Ohio. The outer ring contains the text "STATE OF OHIO" at the top and "REGISTERED PROFESSIONAL ENGINEER" at the bottom, separated by two stars. The inner circle contains the name "TED KEVIN SCHNELL" and the registration number "51963".



NOTE: The bearings used for this Survey were assumed from previous surveys performed by Gordon Geeslin (PS #5372) per Survey Book L, Page 566, and by James Geeslin (PS #7764) per Survey Book P, Page 303, whereas the North line of the Northeast Quarter of Section 35, Noble Township, and the legal centerline of Vogel Road (C.R. #150), was assumed to bear S. 89°-32'-18" W.

N. 89°-52'-21" W.
16.68'

SE Corner
East half
NE 1/4
Sec 35
- Noble Twp

SCALE



(1) Reference is made to Survey NOB-35-6 and Survey NOB-35-7 which show certain notations and details that are not specifically shown on this survey plat, but should be used as a reference for explanations of specific discrepancies found in other prior surveys of record that were performed contiguous to the south line of Section 35, Noble Township.

(2) This 1.000 Acre parcel split is intended to be an "Add-on" to Parcel number H23-035-010-02.

SW Corner
East half
NE 1/4
Sec 35
Noble Twp

City of St. Marys (Parcel A as shown)
Parcel H23-035-010-03
Vol OR 715 Pg 5664

City of St. Marys (Parcel B as shown)
Parcel H23-035-010-04
Vol OR 715 Pg 5666

This Survey Plat and Description is Recorded in Survey Book U, Page 609, Auglaize County Map Office

Ted K. Schnell P.E., P.S.

913 Fieldstone Court Wapakoneta, Ohio 45895

GERALD FREEWALT
client

35
sect

NOBLE
township

AUGLAIZE
county

OHIO
state

JAN 15, 2022
date



Ted K. Schnell PE, PS
913 Fieldstone Court
Wapakoneta, Ohio 45895
Phone (419) 230-7896
e-mail: kschnell7216@gmail.com



SURVEYOR'S DESCRIPTION

1.000 ACRE PARCEL SPLIT (Add-on)

The following described parcel of land is a part of the Northeast Quarter of Section 35, Noble Township, Town-5-South, Range-4-East, Auglaize County, Ohio, and is more particularly described as follows:

Commencing for reference at a Monument Box situated at the Northeast corner of the Northeast Quarter of said Section 35, Noble Township, Town-5-South, Range-4-East;

Thence with an assumed bearing of S. 89°-32'-18" W. along the North line of the Northeast Quarter of said Section 35, and the legal centerline of Vogel Road (County Road #150), for a distance of 622.34 feet to a Mag Nail (set) and the PLACE OF BEGINNING;

Thence with a bearing of S. 00°-40'-02" E. for a distance of 2,612.46 feet to an Iron Pin (set);

Thence with a bearing of N. 89°-52'-21" W. parallel to and 40.00 feet North of the South line of the East half of the Northeast Quarter of said Section 35, for a distance of 16.68 feet to an Iron Pin (found);

Thence with a bearing of N. 00°-40'-02" W. for a distance of 2,612.29 feet to a Railroad Spike (found);

Thence with a bearing of N. 89°-32'-18" E. along the North line of the Northeast Quarter of said Section 35, and the legal centerline of Vogel Road (County Road #150), for a distance of 16.68 feet to a Mag Nail (set) and the original PLACE OF BEGINNING.

Containing in all 1.000 Acre of land, of which, 0.008 Acre being previously dedicated for highway purposes. The above described parcel of land is subject to any or all legal easements, reservations, or deed restrictions, if any, upon said premises.

This 1.000 Acre parcel is being split out of permanent parcel #H23-035-010-01. Previous Deed References: Deed Volume OR 463, Page 2175.

The basis of bearings used for this description were assumed from previous surveys of record performed by Gordon Geeslin (PS #5372) per Survey Book L, Page 566, and by James Geeslin (PS #7764) per Survey Book P, Page 303, Auglaize County Engineer's Map Office, whereas the North line of the Northeast Quarter of Section 35, Noble Township, and the legal centerline of Vogel Road (County Road #150) was assumed to have a bearing of S. 89°-32'-18" W.

(continued)

The above described 1.000 Acre parcel of land is not intended to be used as a building site, but is intended to be an "Add-on" to Parcel H23-035-010-02 as referenced by Deed Volume OR 530, Page 150.

This legal description was prepared from an actual field survey performed by Ted K. Schnell, Professional Land Surveyor #7216, on January 15th, 2022. A survey plat of this field survey is recorded with the Auglaize County Engineer's Map Office. See Survey Book U, Page 609.

Prepared By:

Ted K. Schnell

Ted K. Schnell
Professional Engineer 51963 (Ohio)
Professional Surveyor 7216 (Ohio)

