

A north arrow pointing upwards, labeled 'N' at the bottom. Below the arrow is a graphic scale bar with markings at 80, 40, 0, and 80. The text 'SCALE: 1" = 80\'' is centered above the bar, and 'GRAPHIC SCALE' is centered below it.

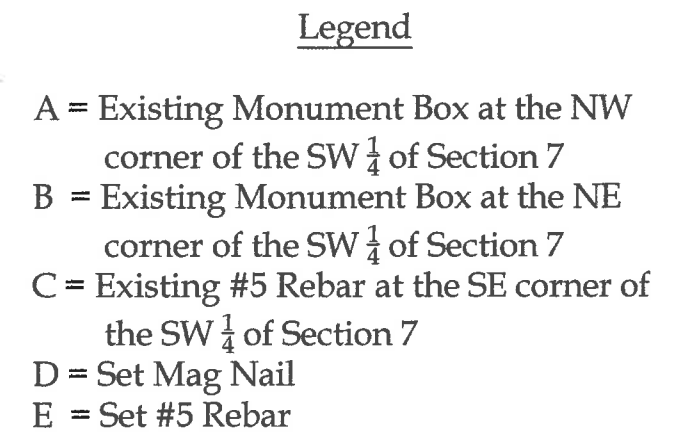

This plat and the accompanying legal description represents an actual boundary survey completed under my direct supervision on March 09, 2022.



Kyle J. Binkley, P.S. #8587



CLIENT:			
Robert Harrod			
SURVEYED BY:		DATE:	DRAWN BY:
T.J.S./T.E.W.		03-09-2022	K.J.B.
SCALE:		CHECKED BY:	
1" = 80'		K.J.B.	
		PAGE	PAGES
		1	2

This plat is recorded in Survey Book "U", Page 660, in the Auglaize County Engineer's Office.

LEGAL DESCRIPTION

Being a part of Parcel #125-007-003-01 and being a part of the SW ¼ of Section 7, Town 6 South, Range 6 East, Pusheta Township, Auglaize County, Ohio (Prior Deed Referenced in O.R. 711, Pg. 4354), more particularly described as follows:

Beginning at an existing Monument Box at the NE corner of the SW ¼ of Section 7; thence the following courses:

- 1. S 01°-09'-43" W with the E line of the SW ¼ of Section 7, 300.00' to a set #5 Rebar, passing a set #5 Rebar at 20.00';
- 2. N 89°-03'-35" W, 300.00' to a set #5 Rebar;
- 3. N 01°-09'-43" E, 300.00' to a Mag Nail set on the N line of the SW ¼ of Section 7 (centerline of Owl Creek Road), passing a set #5 Rebar at 280.00';
- 4. S 89°-03'-35" E with said fractional section line, 300.00' to the POINT OF BEGINNING.

The above described parcel contains 2.066 acres, more or less, of which 0.138 acres are occupied by road right-of-way, subject to all legal highways and easements of record.

The system of bearings for this legal description is based on Ohio State Plane – North Coordinate System NAD83 (2011). This legal description and accompanying plat represent an actual boundary survey completed under the direct supervision of Kyle J. Binkley, P.S. #8587 on March 09, 2022. All markers called for above are in place.

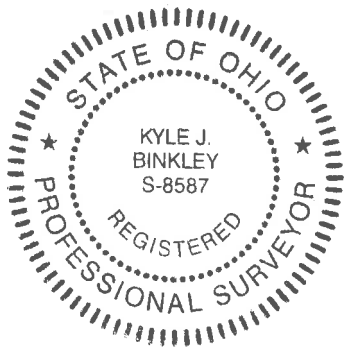

A handwritten signature in black ink, appearing to read "K. Binkley", positioned to the right of the professional seal.