

(Prior Deed Referenced in O.R. 672, Pg. 2673)

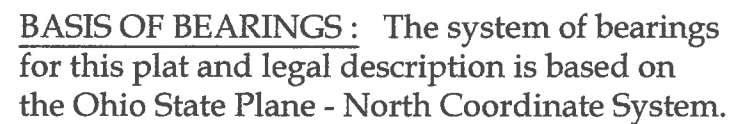

E = Set Mag Nail

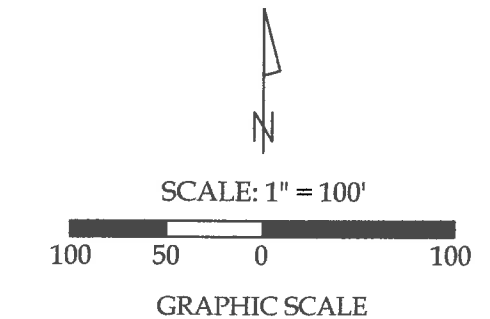

This plat and the accompanying legal descriptions represent an actual boundary survey completed under my direct supervision on October 03, 2022.



Kyle J. Binkley, P.S.#8587



CLIENT:			
Scott & Lara Hayes			
SURVEYED BY:		DATE:	CHECKED BY:
T.J.S./T.E.W.		10-03-2022	K.J.B.
SCALE:		PAGE	PAGES
1" = 100'		1	2

U-849

LEGAL DESCRIPTION

Being a part of Parcel #L34-011-003-00 and being a part of the SW ¼ of Section 11, Town 5 South, Range 7 East, Union Township, Auglaize County, Ohio (Prior Deed Referenced in O.R. 672, Pg. 2673), more particularly described as follows:

Beginning at an existing Monument Box at the SW corner of Section 11; thence the following courses:

- 1. N 00°-49'-42" E with the W line of the SW ¼ of Section 11 (centerline of Wrestle Creek Road), 669.27' to a set Mag Nail;
- 2. S 89°-10'-45" E, 410.52' to a set #5 Rebar, passing a set #5 Rebar at 25.00';
- 3. S 00°-49'-42" W, 669.27' to a Mag Nail set on the S line of the SW ¼ of Section 11 (centerline of Fairmount Road), passing a set #5 Rebar at 644.27';
- 4. N 89°-10'-45" W with said fractional section line, 410.52' to the POINT OF BEGINNING.

The above described parcel contains 6.307 acres, more or less, of which 0.605 acres are occupied by road right-of-way, subject to all legal highways and easements of record.

The system of bearings for this legal description is based on Ohio State Plane – North Coordinate System NAD83 (2011). This legal description and accompanying plat represent an actual boundary survey completed under the direct supervision of Kyle J. Binkley, P.S. #8587 on October 03, 2022. All markers called for above are in place.



A handwritten signature in black ink, appearing to read "K. Binkley", positioned to the right of the professional seal.