

C.E. & D.A. RANDALL SURVEY

Being part of the Northwest Quarter of Section 24,
T-5-S, R-6-E, Duchouquet Township, Auglaize County
Ohio, and part of Parcel No. B05-024-002-01.

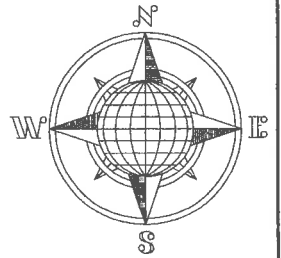

NOTES:

Basis of Bearing is the legal centerline of
Blackhoof Creek Road, Township Road 166
as S.89°31'49"E. based on the Ohio State Plane
North Coordinate System NAD-83 (2011).

This Plat is Recorded in Survey Book
"U", Page 950, in the Auglaize County
Engineer's Office.

This Plat and the accompanying Legal
Description represents an actual Boundary
Survey completed by me, John W. Jauert,
P.S. No. 6920 in March 2023.

Leaving 104.127± Acre left out of the
Original 106.128 Acre tract.

LOCATION PLAN

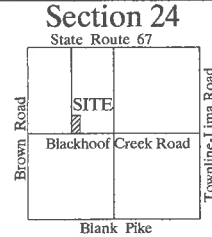

Duchouquet Township,
T-5-S, R-6-E, Auglaize
County, Ohio.

SURVEY REFERENCE

DUC-24-1 - J. Jauert - 1999
O-602 - J. Kent - 2004
DUC-24-2 - J. Jauert - 2006

B05-024-001-01
Bailey Family Farm LLC
Deed: Vol. OR 645, Pg. 78
70.913 Acre
DUC-24-1

Monument Box Found
S.W. Corner,
N.W. Quarter,
Section 24

Township Road 181 (Brown Road)

2,655.34'

N.00°58'00"E.

20' R/W Line

16.5' R/W Line
1,329.29'

S.89°31'49"E.

Township Road 166
(Blackhoof Creek Road)

West line, East 1/2, N.W. 1/4, Sec. 24

N.01°00'02"E.

435.84'

B05-024-002-01
C.E. & D.A. Randall
Deed: Vol. OR 674, Pg. 992 & 996
106.128 Acre

S.89°31'49"E.
200.00'

2.001 ACRE
0.115 AC R/W

B05-024-002-01
C.E. & D.A. Randall
Deed: Vol. OR 674, Pg. 992 & 996
106.128 Acre

(Reference pins set at 20.00')
25' R/W Line

200.00'

N.89°31'49"W.
South line, N.W. 1/4, Section 24

435.84'

S.01°00'02"W.

East line, N.W. 1/4, Sec. 24

Monument Box Found
S.E. Corner,
N.W. Quarter,
Section 24

LEGEND

- Iron Pin Set
- ⊗ Mag Nail Set
- Monument Box Found

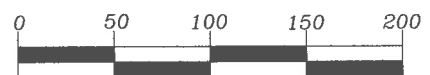

GRAPHIC SCALE



ATTEST:

John W. Jauert
Professional Surveyor No. 6920

Jauert
surveying

11584 Monroe Road
Wapakoneta, Ohio
45895
(419) 657-6999

CLIENT: CARLTON & DEBORAH RANDELL
COUNTY: Auglaize TOWNSHIP: Duchouquet SEC. 24
DRAWN BY: J.W.J. SCALE: 1"=100' DWG.# 23-4698
CHECKED BY: DATE: March 2023
SHEET 1 OF 2 (T-5-S; R-6-E)

U-950

- John Jauert
- 11584 Monroe Road
- Wapakoneta, Ohio 45895



- Phone: (419) 657-6999
- FAX: (419) 657-2745
- E-Mail: jjsurvey@ohiolink.net

CARLTON & DEBORAH RANDALL SURVEY 2.001 ACRE TRACT

The following described tract of land is part of the Northwest Quarter of Section 24, Town 5 South, Range 6 East, Duchouquet Township, Auglaize County, Ohio, being part of Parcel No. B05-024-002-01 and is more particularly described as follows:

Commencing at a Monument Box (found) at the Southwest corner of the Northwest Quarter of Section 24, Duchouquet Township and in the centerline of Township Road 166 (Blackhoof Creek Road;

Thence S.89°31'49"E. along the South line of the Northwest Quarter of said Section 24 and along the centerline of Township Road 166, a distance of 1,329.29 feet to a Mag Nail (set) which is the PLACE OF BEGINNING for the tract of land herein described;

Thence N.01°00'02"E. along the West line of the East ½ of the Northwest Quarter of said Section 24, a distance of 435.84 feet to a 5/8-inch iron pin (set), passing thru a 5/8-inch iron pin (set) for reference at 20.00 feet;

Thence S.89°31'49"E., parallel to the South line of the Northwest Quarter of Section 24 and the centerline of Township Road 166, a distance of 200.00 feet to a 5/8-inch iron pin (set);

Thence S.01°00'02"W. a distance of 435.84 feet to a Mag Nail (set), passing thru a 5/8-inch iron pin (set) for reference at 415.84 feet;

Thence N89°31'49"W. along the Centerline of Township Road 166 and the South line of the Northwest Quarter of Section 24, a distance of 200.00 feet to the Mag Nail (set) which was the true PLACE OF BEGINNING.

Containing in all 2.001 Acre of which 0.115 Acre has been used for highway purposes. The above described tract of land is subject to all legal easements, restrictions and reservations, if any, of record or in use on said premises. Previous deed reference: Volume OR 674, Page 992 & 996. This plat is recorded in Survey Book "U", Page 950, in the Auglaize County Engineer's Office. Basis for bearings for this tract is holding the centerline of Township Road 166 (Blackhoof Creek Road) and the South line of the Northwest Quarter of Section 24, Duchouquet Township as S.89°31'49"E. from the Ohio State Plane-North Coordinate System NAD83 (2011). This Plat and description was prepared from an actual field survey of the above premises by John W. Jauert, Professional Surveyor No. 6920 in March 2023.

ATTEST:

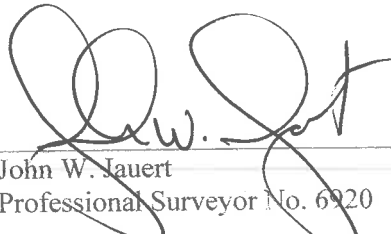
John W. Jauert
Professional Surveyor No. 6920

