

VICINITY MAP
NO SCALE

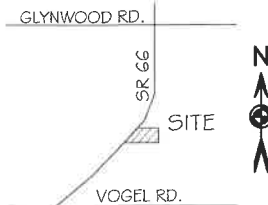

DOUGLAS & CONNIE LEFFEL SURVEY

S.E. 1/4 SEC. 26, T 5S, R 4E
NOBLE TWP., AUGLAIZE COUNTY, OH
PAR #H2302600702

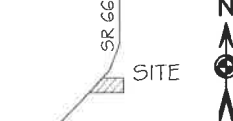

VOGEL RD.

GLYNWOOD RD.

SK 66

SITE

VOGEL RD.

SK 66

SITE

VOGEL RD.

SK 66

SITE

VOGEL RD.

SK 66

SITE

VOGEL RD.

SK 66

SITE

VOGEL RD.

SK 66

SITE

VOGEL RD.

SK 66

SITE

VOGEL RD.

SK 66

SITE

VOGEL RD.

SK 66

SITE

VOGEL RD.

SK 66

SITE

VOGEL RD.

SK 66

SITE

VOGEL RD.

SK 66

SITE

VOGEL RD.

SK 66

SITE

VOGEL RD.

SK 66

SITE

VOGEL RD.

SK 66

SITE

VOGEL RD.

SK 66

SITE

VOGEL RD.

SK 66

SITE

VOGEL RD.

LEGEND

- 5/8x30" IRON PIN (SET) W/ PINK PLASTIC CAP STAMPED "LOCK TWO 7988"
- MAG NAIL (SET)
- IRON PIN (FOUND)
- CONCRETE RIW MONUMENT (FOUND)
- A.C.E.O. MONUMENT BOX W/ P
- FENCE POST (FOUND)

SURVEY REFERENCES

O.D.O.T. R/W PLANS AUG~66
(11.88-12.51) (14.14)
SUR. BOOK K PG. 690
SUR. BOOK N PG. 837
SUR. BOOK S PG. 633

F.E.M.A.

FLOOD INSURANCE NOTE: BY GRAPHICS PLOTTING ONLY, THIS PROPERTY IS IN ZONE "X" OF THE FLOOD INSURANCE RATE MAP, COMMUNITY PANEL NO. 39011CO080C EFFECTIVE DATE OF 9/06/1989. EXACT DESIGNATIONS CAN ONLY BE DETERMINED BY AN ELEVATION CERTIFICATE. BASED ON THE ABOVE INFORMATION, THIS PROPERTY "IS NOT" IN A SPECIAL FLOOD HAZARD AREA.

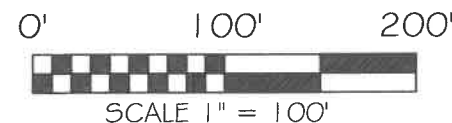

BASIS OF BEARING: BEARINGS ARE OHIO DEPARTMENT OF TRANSPORTATION V.R.S. OHIO STATE PLANE NORTH ZONE, 3401, NAD 83, (2011 ADJ) GRID. DISTANCES SHOWN ARE GROUND.



NEW DIVISION LINE
N 88°31'43" W 1364.35'

DOUGLAS DEAN LEFFEL & CONNIE ANN LEFFEL
O.R. 641 PG. 221
5.001 ACRES TOTAL
0.229 ACRES R/W
4.772 ACRES NET

DOUGLAS DEAN LEFFEL
& CONNIE ANN LEFFEL
O.R. 641 PG. 221
37.358 ACRES
5.001 ACRES THIS SURVEY
32.357 ACRES REMAINING

CHRISTOPHER S. HARMON P.S. #7988

SURVEY NOTE:
I HEREBY STATE THAT THIS IS A TRUE AND ACCURATE SURVEY AS PERFORMED BY MYSELF. ALL ADJOINING OWNERS, MONUMENTS AND THERE CONDITION ARE CURRENT AS OF THE TIME THE FIELD WORK WAS PERFORMED IN AUGUST, 2023 AND DONE WITHOUT THE BENEFIT OF A TITLE SEARCH.



9/11/23
DATE

FILED IN SURVEY BOOK "V", PAGE 70 IN THE
AUGLAIZE COUNTY TAX MAP OFFICE.

LOCK-TWO SURVEYING
5166 LOCK TWO RD. NEW BREMEN, OH
419-753-3332



LOCKTWO SURVEYING@NKTCLCO.NET

#23051

Lock Two Surveying, LLP.

5166 Lock Two Rd.
New Bremen, Oh 45869
419-753-3332

Cell: Jenny Saintignon 419-733-9606
Chris Harmon P.S. 419-733-9607

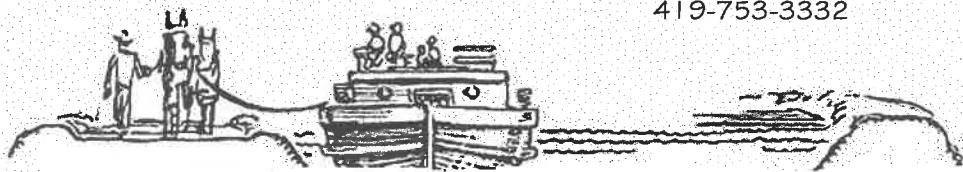

DOUGLAS & CONNIE LEFFEL SURVEY
PT. PARCEAL #H2302600702
5.001 ACRES

SITUATE IN THE SOUTHEAST QUARTER OF SECTION 26, TOWN 5S, RANGE 4E NOBLE TOWNSHIP, AUGLAIZE COUNTY OHIO, PART OF THOSE LANDS OWNED BY CONNIE ANN AND DOUGLAS DEAN LEFFEL AS RECORDED IN OFFICIAL RECORD 641 PAGE 221 AND BEING MORE PARTICULARLY DESCRIBED AS FOLLOWS:

Beginning for reference at an Auglaize County Engineers Office Monument Box found at the southeast corner of the southeast quarter of Section 26 and being in the center of Vogel Rd.;

Thence, with the east line of the southeast quarter of Section 26, North $01^{\circ}27'36''$ East, 606.49 feet to an iron pin set, said iron pin marking the **True Point of Beginning** of the tract herein described;

Thence, with a new division line, North $88^{\circ}31'43''$ West, 1364.35 feet to a Mag Nail set in the centerline of State Route 66, Station 741+55.74, passing at 1307.97 feet an iron pin set in the east right of way line of State Route 66, Station 741+95.48, 40' Right;

Thence, with the centerline of State Route 66, North $46^{\circ}16'53''$ East, 239.93 feet to a Mag Nail found, Station 743+95.67, at the southwest corner of a 5.032 acre tract of land owned by Derek D. Leffel & Luke L. Leffel $\frac{1}{2}$ interest as recorded in Official Record 689 Page 1153;

Thence, with the south line of said 5.032 acre tract, South $88^{\circ}31'43''$ East, 1195.23 feet to an iron pin with "Lock Two" cap found in the west line of the southwest quarter of Section 25 and the west line of a 51.99 acre tract of land owned by Gregory L. Leffel & Joan E. Leffel and Douglas Dean Leffel & Connie Ann Leffel as recorded in Official Record 613 Page 799, passing for reference at 60.90 feet an iron pin with "Lock Two" cap found;

Thence, with the west line of the southwest quarter of Section 25 and the west line of said 51.999 acre tract, South $01^{\circ}27'36''$ West, 170.22 feet to the **True Point of Beginning**, containing 5.001 acres more or less of which 0.229 acres lie within the right of way of State Route 66 and being subject to all legal rights of ways easements, agreements and restrictions of record.

Basis of bearings is based on the Ohio Department of Transportation V.R.S., Ohio State Plane North Zone 3401, NAD 83(2011ADJ). Stationing list hereon is per Ohio Department of Transportation right of way Plans AUG-66-11.88, Sheet 184 of 189. The Official Records and Deed Volumes are all recorded in Auglaize County Recorder's Office. Pins noted as set are $\frac{5}{8}$ " x 30" re-bar with pink plastic caps stamped "Lock-Two 7988".

The above description was prepared by Lock-Two Survey, LLP from a survey performed by Christopher S. Harmon, Professional Surveyor #7988 in August of 2023 and filed in **Survey Book "V" Page 70** of the Auglaize County Tax Map Office.

Christopher S. Harmon P.S. #7988

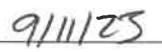

Date