

# TURKEY RIBS, INC., etal

Being part of the West 1/2 of the Southeast 1/4 of Section 14,  
Town 6 South, Range 4 East, St. Marys Township, Auglaize  
County, Ohio, and being part of Parcel No. K30-141-002-00.

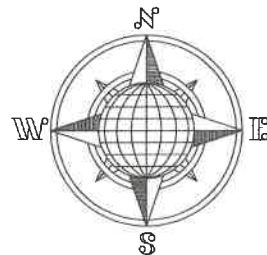

K30-141-002-00  
Turkey Ribs, Inc.  
Deed: Vol. OR 625, Pg. 1627  
67.339 Acre

K30-141-003-01  
Turkey Ribs, Inc. &  
Jay L. & Cheryl Kuck  
Deed: Vol. OR 660, Pg. 1183  
65.406 Acre

Monument Box Fd.  
N.E. Corner,  
S.E. Quarter,  
Section 14

## LOCATION PLAN



**12.207 ACRE**  
**0.270 Ac. R/W**  
(ADD ON)

K30-141-002-00  
Turkey Ribs, Inc.  
Deed: Vol. OR 625, Pg. 1627  
67.339 Acre

K30-141-003-02  
Turkey Ribs, Inc.  
Deed: Vol. OR 724, Pg. 125 & 4039  
7.621 Acre  
"U"-935, V-42

K30-141-003-03  
Jay L. & Cheryl Kuck  
Deed: Vol. OR 724, Pg. 127  
5.000 Acre  
"U"-935

K30-141-002-01  
David & Debra Lauth  
Deed: Vol. OR 59, Pg. 319  
12.04 Acre - N-112

S.88°55'39"E.  
704.93'

Monument Box Fd.  
S.W. Corner,  
S.E. Quarter,  
Section 14

Basis of Bearing is the centerline of Township Road  
110 and the South line of the S.E. 1/4 of Section  
14 as S.89°55'39"E. based on the Ohio State Plane  
North Coordinate System NAD-83 (2011).

This Plat is Recorded in Survey Book "V", Page  
195 in the Auglaize County Engineer's Office.

This Plat and the accompanying Legal  
Description represents an actual Boundary  
Survey completed by me, John W. Jauert,  
P.S. No. 6920 in March 2024.

Leaving 55.132± Acre left out of the  
Original 67.339 Acre tract.



ATTEST:

John W. Jauert  
Professional Surveyor No. 6920



GRAPHIC SCALE

- LEGEND**
- 5/8"x30" Iron Pin Set/Cap
  - 5/8" Iron Pin Found
  - ⊗ Mag Nail Set
  - Mag Nail Found
  - Monument Box

**Jauert**  
surveying

11584 Monroe Road  
Wapakoneta, Ohio  
45895  
(419) 657-6999

CLIENT: Turkey Ribs, Inc.  
COUNTY: Auglaize TOWNSHIP: St. Marys SEC. 14  
DRAWN BY: J.W.J. SCALE: 1"=180' DWG.# 24-4720A  
CHECKED BY: DATE: March 2024  
SHEET 1 OF 2 (T-6-S; R-4-E)

V-195

- John Jauert
- 11584 Monroe Road
- Wapakoneta, Ohio 45895



- Phone: (419) 657-6999
- FAX: (419) 657-2745
- E-Mail: jjsurvey@ohiolink.net

## TURKEY RIBS, INC., etal SURVEY 12.207 ACRE (ADD ON) TRACT

The following described tract of land is part of the West ½ of the Southeast Quarter of Section 14, Town 6 South, Range 4 East, St. Marys Township, Auglaize County, Ohio, being part of Parcel No. K30-141-002-00 and is more particularly described as follows:

Commencing at a Monument Box (found) at the Southeast corner of the Southeast Quarter of Section 14, St. Marys Township and in the centerline of Township Road 110 (Poppe Road);

Thence N.88°55'39"W. along the South line of the Southeast Quarter of said Section 14 and along the centerline of Township Road 110, a distance of 1,353.99 feet to a Mag Nail (set) which is the PLACE OF BEGINNING for the tract of land herein described;

Thence continuing N.88°55'39"W. along the above described line, a distance of 589.06 feet to a Mag Nail (set);

Thence N.01°03'46"E. a distance of 901.69 feet to a 5/8-inch iron pin (set), passing thru a 5/8-inch iron pin (set) for reference at 20.00 feet in the North right-of-way line of Township Road 110 and passing thru an iron pin (found) at 743.97 feet;

Thence S.88°55'39"E., parallel to the centerline of Township Road 110 and the South line of the Southeast Quarter of said Section 14, a distance of 590.38 feet to a 5/8-inch iron pin (set);

Thence S.01°08'49"W. a distance of 901.69 feet to the Mag Nail (set), passing thru a 5/8-inch iron pin (set) in the North right-of-way line of Township Road 110, said Mag Nail was the true PLACE OF BEGINNING.

Containing in all 12.207 Acre of which 0.270 Acre is road right-of-way and is subject to all legal easements, restrictions and reservations, if any, of record or in use on said premises. Previous deed reference: Volume OR 625, Page 1627. This plat is recorded in Survey Book "V", Page 195, in the Auglaize County Engineer's Office. Basis for bearings for this tract is holding the centerline of Township Road 110 and the South line of the Southeast Quarter of Section 14, St. Marys Township as S.89°55'39"E. from the Ohio State Plane-North Coordinate System NAD83 (2011). This Plat and description was prepared from an actual field survey of the above premises by John W. Jauert, Professional Land Surveyor No. 6920 in March 2024.

ATTEST:

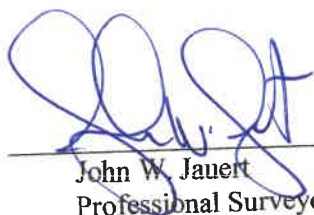
  
John W. Jauert  
Professional Surveyor No. 6920

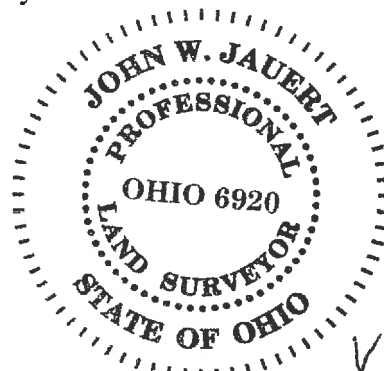

V-196