

Survey of part of Parcel #F19-035-010-00, located in the N 1/2 of the SE 1/4 of Section 35, T4S, R5E, Logan Township, Auglaize County, Ohio.

Prior Deed Referenced in O.R. 694, Page 1055.

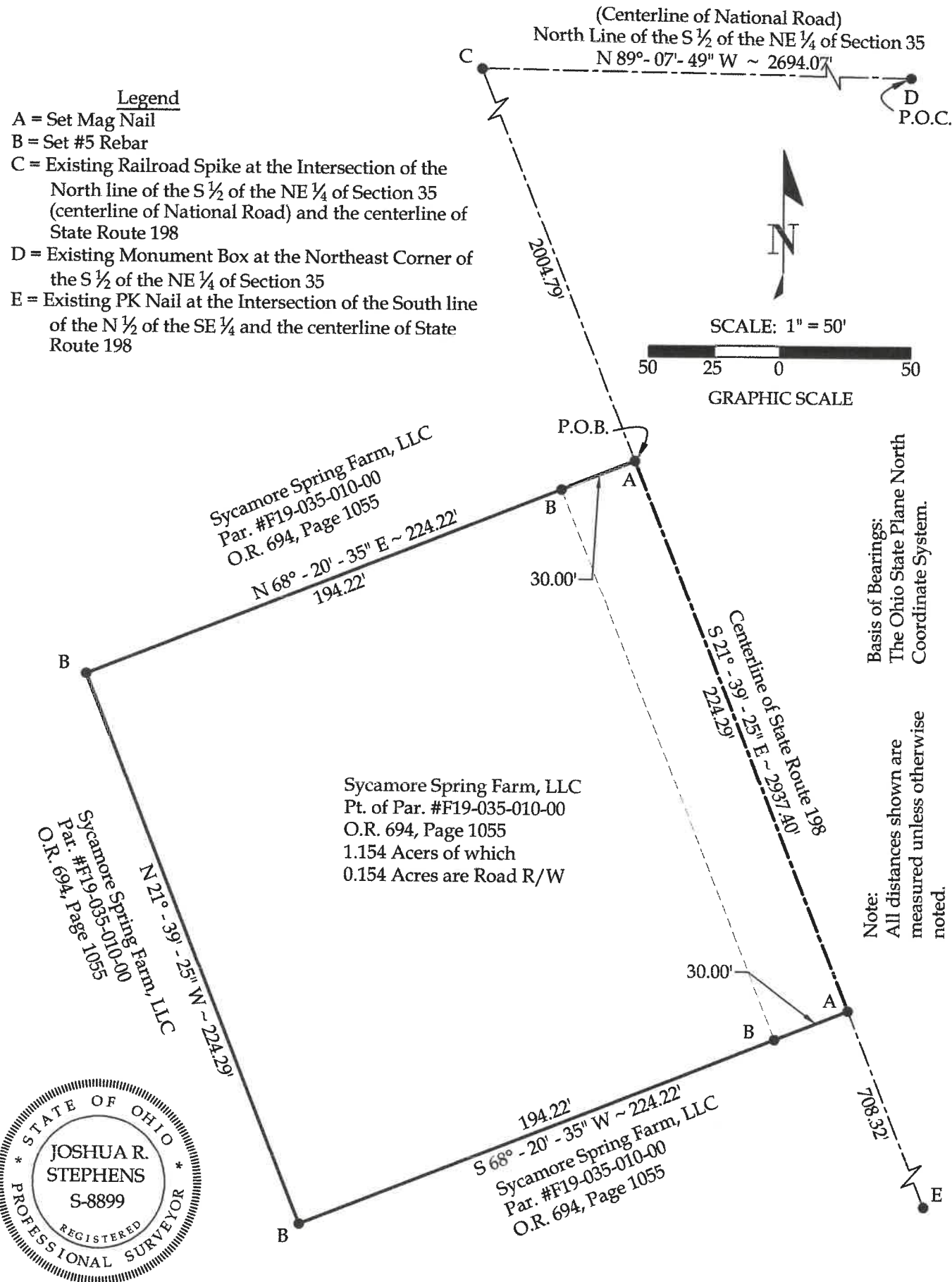

This plat and accompanying legal description represent an actual boundary survey completed under my direct supervision on February 15, 2024.

Joshua R. Stephens
Joshua R. Stephens, P.S. #8899

CORE CONSULTING
A Division of Materials Testing, Inc.

201 N. Broadway St.
Spencerville, OH 45887
Phone/Fax: 419-647-6163

| | | | |
|------------------------|--------------------|---------------------|-----------------------|
| CLIENT: Nathan Metz | | | |
| SURVEYED BY: P.J.M. | DATE: 2-15-2024 | DRAWN BY: P.J.M. | CHECKED BY: J.R.S. |
| SCALE: 1" = 50' | | PAGE 1 | OF PAGES 2 |

LEGAL DESCRIPTION

Part of parcel #F19-035-010-00 with prior deed referenced in O.R. 694, Pg. 1055, located in the N $\frac{1}{2}$ of the SE $\frac{1}{4}$ of Section 35, T4S, R5E, Logan Township, Auglaize County, Ohio, more particularly described as follows:

Commencing at an existing Monument Box at the Northeast Corner of the S $\frac{1}{2}$ of the NE $\frac{1}{4}$ of Section 35; thence N $89^{\circ}-07'-49''$ E on the North line of the S $\frac{1}{2}$ of the NE $\frac{1}{4}$ of Section 35 (centerline of National Road), 2694.07' to an existing Railroad Spike at the intersection of the North line of the S $\frac{1}{2}$ of the NE $\frac{1}{4}$ of Section 35 (centerline of National Road) and centerline of State Route 198; thence S $21^{\circ}-39'-25''$ E on the centerline State Route 198, 2004.79' to a Mag Nail set at the POINT OF BEGINNING; thence the following courses:

1. Continue S $21^{\circ}-39'-25''$ E on the centerline of State Route 198, 224.29' to a set Mag Nail;
2. S $68^{\circ}-20'-35''$ W, 224.22' to a set #5 Rebar, passing a set #5 Rebar at 30.00';
3. N $21^{\circ}-39'-25''$ W, 224.29' to a set #5 Rebar;
4. N $68^{\circ}-20'-35''$ E, 224.22' to the POINT OF BEGINNING, passing a set #5 Rebar at 194.22'.

The above-described parcel of land contains 1.154 acres, more or less, of which 0.154 acres are occupied by road right-of-way. This parcel is subject to all legal highways and easements of record.

The bearings for this survey are based on the Ohio State Plane North Coordinate System. This legal description and the accompanying plat represent an actual boundary survey conducted under the direct supervision of Joshua R. Stephens, P.S. #8899 on February 15, 2024. All markers called for above are in place.

