

PLAT OF SURVEY
FOR
T. FETTER

SITUATED IN:
THE SW. 1/4, SECTION 10
TOWN 5 S. RANGE 8 E.,
WAYNE TOWNSHIP,
AUGLAIZE COUNTY, OHIO

NORTH AND BEARING
SYSTEM BASED ON
OHIO NORTH STATE
PLANE GRID, NAD 83
ADJ. 2011.

F5 LAND COMPANY, LLC
O.R. 727, PG. 2410
60 AC.



F5 LAND COMPANY, LLC
O.R. 727, PG. 2410
80 AC.

LEGEND:

- Ø MAG NAIL FOUND
- MONUMENT BOX FOUND
- MAG NAIL SET
- 5/8" IRON PIN W/ CAP SET



HOWBERT SURVEYING LLC
8477 MERICLE ROAD
FORT JENNINGS, OHIO 45844
419-863-0289

DATE: 5/20/15	REV.:
CLIENT: T. FETTER	SCALE: 1" = 80'
JOB #: 189-05-25	CHK:

FILE: TFE125.DWG

THIS PLAT IS BASED ON AN ACTUAL FIELD SURVEY.

Michael L. Howbert
MICHAEL L. HOWBERT
REGISTERED PROFESSIONAL
SURVEYOR NO. 7959 IN OHIO
MAY 25, 2025

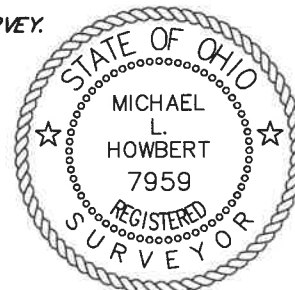

NOTES:
FOUND MONUMENTATION IN GOOD CONDITION
UNLESS OTHERWISE NOTED.
DATA SOURCES INCLUDE DOCUMENTS CITED.
A TITLE SEARCH IS RECOMMENDED TO DETERMINE
EASEMENTS, RESTRICTIONS, AND/OR OTHER
ENCUMBRANCES AFFECTING THE PROPERTY
SHOWN HEREON.

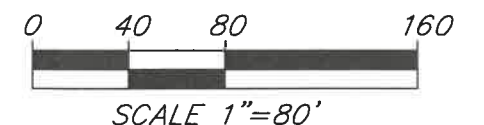



Description 3.581 Acres

Situated in the Southwest Quarter of Section 10, Town 5 South, Range 8 East, Wayne Township, Auglaize County, Ohio, being part of a 60 acres tract as described deed recorded in Official Record Volume 727, Page 2410 of said County Deed Records and being more particularly described as follows;

Commencing at the southwest corner of the southwest quarter of said Section 32, being a monument box found;

Thence along the south line of said southwest quarter, S.89°46'04"E., a distance of 802.81 feet to a mag nail set;

Thence on a new division line on the following three (3) courses and distances:

1. N.01°05'58"E., a distance of 300.00 feet to a 5/8" iron pin set, passing a 5/8" iron pin set at 25.00 feet;
2. S.89°46'04"E., a distance of 520.00 feet to a 5/8" iron pin set;
3. S.01°05'58"W., a distance of 300.00 feet to a mag nail found at the southeast corner of the west half of the southwest quarter;

Thence along the south line of said southwest quarter, N.89°46'04"W., a distance of 520.00 feet to the Point of Beginning;

Containing 3.581 acres, more or less, and being subject to all legal highways, rights-of-way, easements, restrictions, covenants, and/or conditions of record.

Part Parcel Numbers: N4101000400

The above description based on a survey prepared by Michael L. Howbert, Registered Professional Surveyor No. 7959, in May of 2025. The basis of bearing is based on Ohio North State Plane Grid, NAD 83, Adjustment 2011.



Michael L. Howbert, P.S.
6-2-25