

Deep Cut.

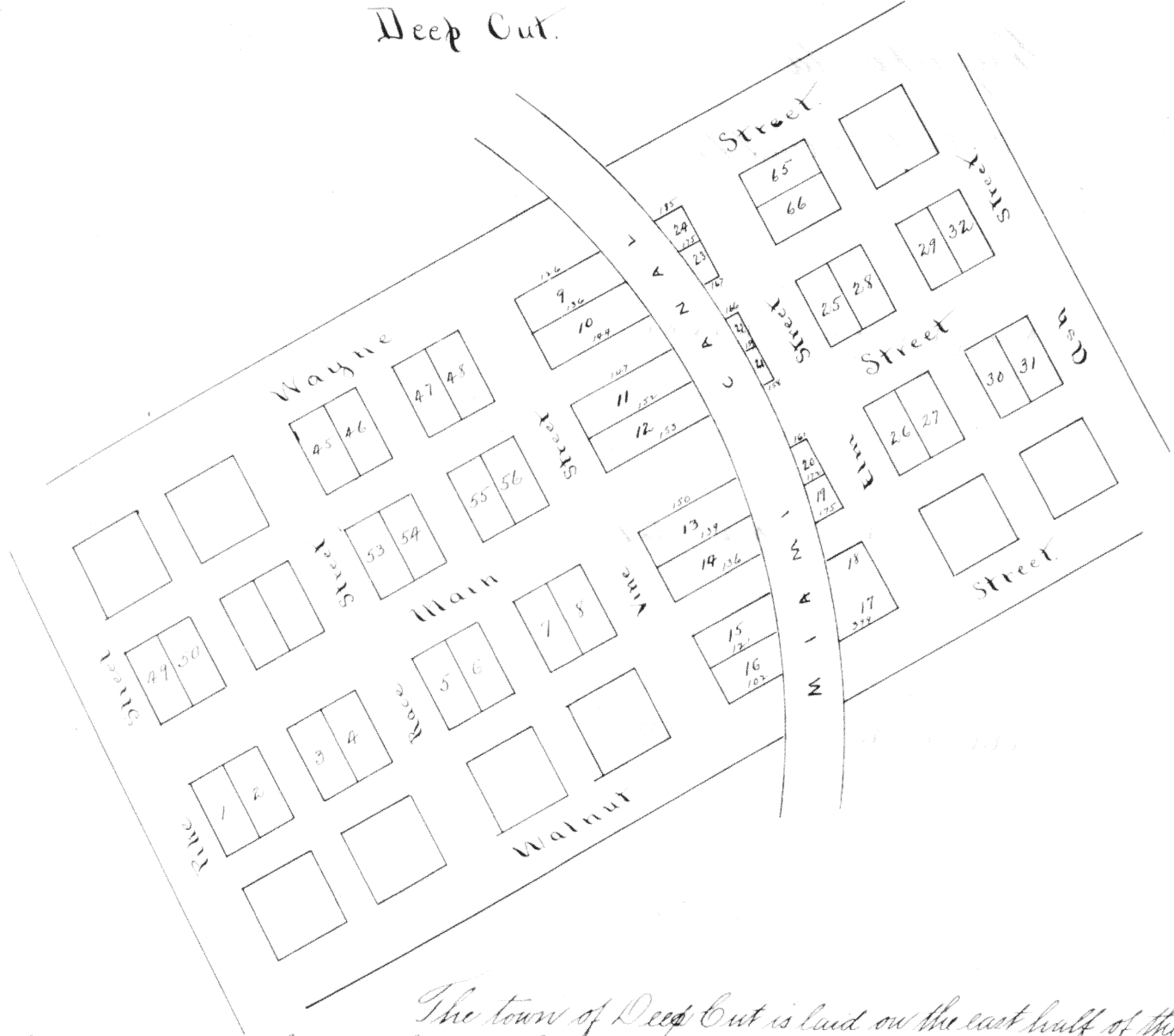

The town of Deep Cut is laid on the east half of the south west quarter, and the west half of the south east quarter of Section 25, Town 4 south, range 4 east of the first principal Meridian. It contains 32 In Lots all of which except those adjoining the canal are each 66 feet wide and 132 feet long. The lots on the Canal are the same width and the length of their sides in links is marked on the map now with small figures. Main Street is 66 feet wide and bears S. 60 W.: all other streets are each 54<sup>10</sup> feet wide and run parallel to or at right angles to Main Street, as designated on the map: the Alleys are all 16<sup>1</sup>/<sub>2</sub> feet wide. The lots and squares not numbered on the map are not intended to be made a part of the town plat. Corner stones at N.W. 4 and S.W. 16.

I certify the foregoing description and delineation to be correct this 13th day of October A.D. 1845.

Cyrenus Elliott  
Surveyor M. Co

The State of Ohio, Miami County, ss.

On the 2d day of March A.D. 1849 came Daniel Petit the within named proprietor of the Town of Deep Cut and acknowledged the survey and description of said town for record according to the provisions of the Statutes of Ohio, entitled an Act providing for the recording of town plats, before me.

M. S. Mitchell  
Associate Judge

Witnessed for record March 5<sup>th</sup> 1849  
and recorded the same day.

Simon Preshler  
Recorder of A. Co. O.