

DEDICATION

Nathan Hirschfeld, being the sole owner of the above described premises, does hereby dedicate the street and utility easements as shown on the accompanying plat of Hirschfeld's Subdivision to the public for their use forever.

Signed this 14th day of December 1973.

Witness

Elmer Poppe
Frank Gaudy

Hirschfeld's Subdivision

President

Secretary

ACKNOWLEDGEMENT

County of Auglaize, State of Ohio

Before me, a Notary Public in and for said County and State, did personally appear the above named Hirschfeld's Subdivision signed by Nathan Hirschfeld did sign the foregoing instrument and that the same is the free act and deed of said Subdivision, and the free act and deed of each of them personally and as such officers, in testimony thereof, I affix my hand and seal this 14th day of December 1973.

NEW BREMEN PLANNING COMMISSION APPROVAL

The planning Commission of the Village of New Bremen certifies that the accompanying plat of Hirschfeld's Subdivision was approved by the said Commission on the 3 day of December 1973.

Charles J. H. H. H.
Chairman-New Bremen Village Planning Commission

COUNTY AUDITOR'S CERTIFICATE

This plat was filed for transfer this 4 day of December 1973.

FEE: \$ 3.50

Vern Doenges
Vern Doenges, Auglaize County Auditor

Notary Public, State of Ohio
CERTIFICATE OF ACCEPTANCE

VIRGINIA E. DEWITT, Notary Public, Auglaize County, Ohio
My Commission Expires March 21, 1977

I hereby certify that the accompanying plat was approved and that the street and easements dedicated thereon were accepted by the Council of the Village of New Bremen, Auglaize County, Ohio by Ordinance. No. _____ on the _____ day of _____ 1973.

Village Administrator

Clerk of Council

COUNTY RECORDER'S CERTIFICATE

No. 134692

Filed for record in the Auglaize County Recorder's Office this 14 day of December 1973 at 9:10 A. M. and recorded in Auglaize County, Ohio Plat Book C on page 37.

LeRoy H. Kruse
LeRoy H. Kruse, Auglaize County Recorder

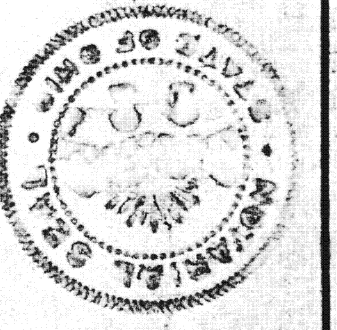

REVISIONS					
NO.	DATE	BY			
1					
2					
3			DRAWN BY	SCALE	MATERIAL
4			CNK'D	DATE	DRAWING NO.
5			TRACED	APP'D	

-NOTE-

Former O.L. 35 and O.L. 43 and part of Fraction 18 were part of Koop-Boesche & Koops south addition, and Ober Bremen.

-DESCRIPTION-

Starting in the southeast corner of Fraction 18 also at Station 184+58.28 of the center line of the State of Ohio Survey of State Route 66 (Washington Street) in the Village of New Bremen, Auglaize County, Ohio on a course $S-87^{\circ}51'35''-W$ a distance of 306.21' to a concrete monument and said point being the place of beginning; thence, $N-3^{\circ}40'35''-W$ a distance of 319.70' to a concrete monument; thence, $N-80^{\circ}44'25''-E$ a distance of 124.22' to a concrete monument; thence, $N-3^{\circ}40'35''-W$ a distance of 200.72' to a point; thence, $N-86^{\circ}19'25''-E$ a distance of 16' to a point; thence, $N-3^{\circ}40'35''-W$ a distance of 99' to a concrete monument; thence, $S-86^{\circ}19'25''-W$ crossing Canal Street a distance of 501.37' to a concrete monument; thence, $S-10^{\circ}30'15''-W$ a distance of 141.00' to a point; thence, $S-4^{\circ}06'15''-W$ a distance of 105.79' to a point; thence, $S-33^{\circ}31'15''-E$ a distance of 84.19' to a point; thence, $S-27^{\circ}08'30''-W$ a distance of 70.89' to a point; thence, $S-14^{\circ}42'15''-E$ a distance of 192.21' to a concrete monument; thence, $N-87^{\circ}51'35''-E$ a distance of 367.64' to the place of beginning.

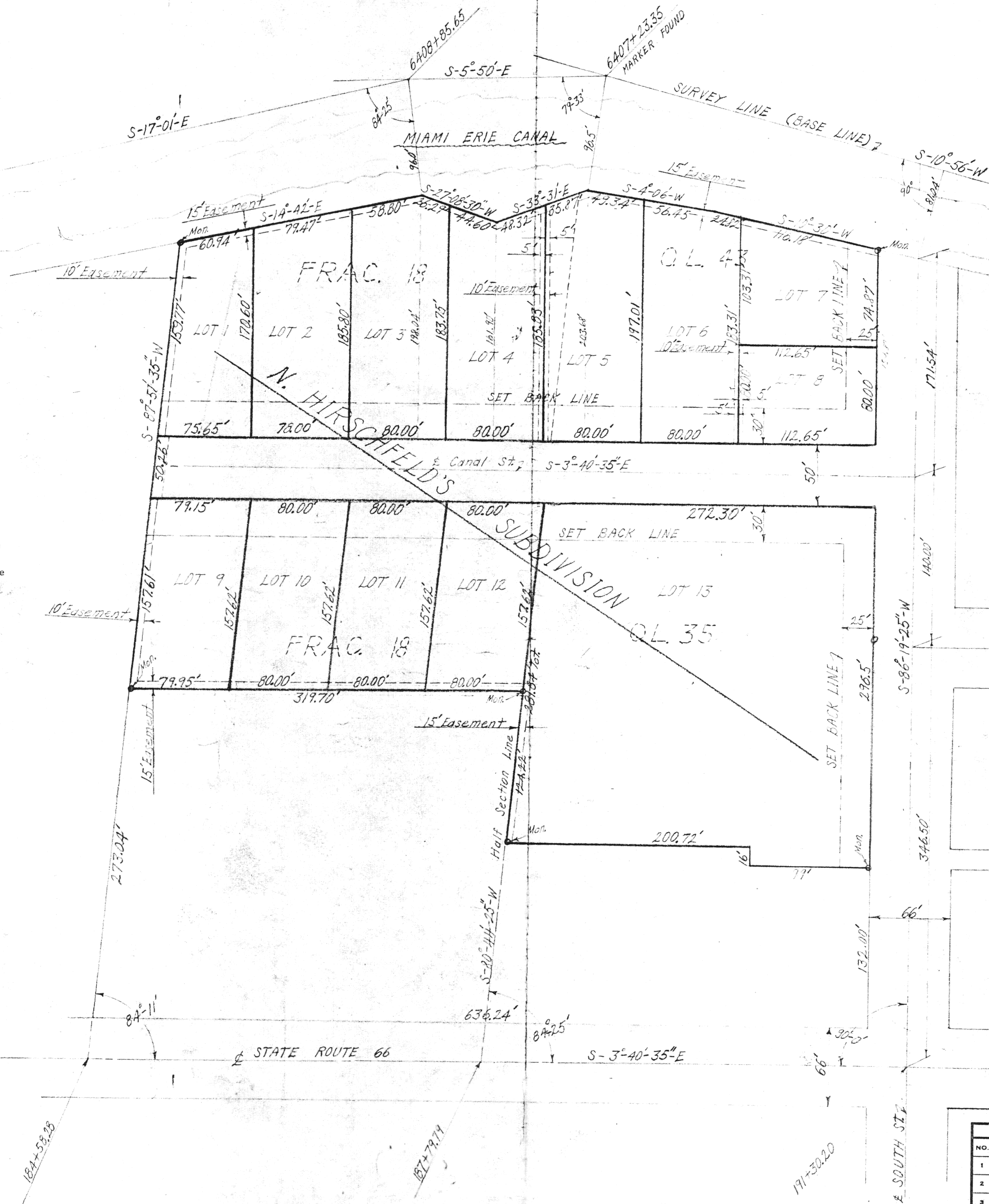

I HEREBY CERTIFY THAT THIS PLAT IS A TRUE DELINEATION OF A SURVEY.

JAMES C. BROOKER
REGISTERED SURVEYOR N° 5233

REVISIONS					
NO.	DATE	BY	DRAWN BY	SCALE	MATERIAL
1			W.L.R.	1" = 60'	
2			CHK'D	DATE	DRAWING NO.
3			TRACED	APP'D	